

THE POWER IS IN THE PUMP!

AMERICAN TURBINE

2026 RETAIL PRICE LIST



**WE HAVE REPLACEMENT PARTS FOR:
AMERICAN TURBINE, DOMINATOR
LEGEND, BERKELEY
JACUZZI & PANTHER ENERGIZER
HAMILTON**



**COMPETE SHAFT ASSEMBLIES
INCLUDING HAMILTON 212**

IMPELLERS: ALUMINUM & STAINLESS

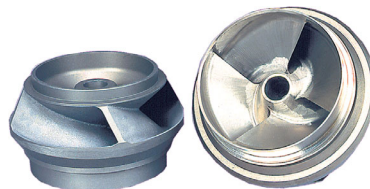

DROOP SNOOT



**JACUZZI YJ, WY & PANTHER
ENERGIZER KITS**

HYDRAULIC TURBINE TRIM

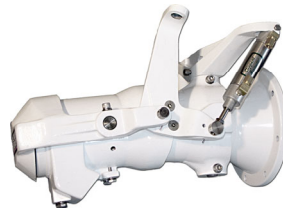

OVERHAUL KITS

AMERICAN TURBINE
3692 RIVERSIDE DR.
CLARKSTON, WA 99403
PHONE: (509) 243-5387
FAX: (509) 243-5391
INTERNET: WWW.AMERICANTURBINE.COM
ALL PRICES F.O.B. CLARKSTON, WA. AND SUBJECT TO CHANGE WITHOUT NOTICE
PRICES EFFECTIVE APRIL 01, 2026

RETAIL JETDRIVE PACKAGE PRICE SHEET

PUMP PACKAGE (INCLUDES INTAKE, INSTALL KIT, AND STANDARD STEERING)

DEALERS NOTE: Standard discounts do not apply.

MODEL	DESCRIPTION	LIST
AT-309	AT Jetdrive Package w / Standard Steering	\$7,636.50
12-S	Dominator Jetdrive Package w / Standard Steering	\$7,670.50
SD-309	Super Duty Jetdrive Package w / Standard Steering	\$8,070.50
SD-312	Super Duty Jetdrive Package w / SS Imp & Standard Steering	\$9,279.50
TJ-309 / 12TD	Transom Jetdrive Package w / Standard Steering	\$6,736.50
SD-312FG	Fiberglass Jetdrive Package w / SS Imp & Jet Trim Kit	\$11,122.00
J120-AT	Legend Jet Drive Package w / Standard Steering	\$7,378.00
AXIAL FLOW JETDRIVES COME STANDARD WITH SDR STEERING & STAINLESS STEEL IMPELLER		
SD203	Axial Flow SD Jetdrive Package (203 mm Blade)	\$9,229.50
SD231	Axial Flow SD Jetdrive Package (231 mm Blade) Hyd. Reverse	\$22,255.00
TRANSOM KITS (MAX DISCOUNT IS 25%)		
TK0310	Legend Set-Back Plate	\$922.00
TK1105	Transom Housing Kit (berkeley style 9/18 deg.)	\$920.00
TK5001	SD Installation Kit	\$310.50
ADD ON OPTIONS (ADD TO DRIVE LIST PRICE) - MAX DISCOUNT ON OPTIONS IS 25%		
IK1602	Hydraulic Rideplate kit for SD-231	\$2,219.00
HP INTAKE	HP INTAKE UPGRADE	\$560.00
IM1000	INDUCER IMPELLER (NO DISCOUNT)	\$768.50
HIPPED SUCTION	HIPPED PROCESS FOR SUCTION	\$2,060.50
HIPPED BOWL	HIPPED PROCESS FOR BOWL	\$623.50
EXTRUDE	EXTRUDED CHARGE FOR BOWL	\$886.00
IMA**H	Hi-Helix Stainless Steel Impeller	\$1,655.50
IMA**S	Stainless Steel Impeller	\$1,357.00
R6301	Hi-Flow Droop Snoot	\$292.00
R6007	Droop Snoot	\$292.00
R6201	Long Straight Snoot	\$424.50
BNA1407	Best Steering Upgrade	\$409.50
SRK2101	SDR Steering Upgrade	\$1,410.00
RSK2101	HTR II Steering Upgrade	\$1,714.50
RA8507	Turbine Trim w/o Hydraulic Kit	\$1,198.50
RA8707	Turbine Trim w / Hydraulic Kit	\$2,252.50
JTA8507	Jet Trim w/o Hydraulic Kit	\$1,318.00
JTA8607	Jet Trim w / Hydraulic Kit	\$2,393.00
CREDITS (NET)		
INTAKE	SD-309, 12-S, AT-309, J120 INTAKE CREDIT	\$300.00
SD-312 INTAKE	SD-312 INTAKE CREDIT	\$350.00
TK5001	INSTALL KIT CREDIT	\$30.00
NOZZLE	STANDARD NOZZLE CREDIT	\$45.00
STEERING	STANDARD STEERING CREDIT	\$65.00

AMERICAN TURBINE Item Price List

Item	Description	Price
(B) BEARINGS & BUSHINGS		
B1001	THRUST BEARING (SD-231, HAM213, HAM241)	514.50
B1007	THRUST BEARING (BERK, AT & DOM) (Install w/ loading slot towards eng.)	188.00
B1101	THRUST BEARING (SD & FW)	306.00
B1103	THRUST BEARING (12TD,12YJ)	272.00
B1107	THRUST BEARING, HI-PERF.	306.00
B1502	BOWL BEARING, GREASE LUBE 3/4	39.00
B1505	BOWL BEARING, WATER LUBE 1" (EARLY AT,DOM)	39.00
B1506	STATOR BEARING, SD231	62.50
B1603	BOWL BEARING, WATER LUBE SLEEVE	119.00
B1903	BOWL BEARING, GREASE LUBE SLEEVE	188.00
B2007	NYLINER BUSHING, SPLIT (3/4) (WJ STR, HVR)	11.50
B2101	NYLINER BUSHING, SPLIT (1/2 LONG)	13.00
B2102	NYLINER BUSHING, SPLIT (BERK REV. & JET TRIM)	18.50
B2105	NYLINER BUSHING, SPLIT (3/8)	11.50
B2201	BRASS BEARING (3/4)	29.00
B2301	NYLON BEARING (5/8)	29.00
B2401	NYLON BEARING (3/4)	41.00
B2501	NYLINER BUSHING, 1/2 X 1/2 (SDR BUCKET)	13.00
B4000	PLAIN BEARING (3/4)	27.50
B4134	STATOR BEARING CARTRIDGE, SD231	706.00
B4135	STATOR BEARING CARTRIDGE, SD231, CUTLASS	706.00
BA1201	THRUST BEARING ASSEMBLY, SD309, SD312	406.00
BA1703	BOWL BEARING ASSEMBLY, WATER LUBE	188.00
BA1803	BOWL BEARING ASSEMBLY, GREASE LUBE	343.00
BA4134	BEARING CARTRIDGE ASSEMBLY, SD231	774.00
BA4135	STATOR BEARING CARTRIDGE ASSEMBLY, SD231, CUTLASS	1,279.50
BK1001	3-STAGE, MP901 BEARING KIT	446.50
BK1201	THRUST BEARING KIT, SD	638.50
BK1201HD	HD THURST BEARING KIT, SD, W / SS SLEEVE & HD NUT	865.50
BK1201ind	THRUST BEARING KIT, INDMAR	638.50
BK1412	SD-231 THRUST BEARING KIT	586.50
(BN) BEST NOZZLE COMPONENTS		
BN1710	BEST, NOZZLE DEFLECTOR	179.50
BN1810	BEST, BUCKET LEVER	80.00
BN2010	BEST, NOZZLE, PLASTIC BUSHING	18.00
BN2110	BEST, NOZZLE, RIGHT SIDE BOLTS	42.00
BN2210	PIVOT BOLT, (BEST PORT SIDE)	42.00
BN2410	BEST, BERK, DOM, UPPER STEERING PIN	80.00
BN2510	BEST, BERK, DOM, LOWER STEERING PIN	63.00
BNA1307A	STEERING ASSEMBLY, BEST, LESS R1007, 3.00 INSERT (MAXIMUM DISCOUNT 25%)	1,583.50

AMERICAN TURBINE Item Price List

Item	Description	Price
BNA1307C	STEERING ASSEMBLY, BEST, LESS R1007, 3.19 INSERT (MAXIMUM DISCOUNT 25%)	1,583.50
BNA1307D	STEERING ASSEMBLY, BEST, LESS R1007, 3.25 INSERT (MAXIMUM DISCOUNT 25%)	1,583.50
BNA1307G	STEERING ASSEMBLY, BEST, LESS R1007, 3.50 INSERT (MAXIMUM DISCOUNT 25%)	1,583.50
BNA1307H	STEERING ASSEMBLY, BEST, LESS R1007, 3.60 INSERT (MAXIMUM DISCOUNT 25%)	1,583.50
BNA1307I	STEERING ASSEMBLY, BEST, LESS R1007, 3.70 INSERT (MAXIMUM DISCOUNT 25%)	1,583.50
BNA1307J	STEERING ASSEMBLY, BEST, LESS R1007, 3.80 INSERT (MAXIMUM DISCOUNT 25%)	1,583.50
BNA1407C	STEERING ASSEMBLY, BEST, 3.19 INSERT (MAXIMUM DISCOUNT 25%)	1,823.50
BNA1407D	STEERING ASSEMBLY, BEST, 3.25 INSERT (MAXIMUM DISCOUNT 25%)	1,823.50
BNA1407I	STEERING ASSEMBLY, BEST, 3.70 INSERT (MAXIMUM DISCOUNT 25%)	1,823.50
BNA1511	BEST, NOZZLE W / DEFLECTOR, LARGE INSERT BORE	873.00
BNA1610	BEST, REVERSE BUCKET W / LEVER	571.00
BNA1911	BEST, 1/4 STAINLESS ROD END ASSEMBLY	92.00

(C) CABLES & SHIFTERS (CALL FOR DEALER PRICING)

A7100/07	33C CABLE X 7 FEET	119.00
A7100/09	33C CABLE X 9 FEET	119.00
A7100/10	33C CABLE X 10 FEET	119.00
A7100/11	33C CABLE X 11 FEET	119.00
A7100/12	33C CABLE X 12 FEET	119.00
A7100/13	33C CABLE X 13 FEET	119.00
A7100/14	33C CABLE X 14 FEET	119.00
A7100/15	33C CABLE X 15 FEET	119.00
A7100/16	33C CABLE X 16 FEET	119.00
A7100/17	33C CABLE X 17 FEET	119.00
A7100/18	33C CABLE X 18 FEET	119.00
A7100/20	33C CABLE X 20 FEET	119.00
A7100/21	33C CABLE X 21 FEET	119.00
A7100/22	33C CABLE X 22 FEET	119.00
A7100/23	33C CABLE X 23 FEET	119.00
A7100/24	33C CABLE X 24 FEET	119.00
A7100/28	33C CABLE X 28 FEET	119.00
A7200/16	43C CABLE X 16 FEET	233.50
A7200/19	43C CABLE X 19 FEET	233.50
A7200/20	43C CABLE X 20 FEET	233.50
A7200/21	43C CABLE X 21 FEET	233.50
A7200/22	43C CABLE X 22 FEET	233.50
A7200/23	43C CABLE X 23 FEET	233.50
A7200/24	43C CABLE X 24 FEET	233.50
A7200/25	43C CABLE X 25 FEET	233.50
A7200/26	43C CABLE X 26 FEET	233.50
A7200/27	43C CABLE X 27 FEET	233.50
A7200/28	43C CABLE X 28 FEET	233.50
A7200/29	43C CABLE X 29 FEET	233.50

AMERICAN TURBINE Item Price List

Item	Description	Price
A7210/08	43BC CABLE X 8 FEET	233.50
A7210/09	43BC CABLE X 9 FEET	233.50
A7210/10	43BC CABLE X 10 FEET	233.50
A7210/11	43BC CABLE X 11 FEET	233.50
A7210/12	43BC CABLE X 12 FEET	233.50
A7210/13	43BC CABLE X 13 FEET	233.50
A7210/14	43BC CABLE X 14 FEET	233.50
A7210/15	43BC CABLE X 15 FEET	233.50
A7210/16	43BC CABLE X 16 FEET	233.50
A7210/17	43BC CABLE X 17 FEET	233.50
A7210/18	43BC CABLE X 18 FEET	233.50
A7210/19	43BC CABLE X 19 FEET	233.50
A7210/20	43BC CABLE X 20 FEET	233.50
A7210/21	43BC CABLE X 21 FEET	233.50
A7210/22	43BC CABLE X 22 FEET	233.50
A7210/23	43BC CABLE X 23 FEET	233.50
A7210/24	43BC CABLE X 24 FEET	233.50
A7210/25	43BC CABLE X 25 FEET	233.50
A7210/26	43BC CABLE X 26 FEET	233.50
A7210/27	43BC CABLE X 27 FEET	233.50
A7210/28	43BC CABLE X 28 FEET	233.50
A7210/30	43BC CABLE X 30 FEET	233.50
A7300/16	64C CABLE X 16 FEET	414.00
A7300/17	64C CABLE X 17 FEET	414.00
A7300/18	64C CABLE X 18 FEET	414.00
A7300/19	64C CABLE X 19 FEET	414.00
A7300/20	64C CABLE X 20 FEET	414.00
A7300/21	64C CABLE X 21 FEET	414.00
A7300/22	64C CABLE X 22 FEET	414.00
A7300/23	64C CABLE X 23 FEET	414.00
A7300/24	64C CABLE X 24 FEET	414.00
A7300/25	64C CABLE X 25 FEET	414.00
A7300/30	64C CABLE X 30 FEET	414.00
CMC-30	33C CABLE CLAMP	10.50
CMC-40	40 SERIES CABLE CLAMP	10.50
CMC-60	64C CABLE CLAMP	12.00
DM-231	FLOW-TEC DASH MOUNT SD231, HAM241 CONTROLS (NO DISCOUNT)	787.50
DM-SDR	FLOW-TEC DASH MOUNT SDR CONTROLS (NO DISCOUNT)	787.50
RSM-SDR	FLOW-TEC RIGHT SIDE MOUNT SDR CONTROLS (NO DISCOUNT)	787.50
CS1001	SWITCH PLUNGER, SD231	42.00
CS1003	SWITCH BLOCK, SD231	36.00
CS1005	SWITCH CABLE SWIVEL, 43 SERIES, SD231	22.00
CS1007	SWITCH CABLE SWIVEL, 33 SERIES, SD231	24.00

AMERICAN TURBINE Item Price List

Item	Description	Price
CS1009	SWITCH PLUNGER STOP, SD231	10.00
CS1011	SWITCH EXTERNAL RETAINING RING, SD231	5.50
CS1013	SWITCH SPRING, SD231	60.00
CS1015	TOGGLE SWITCH, SD231	76.50
CS1017	SWITCH SLOTTED SPRING PIN, SD231	4.50
(D) DRIVELINE PARTS		
0844-11	STANDARD DRIVELINE, 1310 SERIES (FITS KODIAK & MARINE POWER) (NO DISC)	327.00
2-4-1731-1	END YOKE (NO DISCOUNT)	168.00
2-70-18X	BEARING STRAP KIT (NO DISCOUNT)	17.50
2-94-28X	U BOLT KIT (NO DISCOUNT)	29.00
5-1310X	U JOINT KIT (NO DISCOUNT)	71.50
5-1350X	U-JOINT KIT (NO DISCOUNT)	80.00
SC41-1	1410 SERIES SC SHAFT ASSEMBLY (NO DISCOUNT)	655.00
(F) FASTENERS		
F01 06 CP	5/64 X 3/4 COTTER PIN	3.00
F02 04 CP	7/64 X 3/4 COTTER PIN	3.00
F02 06 CP	1/8 X 3/4 COTTER PIN	4.50
F02 10 CP	1/8 X 1-1/4 COTTER PIN	4.50
F02 64 03 SH	#2-64 X 3/8 SOCKET HEAD CAP SCREW	3.00
F03 16 CP	5/32 X 2 COTTER PIN	3.00
F03 32 03 SH	10-32 X 3/8 SOCKET HEAD CAP SCREW	3.00
F03 32 03 SS	10-32 X 3/8 SET SCREW	4.50
F03 32 06 SH	10-32 X 3/4 SOCKET HEAD CAP SCREW	2.50
F03 32 10 SH	10-32 X 1-1/4 SOCKET HEAD CAP SCREW	2.50
F03 LW	#10 LOCK WASHER, STAINLESS	2.00
F04 08 WS	#14 X 1 WOOD SCREW	3.00
F04 20 03 PH	1/4-20 X 3/8 PAN HEAD PHILLIPS SCREW	3.00
F04 20 06 HH	1/4-20 X 3/4 HEX HEAD CAP SCREW	3.00
F04 20 06 SH	1/4-20 X 3/4 SOCKET HEAD CAP SCREW	4.50
F04 20 07 HH	1/4-20 X 7/8 HEX HEAD CAP SCREW	3.00
F04 20 07 SH	1/4-20 X 7/8 SOCKET HEAD CAP SCREW	4.50
F04 20 08 FH	1/4-20 X 1 FLAT HEAD MACHINE SCREW	3.00
F04 20 08 HH	1/4-20 X 1 HEX HEAD CAP SCREW	4.50
F04 20 10 SH	1/4-20 X 1-1/4 SOCKET HEAD CAP SCREW	4.50
F04 20 11 SH	1/4-20 X 1-3/8 SOCKET HEAD CAP SCREW	5.50
F04 20 12 FH	1/4-20 X 1-1/2 FLAT HEAD MACHINE SCREW	4.50
F04 20 16 FH	1/4-20 X 2 FLAT HEAD MACHINE SCREW	4.50
F04 20 20 FH	1/4-20 X 2-1/2 FLAT HEAD MACHINE SCREW	5.50
F04 20 HN	1/4-20 HEX NUT	3.00
F04 20 LN	1/4-20 LOCK NUT	4.50
F04 28 FRE	1/4-28 STAINLESS FEMALE ROD END (BEST, JET TRIM)	51.00

AMERICAN TURBINE Item Price List

Item	Description	Price
F04 AN	1/4 AN FLAT WASHER	2.50
F04 BI	1/4 BOLT INSULATOR	3.00
F04 CL	1/4 CLEVIS PIN	5.50
F04 FW	1/4 FLAT WASHER	3.00
F04 LW	1/4 LOCK WASHER	3.00
F04 NW	1/4 NEOBOND WASHER	4.50
F05 03 BI	BOLT INSULATOR, 5/16, SD231	3.00
F05 04 SB	5/16 X 1/2 SHOULDER BOLT	4.00
F05 18 02 SS	5/16-18 X 1/4 SET SCREW	5.50
F05 18 04 SH	5/16-18 X 1/2 SOCKET HEAD CAP SCREW	5.50
F05 18 06 BH	5/16-18 X 3/4 BUTTON SOCKET HEAD	4.50
F05 18 06 FH	5/16-18 X 3/4 FLAT HEAD SOCKET SCREW	5.50
F05 18 06 HH	5/16-18 X 3/4 HEX HEAD CAP SCREW	4.50
F05 18 06 SH	5/16-18 X 3/4 SOCKET HEAD CAP SCREW	5.50
F05 18 06 SQ	5/16-18 X 3/4 SQUARE HEAD SET SCREW	8.50
F05 18 06 SS	5/16-18 X 3/4 SET SCREW	5.50
F05 18 08 BH	5/16-18 X 1 BUTTON SOCKET HEAD	5.50
F05 18 08 FH	5/16-18 X 1 FLAT HEAD SOCKET SCREW	5.50
F05 18 08 HH	5/16-18 X 1 HEX HEAD CAP SCREW	4.50
F05 18 08 SH	5/16-18 X 1 SOCKET HEAD CAP SCREW	5.50
F05 18 10 FH	5/16-18 X 1-1/4 FLAT HEAD SOCKET SCREW	5.50
F05 18 10 HH	5/16-18 X 1-1/4 HEX HEAD CAP SCREW	4.50
F05 18 10 SH	5/16-18 X 1-1/4 SOCKET HEAD CAP SCREW	5.50
F05 18 12 FH	5/16-18 X 1-1/2 FLAT HEAD MACHINE SCREW	5.50
F05 18 12 HH	5/16-18 X 1-1/2 HEX HEAD CAP SCREW	5.50
F05 18 12 SS	5/16-18 X 1-1/2 SET SCREW	8.50
F05 18 14 HH	5/16-18 X 1-3/4 HEX HEAD CAP SCREW	4.50
F05 18 14 SS	5/16-18 X 1-3/4 SET SCREW	8.50
F05 18 16 CB	5/16-18 X 2 CARRIAGE BOLT	5.50
F05 18 16 FH	5/16-18 X 2 FLAT HEAD MACHINE SCREW	5.50
F05 18 16 HH	5/16-18 X 2 HEX HEAD CAP SCREW	4.50
F05 18 16 SH	5/16-18 X 2 SOCKET HEAD CAP SCREW	4.00
F05 18 16 SS G8	5/16-18 X 2 SOCKET HEAD SET SCREW, GRADE 8	4.50
F05 18 18 HH	5/16-18 X 2-1/4 HEX HEAD CAP SCREW	4.50
F05 18 18 SH	5/16-18 X 2-1/4 SOCKET HEAD CAP SCREW	5.50
F05 18 20 HH	5/16-18 X 2-1/2 HEX HEAD CAP SCREW	4.50
F05 18 22 HH	5/16-18 X 2-3/4 HEX HEAD CAP SCREW	4.50
F05 18 22 SH	5/16-18 X 2-3/4 SOCKET HEAD CAP SCREW	4.50
F05 18 24 FH	5/16-18 X 3 FLAT HEAD MACHINE SCREW	4.50
F05 18 32 HH	5/16-18 X 4 HEX HEAD CAP SCREW	4.50
F05 18 36 HH	5/16-18 X 4-1/2 HEX HEAD CAP SCREW	5.50
F05 18 HN	5/16-18 HEX NUT	3.00
F05 18 HN G8	5/16-18 HEX NUT, GRADE 8	3.50

AMERICAN TURBINE Item Price List

Item	Description	Price
F05 18 LN	5/16-18 LOCK NUT	4.50
F05 18 WN	5/16-18 WING NUT	5.00
F05 24 JN	5/16-24 JAMB NUT	3.00
F05 24 MRE	5/16-24 MALE ROD END	51.50
F05 AN	5/16 AN FLAT WASHER	3.00
F05 BI	5/16 BOLT INSULATOR	3.00
F05 CL	5/16 CLEVIS PIN	8.00
F05 FW	5/16 FLAT WASHER	3.00
F05 LW	5/16 LOCK WASHER	3.00
F05 LW G8	5/16 LOCK WASHER, GRADE 8	3.00
F05 NW	5/16 NEOBOND WASHER	3.00
F05 RW	5/16 RUBBER WASHER	3.00
F05 SW	5/16 STAR LOCK WASHER	3.00
F05 TW	5/16 THICK WASHER (HTR II)	4.50
F06 03 SB	3/8 X 3/8 SHOULDER BOLT	4.50
F06 08 CL	3/8 X 1-1/16 CLEVIS PIN, STAINLESS STEEL	10.00
F06 13 CL	3/8 X 2-1/4 CLEVIS PIN	10.50
F06 16 03 SH	3/8-16 X 3/8 SOCKET HEAD CAP SCREW	4.50
F06 16 06 HH	3/8-16 X 3/4 HEX HEAD CAP SCREW	4.50
F06 16 08 FH	3/8-16 X 1 FLAT HEAD SOCKET SCREW	5.50
F06 16 08 HH	3/8-16 X 1 HEX HEAD CAP SCREW	4.00
F06 16 10 HH	3/8-16 X 1-1/4 HEX HEAD CAP SCREW	5.50
F06 16 12 FH	3/8-16 X 1-1/2 FLAT HEAD CAP SCREW	4.50
F06 16 12 HH	3/8-16 X 1-1/2 HEX HEAD CAP SCREW	5.50
F06 16 12 SH	3/8-16 X 1-1/2 SOCKET HEAD CAP SCREW	4.50
F06 16 14 SS	3/8-16 X 1-3/4 SOCKET HEAD SET SCREW	4.50
F06 16 16 HH	3/8-16 X 2 HEX HEAD CAP SCREW	5.50
F06 16 16 SH	3/8-16 X 2 SOCKET HEAD CAP SCREW	4.50
F06 16 16 SS	3/8-16 X 2 SET SCREW	7.50
F06 16 20 SH	3/8-16 X 2-1/2 SOCKET HEAD CAP SCREW	4.50
F06 16 20 SS	3/8-16 X 2-1/2 SET SCREW	8.50
F06 16 22 HH	3/8-16 X 2-3/4 HEX HEAD CAP SCREW	4.50
F06 16 24 SH	3/8-16 X 3 SOCKET HEAD CAP SCREW	3.50
F06 16 28 HH	3/8-16 X 3-1/2 HEX HEAD CAP SCREW	5.50
F06 16 EB	3/8 EYE BOLT	35.00
F06 16 HN	3/8-16 HEX NUT	3.00
F06 16 JN	3/8-16 JAMB NUT	3.00
F06 16 LN	3/8-16 LOCK NUT	4.50
F06 16 WN	3/8 WING NUT	8.50
F06 24 08 HH	3/8-24 X 1 HEX HEAD CAP SCREW	5.50
F06 24 10 HH	3/8-24 X 1-1/4 HEX HEAD CAP SCREW	5.50
F06 24 10 SH	3/8-24 X 1-1/4 SOCKET HEAD CAP SCREW	5.50
F06 24 12 HH	3/8-24 X 1-1/2 HEX HEAD CAP SCREW	5.50

AMERICAN TURBINE Item Price List

Item	Description	Price
F06 24 14 HH	3/8-24 X 1-3/4 HEX HEAD CAP SCREW	5.50
F06 24 16 HH	3/8-24 X 2 HEX HEAD CAP SCREW	5.50
F06 24 16 SH	3/8-24 X 2 SOCKET HEAD CAP SCREW	5.50
F06 24 18 HH	3/8-24 X 2-1/4 HEX HEAD CAP SCREW	7.50
F06 24 18 SH	3/8-24 X 2-1/4 SOCKET HEAD CAP SCREW	5.50
F06 24 FRE	3/8-24 FEMALE ROD END, STAINLESS STEEL	46.50
F06 24 HN	3/8-24 HEX NUT	4.50
F06 24 JN	3/8-24 JAMB NUT	3.00
F06 24 LN	3/8-24 LOCK NUT	4.50
F06 24 MRE	3/8-24 MALE ROD END	74.50
F06 24 TL	3/8-24 THIN LOCK NUT	3.00
F06 AN	3/8 AN FLAT WASHER	3.00
F06 BI	3/8 BOLT INSULATOR	7.00
F06 FW	3/8 FLAT WASHER	4.50
F06 LW	3/8 LOCK WASHER	3.00
F06 SW	3/8 STAR LOCK WASHER	4.50
F06 TW	3/8 THICK WASHER (SD HAND HOLE COVER)	4.50
F07 TW	YOKE RETAINING WASHER, DOMINATOR MR	40.50
F08 10 RC	"R" CLIP, SHIFT SHAFT, SD231	3.50
F08 13 10 HH	1/2-13 X 1-1/4 HEX HEAD CAP SCREW	3.50
F08 13 12 HH	1/2-13 X 1-1/2 HEX HEAD CAP SCREW	5.50
F08 13 14 HH	1/2-13 X 1-3/4 HEX HEAD CAP SCREW	4.50
F08 13 16 HH	1/2-13 X 2 HEX HEAD CAP SCREW	4.50
F08 13 16 SS	1/2-13 X 2 SOCKET HEAD SET SCREW	7.50
F08 13 18 SS	1/2-13 X 2-1/4 SOCKET HEAD SET SCREW	4.50
F08 13 HN	1/2-13 HEX NUT	3.50
F08 13 LN	1/2-13 LOCK NUT	3.00
F08 20 14 SH	1/2-20 X 1-3/4 SOCKET HEAD CAP SCREW	7.00
F08 20 FRE	1/2-20 FEMALE ROD END	51.50
F08 20 HN	1/2-20 HEX NUT	2.50
F08 20 JN	1/2-20 JAMB NUT	5.00
F08 AN	1/2 AN FLAT WASHER	3.00
F08 LW	1/2 LOCK WASHER	3.00
F10 11 14 HH	5/8-11 X 1-3/4 HEX HEAD CAP SCREW	10.50
F10 11 16 HH	5/8-11 X 2 HEX HEAD CAP SCREW	10.50
F10 18 06 SS	5/8-18 X 3/4 SLOTTED SET SCREW	5.50
F10 18 14 HH	5/8-18 X 1-3/4 HEX HEAD CAP SCREW	7.00
F10 18 20 HH	5/8-18 X 2-1/2 HEX HEAD CAP SCREW	14.00
F10 18 24 SS	5/8-18 X 3 SOCKET HEAD SET SCREW	16.50
F10 18 FLN	5/8-18 FLANGED NUT, SERRATED	3.00
F10 18 JN	5/8-18 JAMB NUT	4.50
F10 LW	5/8 LOCK WASHER	4.50
F10 SW	5/8 STAR LOCK WASHER	4.50

AMERICAN TURBINE Item Price List

Item	Description	Price
F10 TW	5/8 THICK WASHER	4.50
F11 TW	THICK WASHER, T2007 CABLE PACKER	8.50
F12 16 JN	3/4-16 JAMB NUT	4.50
F14 14 JN	7/8-14 JAMB NUT	5.50
FK0231	SD-231 FASTENERS	285.00
FK1001	FASTENER KIT, AT DEEP TRANSOM	32.50
FK1003	FASTENER KIT, INTAKE, I-1003	61.00
FK1003HP	FASTENER KIT, INTAKE, I-1003HP	70.00
FK1007	FASTENER KIT, INTAKE, I-1007 & I-1507	61.00
FK1007HP	FASTENER KIT, INTAKE, I-1007HP	70.00
FK1101	FASTENER KIT, ALUMAWELD DEEP TRANSOM	32.50
FK1105	FASTENER KIT, 9/18 TRANSOM	27.50
FK12TD	FASTENER KIT, DOM 12TD JET UNIT	32.50
FK2208	FASTENER KIT, YJ JACUZZI ENERGIZER	60.00
FK3201	FASTENER KIT, SDR STEERING	16.50
FK3301	FASTENER KIT, TRANSOM, SD-309 & SD-312	27.50
FK3401	FASTENER KIT, I-1307 & I-1401 INTAKE	15.50
FK3407	FASTENER KIT, 2 DEGREE WEDGE	22.50
FK3408	FASTENER KIT, 2 DEGREE WEDGE W / SDR STEERING	22.50
FK3501	FASTENER KIT, INTAKE, I-1407	49.50
FK3507	FASTENER KIT, 3 DEGREE WEDGE	25.00
FK3508	FASTENER KIT, 3 DEGREE WEDGE W / SDR STEERING	25.00
FK3601	FASTENER KIT, TRANSOM, SD-312FG	30.50
FK3607	FASTENER KIT, 4 DEGREE WEDGE	25.00
FK3608	FASTENER KIT, 4 DEGREE WEDGE W / SDR STEERING	25.00
FK3700	FASTENER KIT, SHOE & RIDEPLATE	17.00
 (G) GASKETS		
G1006	GASKET, INTAKE (BERK & DOM)	38.50
G1008	GASKET, INTAKE (JACUZZI YJ)	38.50
G1101	GASKET, INTAKE, RUBBER (AT)	48.00
G1108	GASKET, INTAKE (JACUZZI WJ)	41.00
G1502	GASKET, BEARING CAP, BERKELEY 1/64 THK	12.00
G1502D	GASKET, BEARING CAP, BERKELEY 1/64 THK (DOUBLE DRILLED)	12.00
G1507	GASKET, BEARING CAP, DOM & AT, 1/32 THK	12.00
G1507D	GASKET, BEARING CAP, DOM & AT, 1/32 THK (DOUBLE DRILLED)	12.00
G2001	GASKET, BOWL, AT (EARLY)	24.50
G2006	GASKET, BOWL, BERK & DOM	20.50
G2008	GASKET, BOWL, JACUZZI YJ	20.50
G2106	GASKET, BOWL, BERK (16 HOLE)	20.50
G2206	GASKET, BOWL, BERK & DOM (GREEN MATERIAL)	22.50
G2206D	GASKET, BOWL, BERK & DOM, 16 HOLE (GREEN MATERIAL)	22.50
G2507	GASKET, NOZZLE HOUSING	15.00

AMERICAN TURBINE Item Price List

Item	Description	Price
G2507D	GASKET, NOZZLE HOUSING, 16 HOLES	15.00
G3001	GASKET, TRANSOM, 9/18, AT	47.50
G3006	GASKET, TRANSOM, 9/18, BERK & DOM	62.50
G3101	GASKET, SD-309 TRANSOM FLANGE ISOLATOR	26.50
G3201	GASKET, SD-312 TRANSOM FLANGE ISOLATOR	26.50
G3301	GASKET, INTAKE, SD203/312, ISOLATOR	34.50
G3601	GASKET, TRANSOM, AT, 3/16 CORK	115.50
G4001	GASKET 1/64" THK, STEERING MOUNT ASSEMBLY	10.00
G4101	GASKET 1/32" THK., SHIFT SHAFT MOUNT ASSEMBLY	8.00
G4508	GASKET, JACUZZI ENERGIZER SUC PIECE ADAPTOR	29.00
G5001	GASKET, INTAKE, RUBBER	275.00
(HAM) HAMILTONS 212 PARTS (MFG. BY AMERICAN TURBINE)		
H061483	SEAL, ROTARY (HAM 213 & 241)	137.50
H064726	O-RING, HAMILTON 212, WATER OFFTAKE	13.00
H106005	HAMILTON 241 BEARING CARRIER	93.00
H106011	CUTLASS BEARING, MARINE BEARING	602.00
H107528	HAMILTON, MAINSHAFT (PUMPSHAFT)	1,422.50
H107529	BEARING CARRIER	88.00
H107532	HAMILTON, BEARING RETAINING NUT	228.50
H107567	WATER BEARING SLEEVE	602.00
H107612	SEAL SLEEVE	220.00
H110202	BEARING HOUSING, BILLET, HAMILTON 212	796.00
H110343	IMPELLER / COUPLING KEY fits 212,213, & 241	71.50
H111718	HAM 212 SEAL FACE HOLDER	440.50
H200985	O-RING, HAMILTON 212, HAND HOLE COVER	22.50
H200999	O-RING, HAMILTON 212, STATOR	36.00
H201074	COTTER PIN, 3/16 X 2-1/2, 18-8 SS	6.50
H201244	SOCKET SET SCREW SS, BEARING RETAINER NUT	8.00
H203395	IMPELLER-COUPLING NUT fits 212,213,241	177.50
H61458	SEAL, HAMILTON 212, 213, 241 BEARING	62.50
H61464	O-RING, HAMILTON 212, SEAL FACE HOLDER	22.50
H61488	O-RING, HAMILTON 213 & 241, SEAL FACE HOLDER	26.50
H61489	O-RING, HAMILTON 241, STATOR	39.50
H63975	THRUST BEARING (HAMILTON 212)	384.00
HA103170	PIN, COTTER (RS3501 [MUST USE AT NUT])	96.00
HA107528	HAMILTON 212 SHAFT ASSEMBLY	3,027.00
HK201439	HAMILTON 213 & 241 BEARING KIT	997.00
HK63975	HAMILTON 212 BEARING KIT	900.50
(HPK) HIGH PERFORMANCE BEARING KITS		
HPK1902	HIGH PERFORMANCE BEARING KIT (STANDARD OEM BERKELEY)	827.00
HPK1903	HIGH PERFORMANCE BEARING KIT (EARLY DOMINATOR)	827.00

AMERICAN TURBINE Item Price List

Item	Description	Price
HPK1905	HIGH PERFORMANCE BEARING KIT (AT309, LATE 12S, LATE 12TD, BERK AQ SHAFT)	827.00
(I) INTAKES & COMPONENTS		
I1601	INTAKE BLOCK, SD231	1,572.50
I1602	RIDE PLATE, SD231	836.50
I1603	RIDE PLATE CYLINDER, SD231	286.00
I2780	OEM BERKELEY R INTAKE	2,422.00
I4007	GRATE, SPEED, I-1003 & I-1007	371.00
I4108	GRATE, ROCK, AFTER 7/97 FOR I-1307	508.00
I4201	GRATE, ROCK, AXIAL FLOW, TJ309	508.00
I4207	GRATE, SPEED, TJ	499.50
I4307	GRATE, BACK-UP, TJ	156.50
I4401	GRATE, INTAKE, SD203, 312	791.50
I4501	SPEED GRATE, SD-312FG	601.50
I4601	INTAKE GRATE, SD231	2,989.00
I4601-2	INTAKE GRATE BAR, SD231	24.50
I5001	SHOE, INTAKE, ROUGH, SD-312FG	217.00
I5002	SHOE, INTAKE, SD-312FG, SIZE 5/8"	256.50
I5003	SHOE, INTAKE, SD-312FG, SIZE 3/4"	256.50
I5004	SHOE, INTAKE, SD-312FG, SIZE 7/8"	256.50
I5005	SHOE, INTAKE, SD-312FG, SIZE 1"	256.50
I6307	SHOE, INTAKE, ROUGH, MAKES SIZE 1/2" & 5/8"	177.50
I6507	RIDEPLATE, ROUGH	217.00
I6601	RIDEPLATE, ROUGH, SD-312FG	294.00
I6607	RIDEPLATE, FINISHED	280.50
I6701	RIDEPLATE, FW	421.50
I6707	SHOE, INTAKE, ROUGH, MAKES SIZE 3/4", 7/8", & 1"	227.00
I6901	RIDEPLATE, 12TD, TJ309	330.50
I7003	YOKE, 2-1/8	139.00
I7201	RIDEPLATE, BRACKET, BW & FW	87.50
I7301	RIDEPLATE, BRACKET, 12TD TJ309	151.00
I8001	GRATE, INTAKE, FW	597.00
I9001	GRATE BAR, (NINE BAR INTAKE)	16.50
I9003	LOCKING BAR, (NINE BAR INTAKE)	41.50
IF6107F	BILLET 1/2" FLAT SHOE	347.50
IF6107T	BILLET 1/2" TAPERED SHOE	406.50
IF6607	SHOE SHIM, SIZE 0.060, FITS BILLET 1/2 SHOE	49.00
IF6707	SHOE SHIM, SIZE 0.125, FITS 1/2 BILLET SHOE	54.50
IK0156	LEGEND INTAKE KIT, OUTSIDE (MAX. 25% DISCOUNT)	1,543.00
IK0156HPF	INTAKE KIT, LEGEND OUTSIDE, HI-PERF, 1/2 FLAT SHOE (MAX. 25% DISCOUNT)	1,821.50
IK0156HPT	INTAKE KIT, LEGEND OUTSIDE, HI-PERF, 1/2 TAPERED SHOE (MAX. 25% DISCOUNT)	1,821.50
IK0701	INTAKE KIT, WELD-IN, STANDARD BOTTOM, LEGEND (MAX. 25% DISCOUNT)	1,543.00
IK0778	INTAKE KIT, WELD-IN, 7/8" BOTTOM, LEGEND (MAX. 25% DISCOUNT)	1,543.00

AMERICAN TURBINE Item Price List

Item	Description	Price
IK1003F	INTAKE KIT, DOM 12-S, 1/2 FLAT SHOE ONLY (MAX. 25% DISCOUNT)	1,397.50
IK1003HPF	INTAKE KIT, DOM 12-S, HI-PERF, 1/2 FLAT SHOE (MAX. 25% DISCOUNT)	1,864.00
IK1003HPT	INTAKE KIT, DOM 12-S, HI-PERF, 1/2 TAPERED SHOE (MAX. 25% DISCOUNT)	1,864.00
IK1003T	INTAKE KIT, DOM 12-S, 1/2 TAPERED SHOE ONLY (MAX. 25% DISCOUNT)	1,397.50
IK1007	INTAKE KIT, AT-309 (MAX. 25% DISCOUNT)	1,326.50
IK1007HPF	INTAKE KIT, AT-309, HI-PERF, 1/2 FLAT SHOE (MAX. 25% DISCOUNT)	1,864.00
IK1007HPT	INTAKE KIT, AT-309, HI-PERF, 1/2 TAPERED SHOE (MAX. 25% DISCOUNT)	1,864.00
IK1307	INTAKE KIT, WELD-IN, SD-309 (MAX. 25% DISCOUNT)	1,482.00
IK1307NS	INTAKE KIT, WELD-IN, NO-STEP, SD-309 (MAX. 25% DISCOUNT)	1,482.00
IK1401	INTAKE KIT, WELD-IN, SD-312 (MAX. 25% DISCOUNT)	1,864.00
IK1407	INTAKE KIT, BOLT-IN, SD-309 (MAX. 25% DISCOUNT)	1,326.50
IK1501	INTAKE KIT, FIBERGLASS, SD-312 (MAX. 25% DISCOUNT)	1,864.00
IK1501HP 05	INTAKE KIT, FIBERGLASS, SD-312, HI-PERF, 5/8 SHOE (MAX. 25% DISCOUNT)	2,176.50
IK1507	INTAKE KIT, FIBERGLASS, SD-309 (MAX. 25% DISCOUNT)	1,326.50
IK1507HPF	INTAKE KIT, HI-PERF, SD-309, 1/2 FLAT SHOE (MAX. 25% DISCOUNT)	1,864.00
IK1507HPT	INTAKE KIT, HI-PERF, SD-309, 1/2 TAPERED SHOE (MAX. 25% DISCOUNT)	1,864.00
IK1602	SD-231 RIDEPLATE KIT (25%)	2,219.00

(IM) IMPELLERS

IM1000	IMPELLER, INDUCER (25% max DISCOUNT)	936.50
IM1001	IMPELLER, INDUCER, NO SHAFT MACHINING (25% DISCOUNT)	936.50
IMA01A	IMPELLER, ALUMINUM, AT, SIZE DE	916.00
IMA01H	IMPELLER, STAINLESS, AT, HIGH HELIX, SIZE DE	3,323.50
IMA01S	IMPELLER, STAINLESS, AT, SIZE DE	2,443.00
IMA02A	IMPELLER, ALUMINUM, AT, SIZE D	916.00
IMA02H	IMPELLER, STAINLESS, AT, HIGH HELIX, SIZE D	3,323.50
IMA02S	IMPELLER, STAINLESS, AT, SIZE D	2,443.00
IMA03A	IMPELLER, ALUMINUM, AT, SIZE CD	916.00
IMA03H	IMPELLER, STAINLESS, AT, HIGH HELIX, SIZE CD	3,323.50
IMA03S	IMPELLER, STAINLESS, AT, SIZE CD	2,443.00
IMA04A	IMPELLER, ALUMINUM, AT, SIZE C	916.00
IMA04H	IMPELLER, STAINLESS, AT, HIGH HELIX, SIZE C	3,323.50
IMA04S	IMPELLER, STAINLESS, AT, SIZE C	2,443.00
IMA05A	IMPELLER, ALUMINUM, AT, SIZE BC	916.00
IMA05H	IMPELLER, STAINLESS, AT, HIGH HELIX, SIZE BC	3,323.50
IMA05S	IMPELLER, STAINLESS, AT, SIZE BC	2,443.00
IMA06A	IMPELLER, ALUMINUM, AT, SIZE B	916.00
IMA06H	IMPELLER, STAINLESS, AT, HIGH HELIX, SIZE B	3,323.50
IMA06S	IMPELLER, STAINLESS, AT, SIZE B	2,443.00
IMA07A	IMPELLER, ALUMINUM, AT, SIZE AB	916.00
IMA07H	IMPELLER, STAINLESS, AT, HIGH HELIX, SIZE AB	3,323.50
IMA07S	IMPELLER, STAINLESS, AT, SIZE AB	2,443.00
IMA08A	IMPELLER, ALUMINUM, AT, SIZE A	916.00

AMERICAN TURBINE Item Price List

Item	Description	Price
IMA08H	IMPELLER, STAINLESS, AT, HIGH HELIX, SIZE A	3,323.50
IMA08S	IMPELLER, STAINLESS, AT, SIZE A	2,443.00
IMA09A	IMPELLER, ALUMINUM, AT, SIZE A+	916.00
IMA09H	IMPELLER, STAINLESS, AT, HIGH HELIX, SIZE A+	3,323.50
IMA09S	IMPELLER, STAINLESS, AT, SIZE A+	2,443.00
IMA10A	IMPELLER, ALUMINUM, AT, SIZE AA	916.00
IMA10H	IMPELLER, STAINLESS, AT, HIGH HELIX, SIZE AA	3,323.50
IMA10HH	HIPPED HIGH HELIX IMPELLER, SIZE AA	4,280.50
IMA10S	IMPELLER, STAINLESS, AT, SIZE AA	2,443.00
IMA11A	IMPELLER, ALUMINUM, AT, SIZE 9.25	916.00
IMA11H	IMPELLER, STAINLESS, AT, HIGH HELIX, SIZE 9.25	3,323.50
IMA11HH	HIPPED HIGH HELIX IMPELLER, SIZE 9.25	4,280.50
IMA11S	IMPELLER, STAINLESS, AT, SIZE 9.25	2,443.00
IMA12A	IMPELLER, ALUMINUM, AT, SIZE 9.50	916.00
IMA12H	IMPELLER, STAINLESS, AT, HIGH HELIX, SIZE 9.5	3,323.50
IMA12HH	HIPPED HIGH HELIX IMPELLER, SIZE 9.5	4,280.50
IMA12HL	IMPELLER, STAINLESS, HIGH-HELIX, HIPPED, LEFT HAND, SIZE 9.5 (NO DISCOUNT)	6,349.50
IMA12S	IMPELLER, STAINLESS, AT, SIZE 9.50	2,443.00
IMA20S	IMPELLER, STAINLESS, SD-312, SIZE 2.4KW	2,527.00
IMA22S	IMPELLER, STAINLESS, SD-312, SIZE 2.6KW	2,527.00
IMA23S	IMPELLER, STAINLESS, SD-312, SIZE 2.75KW	2,527.00
IMA24S	IMPELLER, STAINLESS, SD-312, SIZE 2.9KW	2,527.00
IMA26S	IMPELLER, STAINLESS, SD-312, SIZE 3.3KW	2,527.00
IMA30S	IMPELLER, STAINLESS, SD-312, SIZE 4.0KW	2,527.00
IMA31S	IMPELLER, STAINLESS, SD-312, SIZE 4.5KW	2,527.00
IMA32S	IMPELLER, STAINLESS, SD-312, SIZE 5.0KW	2,527.00
IMB01A	IMPELLER, ALUMINUM, BERK, SIZE DE	916.00
IMB01H	IMPELLER, STAINLESS, BERK, HIGH HELIX, SIZE DE	3,323.50
IMB01S	IMPELLER, STAINLESS, BERK, SIZE DE	2,443.00
IMB02A	IMPELLER, ALUMINUM, BERK, SIZE D	916.00
IMB02H	IMPELLER, STAINLESS, BERK, HIGH HELIX, SIZE D	3,323.50
IMB02S	IMPELLER, STAINLESS, BERK, SIZE D	2,443.00
IMB03A	IMPELLER, ALUMINUM, BERK, SIZE CD	916.00
IMB03H	IMPELLER, STAINLESS, BERK, HIGH HELIX, SIZE CD	3,323.50
IMB03S	IMPELLER, STAINLESS, BERK, SIZE CD	2,443.00
IMB04A	IMPELLER, ALUMINUM, BERK, SIZE C	916.00
IMB04H	IMPELLER, STAINLESS, BERK, HIGH HELIX, SIZE C	3,323.50
IMB04S	IMPELLER, STAINLESS, BERK, SIZE C	2,443.00
IMB05A	IMPELLER, ALUMINUM, BERK, SIZE BC	916.00
IMB05H	IMPELLER, STAINLESS, BERK, HIGH HELIX, SIZE BC	3,323.50
IMB05S	IMPELLER, STAINLESS, BERK, SIZE BC	2,443.00
IMB06A	IMPELLER, ALUMINUM, BERK, SIZE B	916.00
IMB06H	IMPELLER, STAINLESS, BERK, HIGH HELIX, SIZE B	3,323.50

AMERICAN TURBINE Item Price List

Item	Description	Price
IMB06S	IMPELLER, STAINLESS, BERK, SIZE B	2,443.00
IMB07A	IMPELLER, ALUMINUM, BERK, SIZE AB	916.00
IMB07H	IMPELLER, STAINLESS, BERK, HIGH HELIX, SIZE AB	3,323.50
IMB07S	IMPELLER, STAINLESS, BERK, SIZE AB	2,443.00
IMB08A	IMPELLER, ALUMINUM, BERK, SIZE A	916.00
IMB08H	IMPELLER, STAINLESS, BERK, HIGH HELIX, SIZE A	3,323.50
IMB08S	IMPELLER, STAINLESS, BERK, SIZE A	2,443.00
IMB09A	IMPELLER, ALUMINUM, BERK, SIZE A+	916.00
IMB09H	IMPELLER, STAINLESS, BERK, HIGH HELIX, SIZE A+	3,323.50
IMB09S	IMPELLER, STAINLESS, BERK, SIZE A+	2,443.00
IMB10A	IMPELLER, ALUMINUM, BERK, SIZE AA	916.00
IMB10H	IMPELLER, STAINLESS, BERK, HIGH HELIX, SIZE AA	3,323.50
IMB10HH	HIPPED HIGH HELIX IMPELLER, BERK, SIZE AA	4,280.50
IMB10S	IMPELLER, STAINLESS, BERK, SIZE AA	2,443.00
IMB11A	IMPELLER, ALUMINUM, BERK, SIZE 9.25	916.00
IMB11H	IMPELLER, STAINLESS, BERK, HIGH HELIX, SIZE 9.25	3,323.50
IMB11S	IMPELLER, STAINLESS, BERK, SIZE 9.25	2,443.00
IMB12A	IMPELLER, ALUMINUM, BERK, SIZE 9.50	916.00
IMB12H	IMPELLER, STAINLESS, BERK, HIGH HELIX, SIZE 9.5	3,323.50
IMB12S	IMPELLER, STAINLESS, BERK, SIZE 9.50	2,443.00
IML02A	IMPELLER, ALUMINUM, LEGEND, SIZE D	916.00
IML04A	IMPELLER, ALUMINUM, LEGEND, SIZE C	916.00
IML05A	IMPELLER, ALUMINUM, LEGEND, SIZE BC	916.00
IML06A	IMPELLER, ALUMINUM, LEGEND, SIZE B	916.00
IML06S	IMPELLER, STAINLESS, LEGEND, SIZE B	2,443.00
IML07A	IMPELLER, ALUMINUM, LEGEND, SIZE AB	916.00
IML07S	IMPELLER, STAINLESS, LEGEND, SIZE AB	2,443.00
IML08A	IMPELLER, ALUMINUM, LEGEND, SIZE A	916.00
IML08S	IMPELLER, STAINLESS, LEGEND, SIZE A	2,443.00
IML10A	IMPELLER, ALUMINUM, LEGEND, SIZE AA	916.00
IML10S	IMPELLER, STAINLESS, LEGEND, SIZE AA	2,443.00
IML11A	IMPELLER, ALUMINUM, LEGEND, SIZE 9.25	916.00
IML11S	IMPELLER, STAINLESS, LEGEND, SIZE 9.25	2,443.00
IML12A	IMPELLER, ALUMINUM, LEGEND, SIZE 9.50	916.00
IML12S	IMPELLER, STAINLESS, LEGEND, SIZE 9.50	2,443.00
IMX203-138	IMPELLER, STAINLESS, SD191AF, SD203AF, 1.38 KW	4,007.00
IMX203-175	IMPELLER, STAINLESS, SD191AF, SD203AF, 1.75 KW	4,007.00
IMX203-280	IMPELLER, STAINLESS, SD203AF, 2.8 KW	2,417.00
IMX203-310	IMPELLER, STAINLESS, SD203AF, 3.1 KW	2,417.00
IMX231-290	IMPELLER, STAINLESS, SD231AF, 2.9 KW	3,110.50
IMX231-350	IMPELLER, STAINLESS, SD231AF, 3.5 KW	3,110.50
IMX231-420	IMPELLER, STAINLESS, SD231, 4.2KW	3,110.50
IMX231-450	IMPELLER, STAINLESS, SD231AF, 4.5 KW	3,110.50

AMERICAN TURBINE Item Price List

Item	Description	Price
ENERGIZER KITS (MAX DEALER DISCOUNT IS 25%)		
JK2108	WJ JACUZZI ENERGIZER KIT	4,117.50
JK2208	YJ JACUZZI ENERGIZER KIT	4,345.00
PK1001	PANTHER ENERGIZER KIT	5,493.50
KITS COME STANDARD WITH ALUMINUM IMPELLER & STANDARD STEERING SEE JETDRIVE PACKAGE PRICE SHEET FOR ADD ON OPTIONS		
(JT) JET TRIM PARTS		
JT0001	BUSHING, LOWER STEERING PIVOT (JET TRIM)	22.00
JT0002	STOP SLEEVE, JET TRIM HYD. CYL.	38.50
JT0003	JET TRIM REVERSE CABLE BRACKET, POLISHED	290.50
JT0004	JET TRIM REVERSE CABLE BRACKET	127.00
JT0005	RUDDER PIVOT BRACKET, JET TRIM	87.50
JT1011	PIVOT BLOCK, JET TRIM HYD. CYL.	180.50
JT1411	JET TRIM STEERING NOZZLE (NEW)	1,106.00
JT1911	JET TRIM NOZZLE (NEW)	1,179.50
JT2111	JET TRIM REVERSE BUCKET	605.00
JT2401	JET TRIM RUDDER	292.50
JT2501	JET TRIM RUDDER, POLISHED	406.00
JT3111	JET TRIM TILLER ARM	338.50
JT7211	HYDRAULIC CYLINDER, JET TRIM	334.00
JT7311	JET TRIM, HYD. CYLINDER, STRAIGHT FITTING	14.00
JTA8507C	JET TRIM ASSEMBLY, 3.19 INSERT (MAX. 25% DISCOUNT)	2,053.00
JTA8507D	JET TRIM ASSEMBLY, 3.25 INSERT (MAX. 25% DISCOUNT)	2,053.00
JTA8507H	JET TRIM ASSEMBLY, 3.60 INSERT (MAX. 25% DISCOUNT)	2,053.00
JTA8607A	JET TRIM ASSEMBLY, W/RK7301, 3.00 INSERT (MAX. 25% DISCOUNT)	2,797.50
JTA8607C	JET TRIM ASSEMBLY, W/RK7301, 3.19 INSERT (MAX. 25% DISCOUNT)	2,797.50
JTA8607D	JET TRIM ASSEMBLY, W/RK7301, 3.25 INSERT (MAX. 25% DISCOUNT)	2,797.50
JTA8607H	JET TRIM ASSEMBLY, W/RK7301, 3.60 INSERT (MAX. 25% DISCOUNT)	2,797.50
LEGEND PARTS		
J0027	LEGEND NOZZLE HOUSING	617.00
J0030-1	LEGEND 1 DEGREE WEDGE	298.50
J0030-2	LEGEND 2 DEGREE WEDGE	298.50
J0030-3	LEGEND 3 DEGREE WEDGE	298.50
J0030-4	LEGEND 4 DEGREE WEDGE	298.50
J0064	SEE PART # B1007	188.00
J0068	INSULATOR	12.00
J0079	TRANSOM ADAPTER	1,171.00
J0097	OEM BERKELEY NOZZLE HOUSING O-RING	9.00
J0098	LEGEND "E" HAND HOLE COVER	384.00
J0100	OEM LEGEND BOWL / SUCTION O-RING	16.50

AMERICAN TURBINE Item Price List

Item	Description	Price
J0101	OEM LEGEND NOZZLE HOUSING O-RING	12.00
J0102	OEM LEGEND BEARING CAP O-RING	8.00
J0104	1/4 NYLON WASHER	6.00
J0107	BALL JOINT ROD END	57.50
J0124-005	WEAR RING, STAINLESS UNSHOULDERED, SIZE -.005	296.50
J0125-050	WEAR RING, STAINLESS SHOULDERED, SIZE -.050	342.00
J0129	LEGEND "G" HAND HOLE COVER	352.50
J0150	HIGH-RISE INTAKE, INSIDE (MAX. 25% DISCOUNT)	1,102.00
J0151	HIGH-RISE INTAKE, OUTSIDE (MAX. 25% DISCOUNT)	1,102.00
J0155	12 DEGREE INTAKE, INSIDE (MAX. 25% DISCOUNT)	1,864.00
J0157	FLAT BOLT-IN INTAKE (MAX. 25% DISCOUNT)	1,864.00
J0167	LEGEND TRANSOM GASKET	57.50
J0168	TRANSOM FLANGE GASKET	60.00
J0173	LEGEND RUBBER BELLOWS	49.50
J0174	BERKELEY CABLE O-RING	6.00
J0250	LEGEND REVERSE BUCKET	461.50
J0287	LEGEND PACKING RING	24.00
J0338	LEGEND BEARING CAP	384.00
J0396	OEM BERKELEY TILLER SHAFT	135.00
J0397	LEGEND UPPER TILLER SHAFT	116.50
J0405	LEGEND STEERING NOZZLE	679.50
J0410	LEGEND "E" GRATE RETAINER (SEE PART # I4307	112.50
J0411	LEGEND "E" INTAKE GRATE	311.50
J0412	BERKELEY REVERSE CONTROL ARM PIN	41.00
J0413	BERKELEY REVERSE CABLE ADJUST NUT	26.50
J0426	BERKELEY REVERSE CABLE PACKER NUT	61.00
J0427	BERKELEY REVERSE CABLE SPLIT WASHER	11.50
J0430	LEGEND REVERSE CABLE PACKER PLATE	60.00
J0479	GROOVE PIN	14.00
J0480	GREASE FITTING	8.00
J0484	SHAFT SNAP RING, .094	18.00
J0488	REVERSE CABLE GROMMET (THIN WALL)	18.50
J0489	REVERSE CABLE GROMMET (THICK WALL)	18.50
J0530	STEERING TUBE NUT	41.00
J0532	STEERING TUBE LUBE NUT	64.00
J0567	LEGEND "E" CAVITATION PLATE	407.00
J0569	STANDARD RIDE PLATE	407.00
J0609	BERKELEY REVERSE RETAINING SPRING	41.00
J0645	LEGEND TILLER ARM	275.00
J0646	BERKELEY TILLER	275.00
J0680	5/16-18 FLANGE NUT	10.00
J0697	LEGEND DROOP SNOOT BUCKET	525.00
J0698	LEGEND DROOP SNOOT NOZZLE	646.00

AMERICAN TURBINE Item Price List

Item	Description	Price
J0699	LEGEND DROOP SNOOT HOUSING	941.50
J0715	LEGEND "E" SUCTION PIECE	2,298.00
J0726	LEGEND SUCTION PIECE BY AMERICAN TURBINE	2,494.50
J0726A	OEM LEGEND SUCTION PIECE	2,884.50
J0731	BERKELEY TRANSOM O-RING	26.50
J0753	LEGEND & BERKELEY RUDDER PIN	63.00
J0767	LEGEND / BERKELEY 6 BAR GRATE	378.00
J0800	7-BAR ROCK GRATE	539.50
J0803	9-BAR ROCK GRATE - TYPE 2	539.50
J0804	LEGEND 9-BAR ROCK GRATE	366.00
J0818-N	3/4 HOSE X 1/2 MPT NYLON BARB	8.00
J0818-S	BARB 3/4 HOSE X 1/2 MPT	12.00
J0820-N	1/2 PIPE PLUG NYLON HEX	8.00
J0820-S	HEX 1/2" PIPE PLUG	10.00
J0826	LEGEND REVERSE BUCKET PIN	52.00
J0840	CAVITATION PLATE BRACKET	191.50
J0850	BOWL PLUG, LEGEND PLASTIC	22.00
J0881	LIQUID TIGHT FITTING 3/8 NPT	14.00
J0882	3/8 NPT NYLON PLUG	6.00
J0883	DRAIN PLUG, 1/8 PIPE	12.00
J0885	UNIVERSAL TRANSOM FLANGE PLATE	702.50
J0886	TRANSOM FLANGE FORK	43.50
J0888	FLANGE PLATE O-RING	18.00
J0889	HOSE BARB CONNECTOR, UNIVERSAL FLANGE-LONG	87.50
J0891	UNIVERSAL TRANSOM FLANGE PLATE - SHORT	506.50
J0892	4" STEERING EXTENSION	121.50
J0894	DOME PLUG, TRANSOM PLATE 1/2-20	8.00
J0900	1/4 BALL JOINT WASHER	6.00
J0901	RUDDER WASHER	6.00
J0902	5/16 WASHER - HAND HOLE COVER	6.00
J0907	EYE BOLT, HH COVER	48.50
J0909	3/8 WASHER - BOWL	6.00
J0938	1/4-28 X 3/8 BUTTON HEAD CAP SCREW	8.00
J0942	7/8-14 NYLON JAM NUT	8.00
J0943	1/4-20 NYLON LOCK NUT	6.00
J1005	CAP, GREASE FITTING	6.00
J1014	3/4 X 6" WATER HOSE	14.00
J1016	PACKING REMOVAL TOOL (NO DISCOUNT)	49.50
K0592	OEM BERKELEY REVERSE CONTROL KIT	142.50
K0593	OEM BERKELEY REVERSE CABLE PACKER ASSEMBLY	80.00

(M) MISCELLANEOUS

M000P	WEDGE, 1/2 DEG, PLASTIC	111.50
-------	-------------------------	--------

AMERICAN TURBINE Item Price List

Item	Description	Price
M001A	WEDGE, 1 DEG, ALUMINUM	111.50
M001P	WEDGE, 1 DEG, PLASTIC	111.50
M002A	WEDGE, 2 DEG, ALUMINUM	111.50
M003A	WEDGE, 3 DEG, ALUMINUM	111.50
M003P	WEDGE, 3 DEG, PLASTIC	111.50
M004A	WEDGE, 4 DEG, ALUMINUM	111.50
M004P	WEDGE, 4 DEG, PLASTIC	111.50
M1000	SEALED ULTRA SUBMINIATURE SWITCH, SD231	71.50
M1001	CENTERING SPRING, RA231, SD231	20.00
M1008	RUBBER COVERED CLAMP, SD231	11.50
M1201	REVERSING RELAY, 150A SURGE, 75A CONTINUOUS	85.00
M1507	SPEED COAT, SPRAY CAN 12 OZ.	73.00
M2007	SKF PUMP GREASE #2 (NO DISCOUNT)	29.00
M2008	SCHAEFFER PUMP GREASE #0 (NO DISCOUNT)	26.50
M2009	SFR 2522 PUMP GREASE #2 (NO DISCOUNT)	26.50
M3001	PIVOT PIN, SHIFTER 40 SERIES CABLE	26.50
M3002	PIVOT PIN, SHIFTER 30 SERIES CABLE	26.50
M4007	RUBBER BELLOWS	47.50
M4107	HOSE CLAMP, LARGE	8.00
M4207	HOSE CLAMP, SMALL	8.00
M4501	HOSE CLAMP, TJ	14.00
M4601	1" DRAIN PLUG	14.00
M4701	BULK HEAD SEAL, HYD LINE	16.50
M4702	RECTIFIER DIODE (PACKAGE OF 4)	33.00
M4801	ZERK FITTING, STEERING TUBE SEAL	8.00
M4901	RUBBER ISOLATOR BOLT BUSHING	6.00
M5001	VINYL CAP, 3/8	6.00
M5007	IMPELLER WRENCH, PLATE STEEL (NO DISCOUNT)	80.00
M5107	IMPELLER PULLER (NO DISCOUNT)	352.50
M5107A	THREADED SHAFT FOR IMPELLER PULLER	55.50
M5107B	SCREW POINT TIP FOR IMPELLER PULLER	23.00
M5107C	O-RING, IMPELLER PULLER	2.50
M5108	BOWL BUSHING DRIVER	49.50
M5109	BERKELEY, DOMINATOR, AT, SUCTION SEAL DRIVER	57.50
M5110	BOWL SEAL DRIVER	48.00
M5111	DRIVER SHAFT	64.50
M5112	IMPELLER NUT SOCKET (NO DISCOUNT)	181.00
M5114	BERKELEY, DOM, AT, BEARING CAP SEAL	49.50
M5201	GREASE CAP (STEERING TUBE SEAL)	6.00
M5307	DRIVELINE ADAPTER 1310 (LATE FLY)-NO DISC.	204.00
M5407	DRIVELINE ADAPTER 1310 (LATE FLEX) - NO DISC.	204.00
M5507	DRIVELINE ADAPTER 1310 (EARLY FLEX) - NO DISC.	204.00
M5707	DRIVELINE ADAPTER 1350 (EARLY FLYWHEEL) NO DISC.	204.00

AMERICAN TURBINE Item Price List

Item	Description	Price
M5807	DRIVELINE ADAPTER 1350 (EARLY FLEX) NO DISC.	204.00
M5907	DRIVELINE ADAPTER 1310 LS (FLY)-NO DISC	306.00
M6007	DRIVELINE ADAPTER 1350 LS (FLEX) NO DISC.	306.00
M6107	DRIVELINE ADAPTER 1350 LS (FLYWHEEL) NO DISC.	306.00
M6207	DRIVELINE ADAPTER 1350 (LATE FLEX) NO DISC.	204.00
M6307	DRIVELINE ADAPTER CHEVY 1350 (LATE FLYWHEEL) NO DISC.	204.00
M6407	FORD 289-351 1310	306.00
M770001	LANOCOTE 4OZ (NO DISC)	22.50
M770003	LANOCOTE 16OZ (NO DISC)	57.50
M770007	LANOCOTE SPRAY (NO DISC)	32.50
MK1001	SEAL, THRUST BEARING, KODIAK / MP	30.50
MK1003	O-RING, SEAL FACE HOUSING, MP901, MP 3-STAGE, KODIAK	17.00
MK3507	3 STAGE IMPELLER NUT	76.50
(O) O-RINGS		
O1001	O-RING, HANDHOLE COVER, AT	17.00
O1002	O-RING, HANDHOLE COVER, BERK, SD & FW	17.00
O1003	O-RING, HANDHOLE COVER, DOM	17.00
O1101	O-RING, BOWL (PRE 1994, O-RINGS FITS INTO THE FACE OF THE BOWL, AT309 ONLY)	54.50
O1201	O-RING, TRANSOM SEAL, AT, 1/4 x 37-1/2"	18.50
O1301	O-RING, PLUG / HAND HOLE EXT.	17.00
O1401	O-RING, TEFLON, NOZZLE, AT	55.50
O1501	O-RING JET TRIM, UP/DN ENCAPSULATED	67.50
O1502	O-RING, TEFLON, NOZZLE, PRE 1994 BERK	41.50
O1505	O-RING, TEFLON, NOZZLE, DOM, BEST	48.50
O2002	O-RING, TRANSOM (BERK, DOM, YJ, WJ)	52.00
O2103	O-RING, SEAL-PAC, 12TD	20.00
O2203	O-RING, BOWL PLUG	14.00
O2204	O-RING, A356 BOWL PLUG	5.00
O2501	O-RING, STEERING BALL	9.00
O3001	O-RING, REVERSE CABLE PACKER	9.00
O3101	O-RING, BOWL (AT, SD231, WJ)	26.50
O3102	O-RING, BOWL TO SUCTION (OEM BERKELEY 1994 TO PRESENT)	26.50
O3108	O-RING, YJ SEAL-PAC, WJ BEARING HOUSING	18.00
O3201	O-RING, WATER TUBE, SD	10.50
O3208	O-RING, WJ NOZZLE, YJ/WJ INSPECTION COVER	22.50
O3301	O-RING, SEAL FACE HOUSING O.D., SD203, 309, 312	17.00
O3401	O-RING, SEAL FACE HOUSING, SD203, 309, 312	14.00
O3501	O-RING, STEERING TUBE SEAL	7.50
O3601	O-RING, BEARING CAP, HI-PERF.	15.50
O3801	O-RING, WATER TUBE, SD203, 312	9.00
O3901	O-RING, INTAKE, SD-312	50.50
O4001	O-RING, SD-312 BOWL, SD203 STATOR	20.00

AMERICAN TURBINE Item Price List

Item	Description	Price
O5001	O-RING, NOZZLE HOUSING, SD191, SD203, TJ191	22.50
O5018	O-RING, STEERING SHAFT, SD231	6.00
O5024	O-RING, WATER TUBE, SD231	6.00
O5026	O-RING, BEARING SLEEVE STATOR	6.00
O5035	O-RING, OIL RESERVOIR LID	29.00
O5123	O-RING, SHAFT TO SLINGER RING 12S-MR	20.00
O5124	O-RING, WATER TAKE OFF, SD231	6.00
O5126	O-RING, EHA MOUNT, SD231	6.00
O5152	O-RING, SEAL FACE HOUSING SMALL, SD231	6.50
O5154	O-RING, SEAL FACE HOUSING, SD231	6.50
O5156	O-RING, STATOR BEARING CARTRIDGE, SD231	7.50
O5172	O-RING, WEAR PLATE, SD203AF	17.00
O5204	O-RING, SHIFT SHAFT PIN, SD231	12.00
O5262	O-RING, NOZZLE HOUSING, SD231	6.50
O5264	STAGE PUMP STATOR O-RING	29.00
O5271	O-RING, WEAR SLEEVE, SD231	9.00
O5320	O-RING, SHAFT TO PRELOAD RING 12S-MR	22.50
O5352	O-RING, HANDHOLE COVER, SD231	6.50
O5363	O-RING, TEFLON, NOZZLE, SD203	80.00
O5369	O-RING, TEFLON, NOZZLE, 231AF	133.50
O62080	O-RING, OIL RESERVOIR TO SUCTION 12S-MR	35.00
(OHK) OVERHAUL KITS		
OHK1001	AT-309 OVERHAUL KIT	820.00
OHK1001HP	AT-309 HP OVERHAUL KIT (SERIAL # 25649 - PRESENT)	897.50
OHK1001UP	AT-309 OVERHAUL KIT UPGRADE (HP BEARING KIT REQUIRED - PART # HPK1905)	617.00
OHK1002	OEM BERKELEY OVERHAUL KIT	749.00
OHK1002HP	OEM BERKELEY HP OVERHAUL KIT	897.50
OHK1002UP	OEM BERKELEY OVERHAUL KIT UPGRADE (HP BEARING KIT REQUIRED - PART # HPK1902)	617.00
OHK1003	DOM 12-S OVERHAUL KIT (SERIAL # 23598 - 25562)	774.00
OHK1003HP	DOM 12-S HP OVERHAUL KIT (SERIAL # 25562 - PRESENT)	859.00
OHK1003UP	DOM 12-S OVERHAUL KIT UPGRADE, REQUIRES PART # HPK1905 (SERIAL # 23598 - PRESENT)	617.00
OHK1103	DOM 12-S OVERHAUL KIT (SERIAL # 14400 - 23597)	774.00
OHK1103HP	DOM 12-S HP OVERHAUL KIT (SERIAL # 14400 - 23597)	897.50
OHK1103UP	DOM 12-S OVERHAUL KIT UPGRADE, REQUIRES HPK1905 (SERIAL # 14400 - 23597)	617.00
OHK1203	DOM 12-S OVERHAUL KIT (SERIAL # UP TO 14400)	882.00
OHK1203HP	DOM 12-S HP OVERHAUL KIT (SERIAL # UP TO 14400)	935.50
OHK1203UP	DOM 12-S OVERHAUL KIT UPGRADE, REQUIRES HPK1903 (SERIAL # UP TO 14400)	749.00
OHK120AT	LEGEND "AT" OVERHAUL KIT	859.00
OHK120G	LEGEND "G" OVERHAUL KIT	702.50
OHK120GUP	LEGEND "G" OVERHAUL KIT UPGRADE (HP BEARING KIT REQUIRED - PART # HPK1902)	617.00
OHK1301	SD-309 OVERHAUL KIT	859.00
OHK1401	SD-312 OVERHAUL KIT, WELDED ALUMINUM	1,155.00

AMERICAN TURBINE Item Price List

Item	Description	Price
OHK1501	SD-312FG OVERHAUL KIT, FIBERGLASS	1,287.50
OHK1503	DOM 12-TD OVERHAUL KIT (SERIAL # 23598 - PRESENT)	749.00
OHK1503HP	DOM 12-TD HP OVERHAUL KIT (SERIAL # 25562 - PRESENT)	859.00
OHK1503UP	DOM 12-TD OVERHAUL KIT UPGRADE, REQUIRES HPK1905 (SERIAL # 23598 - PRESENT)	617.00
OHK1603	DOM 12-TD OVERHAUL KIT (SERIAL # 17430 - 23597)	749.00
OHK1603HP	DOM 12-TD HP OVERHAUL KIT (SERIAL # 17430 - 23597)	897.50
OHK1603UP	DOM 12-TD OVERHAUL KIT UPGRADE, REQUIRES HPK1905 (SERIAL # 17430 - 23597)	617.00
OHK1703	DOM 12-TD W/O PACKING OVERHAUL KIT (SERIAL # UP TO 14400)	859.00
OHK1803	DOM 12-TD W/O PACKING OVERHAUL KIT (SERIAL # 14400 - 17430)	859.00
OHK191TJ	TJ191 AXIAL FLOW OVERHAUL KIT	1,337.50
OHK2008	YJ JACUZZI ENERGIZER OVERHAUL KIT	950.50
OHK203AF	SD203AF AXIAL FLOW OVERHAUL KIT	1,155.00
OHK203ind	SD203 INDMAR AXIAL FLOW OVERHAUL KIT	1,155.00
OHK2108	WJ JACUZZI ENERGIZER OVERHAUL KIT	909.00
OHKMP901	OEM MARINE POWER 901 OVERHAUL KIT	750.00
OHKPK001	PANTHER ENERGIZER OVERHAUL KIT	757.50
PK0001	OEM PANTHER OVERHAUL KIT	864.00

(P) PANTHER OEM REPLACEMENT PARTS

P1001	PANTHER TRANSOM SEAL, 39"	10.50
P1007	OEM PANTHER BEARING CAP SEAL	50.50
P1101	OEM PANTHER BEARING	269.00
P1102	OEM PANTHER BEARING RACE	118.00
P1502	OEM PANTHER TAIL BUSHING	39.50
P2003	OEM PANTHER STATOR SEAL	64.50
P3007	OEM PANTHER IMPELLER KEY	9.00
P3507	OEM PANTHER IMPELLER LOCKNUT	24.50
P4008	OEM PANTHER MECHANICAL SEAL	129.00
P5507	OEM PANTHER WOODRUFF KEY	10.00

(R) STEERING COMPONENTS

R1007	NOZZLE, HOUSING (BERK, DOM, BEST)	508.00
R1101	NOZZLE, HI-FLOW, NO REVERSE	591.50
R1201	NOZZLE, HI-FLOW, W / REVERSE	598.00
R1401	NOZZLE, TRIM, MIDDLE TRANSITION	664.50
R1701	NOZZLE, HTR	664.50
R1703	NOZZLE, DOMINATOR	664.50
R1707B	NOZZLE, BERK, 3.25 BORE	664.50
R1707C	NOZZLE, BERK, 3.70 BORE	664.50
R1901	NOZZLE, TRIM	836.50
R2001	NOZZLE, HTR II, SDR	692.00
R2101	REVERSE BUCKET, HTR	275.00
R2101B	REVERSE BUCKET, BERK (AT STYLE)	311.50

AMERICAN TURBINE Item Price List

Item	Description	Price
R2103	REVERSE BUCKET, DOM	311.50
R231A	30 SERIES CABLE ADAPTER, SD231	93.50
R231B	CABLE SWITCH BACK - POWER SHIFT	108.50
R231F	CABLE SWITCH FRONT - POWER SHIFT	90.00
R231S	CABLE SWITCH SHAFT - POWER SHIFT	76.50
R2701	RUDDER, 3-BOLT, BW	213.00
R2801	TILLER ARM, FW	463.50
R3001	TILLER ARM, BEST	306.00
R3003	TILLER ARM, DOM	306.00
R3101	TILLER ARM, TRIM, MANUAL	306.00
R3201	TILLER ARM, TRIM, HYDRAULIC	306.00
R3202	HYDRAULIC TUBING (NO DISCOUNT) PER FOOT	7.50
R3301	TILLER ARM, HTR	306.00
R3401	TILLER BRACKET, FW	80.00
R3601	PIN, UPPER STEERING	57.50
R3701	PIN, LOWER STEERING, REVERSE BUCKET	41.50
R3702	5/8-11 X 1 SOCKET HEAD CAP SCREW W/ 5/8 PIVOT HEAD	24.00
R3703	5/8-11 X 5/8 SOCKET HEAD CAPSCREW W/ 3/4 PIVOT HEAD (BUCKET)	22.50
R3801	UP/DN LEVER, TRIM HYDRAULIC	306.00
R3901	UP/DN LEVER, TRIM MANUAL	306.00
R4001	1/4 O.D. NPT MALE ELBOW	26.00
R4002	1/4 O.D. PUSH TO CONNECT UNION WYE	62.50
R5005	PIN, REVERSE PIVOT	41.50
R5108	PIN, REVERSE PIVOT 10/32 THRD.	41.50
R5201	PIN, HYDRAULIC PIVOT	41.50
R5301	THREADED ADAPTER for R5401 1-5/16 x 1-12	96.00
R5401	STEERING CABLE ADAPTER, FW	306.00
R5507SS	KEY, WOODRUFF #9 STAINLESS STEEL	15.50
R6007	HOUSING, DROOP SNOOT, 7 DEGREES, BERK, DOM	591.50
R6101	SHORT SNOOT, AT	561.50
R6107	DROOP SNOOT, SHORT, BERK, DOM	561.50
R6201	LONG SNOOT, AT (STRAIGHT)	610.50
R6301	HI-FLOW DROOP SNOOT HSG, 1-3/16 DROP, 7 DEGREES (AT)	610.50
R6507	EXTENSION HOUSING, 2"	532.50
R6607	EXTENSION HOUSING, 6"	732.50
R70010	NOZZLE INSERT, TRIM, SIZE 3.000	106.00
R70012	NOZZLE INSERT, TRIM, SIZE 3.125	106.00
R70013	NOZZLE INSERT, TRIM, SIZE 3.187	106.00
R70014	NOZZLE INSERT, TRIM, SIZE 3.250	106.00
R70015	NOZZLE INSERT, TRIM, SIZE 3.312	106.00
R71010	NOZZLE INSERT, HTR, SIZE 3.000	106.00
R71012	NOZZLE INSERT, HTR, SIZE 3.125	106.00
R71013	NOZZLE INSERT, HTR, SIZE 3.187	106.00

AMERICAN TURBINE Item Price List

Item	Description	Price
R71014	NOZZLE INSERT, HTR, SIZE 3.250	106.00
R71015	NOZZLE INSERT, HTR, SIZE 3.312	106.00
R7201	HYDRAULIC CYLINDER, TURBINE TRIM	217.00
R7202	DIVERTER VALVE CYLINDER	298.50
R7300	NOZZLE INSERT, HTR II, SDR, JET TRIM, SIZE 3.00	106.00
R7301	HYDRAULIC CONTROL UNIT (MAX. 25% DISCOUNT) PUMP ONLY	1,053.50
R7319	NOZZLE INSERT, HTR II, SDR, JET TRIM, SIZE 3.19	106.00
R7325	NOZZLE INSERT, HTR II, SDR, JET TRIM, SIZE 3.25	106.00
R7350	NOZZLE INSERT, HTR II, SDR, JET TRIM, SIZE 3.50	106.00
R7360	NOZZLE INSERT, HTR II, SDR, JET TRIM, SIZE 3.60	106.00
R7370	NOZZLE INSERT, HTR II, SDR, JET TRIM, SIZE 3.70	106.00
R7380	NOZZLE INSERT, HTR II, SDR, JET TRIM, SIZE 3.80	106.00
R8301	20 FT. HYD. UNIT WIRE	63.00
R8307	90 DEG. BRASS FITTING, HYDRAULIC CYLINDER	15.50
R8309	TRIM RECTIFIER	80.00
R8401	FUSE HOLDER	12.00
R8407	BRASS INSERT FOR PLASTIC TUBE	6.00
R8409	TRIM SWITCH	60.00
R9106	GROMMET, STEERING TUBE	16.50
R9107	STEERING EXTENSION, 6-1/2	134.50
R9206	STEERING TUBE NUT	39.50
R9207	STEERING EXTENSION 10" C-C	134.50
R9208	FW CABLE ADAPTER 43BC TO 33C	0.00
R9401	STEERING ADJUSTER	213.00
R9601	STEERING EXTENSION, 4-1/8	134.50
R9607	WIRING HARNESS, HYD UNIT	257.50
R9701	O-RING BACK-UP	12.00
RA1101A	STEERING ASSEMBLY, HI-FLOW, NO REVERSE, 3.000 INSERT (MAXIMUM DISCOUNT 25%)	1,264.50
RA1101B	STEERING ASSEMBLY, HI-FLOW, NO REVERSE, 3.125 INSERT (MAXIMUM DISCOUNT 25%)	1,264.50
RA1201A	STEERING ASSEMBLY, HI-FLOW DROOP, 3.000 INSERT (MAXIMUM DISCOUNT 25%)	1,476.00
RA1201B	STEERING ASSEMBLY, HI-FLOW DROOP, 3.125 INSERT (MAXIMUM DISCOUNT 25%)	1,476.00
RA1201C	STEERING ASSEMBLY, HI-FLOW DROOP, 3.187 INSERT (MAXIMUM DISCOUNT 25%)	1,476.00
RA1201D	STEERING ASSEMBLY, HI-FLOW DROOP, 3.250 INSERT (MAXIMUM DISCOUNT 25%)	1,476.00
RA1201E	STEERING ASSEMBLY, HI-FLOW DROOP, 3.312 INSERT (MAXIMUM DISCOUNT 25%)	1,476.00
RA1301A	STEERING ASSEMBLY, LONG STRAIGHT SNOOT, 3.000 INSERT (MAXIMUM DISCOUNT 25%)	1,499.00
RA1301B	STEERING ASSEMBLY, LONG STRAIGHT SNOOT, 3.125 INSERT (MAXIMUM DISCOUNT 25%)	1,499.00
RA1301C	STEERING ASSEMBLY, LONG STRAIGHT SNOOT, 3.187 INSERT (MAXIMUM DISCOUNT 25%)	1,499.00
RA1401A	STEERING ASSEMBLY, STANDARD, 3.000 INSERT (MAXIMUM DISCOUNT 25%)	1,321.50
RA1401B	STEERING ASSEMBLY, STANDARD, 3.125 INSERT (MAXIMUM DISCOUNT 25%)	1,321.50
RA1401C	STEERING ASSEMBLY, STANDARD, 3.187 INSERT (MAXIMUM DISCOUNT 25%)	1,321.50
RA1401D	STEERING ASSEMBLY, STANDARD, 3.250 INSERT (MAXIMUM DISCOUNT 25%)	1,321.50
RA1401E	STEERING ASSEMBLY, STANDARD, 3.312 INSERT (MAXIMUM DISCOUNT 25%)	1,321.50
RA1701C	STEERING ASSEMBLY, HTR, 3.187 INSERT (MAXIMUM DISCOUNT 25%)	1,343.50

AMERICAN TURBINE

Item Price List

Item	Description	Price
RA1701D	STEERING ASSEMBLY, HTR, 3.250 INSERT (MAXIMUM DISCOUNT 25%)	1,343.50
RA1703	STEERING ASSEMBLY, DOMINATOR, W /RUDDER (MAXIMUM DISCOUNT 25%)	1,446.50
RA1705	STEERING ASSEMBLY, DROOP SNOOT, DOMINATOR (MAXIMUM DISCOUNT 25%)	1,340.00
RA1707D	STEERING ASSEMBLY, BERK, 3.25 BORE (AT) (MAXIMUM DISCOUNT 25%)	1,326.50
RA1707DR	STEERING ASSEMBLY, BERK, 3.25 BORE, W/RUDDER (MAXIMUM DISCOUNT 25%)	1,465.50
RA1707I	STEERING ASSEMBLY, BERK, 3.70 BORE (SD312) (MAXIMUM DISCOUNT 25%)	1,330.50
RA231	CABLE SWITCH, 40 SERIES	776.50
RA231B	TOGGLE CABLE SWITCH, SD231	335.00
RA4701	PIN ASSEMBLY, UP / DOWN, TRIM	96.00
RA8007	STEERING CLEVIS ASSEMBLY (BILLET)	71.50
RA8107A	STEERING ASSEMBLY, MANUAL TRIM, 3.000 INSERT	1,928.00
RA8107B	STEERING ASSEMBLY, MANUAL TRIM, 3.125 INSERT	1,928.00
RA8107C	STEERING ASSEMBLY, MANUAL TRIM, 3.187 INSERT	1,928.00
RA8107D	STEERING ASSEMBLY, MANUAL TRIM, 3.250 INSERT	1,928.00
RA8107E	STEERING ASSEMBLY, MANUAL TRIM, 3.312 INSERT	1,928.00
RA8507A	STEERING ASSEMBLY, HYD. TRIM, 3.000 INSERT	1,928.00
RA8507B	STEERING ASSEMBLY, HYD. TRIM, 3.125 INSERT	1,928.00
RA8507C	STEERING ASSEMBLY, HYD. TRIM, 3.187 INSERT	1,928.00
RA8507D	STEERING ASSEMBLY, HYD. TRIM, 3.250 INSERT	1,928.00
RA8507E	STEERING ASSEMBLY, HYD. TRIM, 3.312 INSERT	1,928.00
RA8707A	STEERING ASSEMBLY, HYD. TRIM W/RK7301, 3.000 INSERT	2,445.00
RA8707B	STEERING ASSEMBLY, HYD. TRIM W/RK7301, 3.125 INSERT	2,445.00
RA8707C	STEERING ASSEMBLY, HYD. TRIM W/RK7301, 3.187 INSERT	2,445.00
RA8707D	STEERING ASSEMBLY, HYD. TRIM W/RK7301, 3.250 INSERT	2,445.00
RA8707E	STEERING ASSEMBLY, HYD. TRIM W/RK7301, 3.312 INSERT	2,445.00
RA9208	FW CABLE ADAPTER KIT, 43BC TO 33C	119.00
RK2505	RUDDER ASSEMBLY, 4-BOLT (DOM, TRIM)	212.50
RK2601	RUDDER KIT, 3-BOLT	212.50
RK7301	HYDRAULIC CONTROL KIT (MAX 25%)	1,112.00
(RS) HTR II STEERING COMONENTS		
RS1001	HTR II, CONTROL ROD BRACKET	139.00
RS1101	HTR II, STEERING NOZZLE (OLD STYLE)	676.00
RS2101	HTR II, REVERSE BUCKET	696.00
RS2131	HTR II, BUSHING (BUCKET PIVOT)	26.50
RS2201	HTR II, BUCKET BRACKET (STARBOARD)	198.50
RS2301	HTR II, PUSH PULL ROD	188.00
RS2401	HTR II, REVERSE LEVER ARM	306.00
RS2501	HTR II, BUCKET BRACKET (PORT)	181.00
RS2621	HTR II, TAPPERED SPACER	20.00
RS2623	HTR II, BRONZE BUSHING 3/8X 1/2	16.50
RS2701	HTR II, DETENT SPRING	127.00
RS2801	HTR II, TILLER ARM (OLD STYLE)	231.00

AMERICAN TURBINE Item Price List

Item	Description	Price
RS2802	HTR II, LOCK BLOCK SPRING	78.00
RS2901	HTR II, LOCK HOUSING	165.00
RS2911	HTR II, TILLER ARM, (NEW STYLE)	165.50
RS3001	HTR II, LOCK PLATE	41.00
RS3101	HTR II, LOCK HUB	108.50
RS3201	HTR II, NYLINER BEARING	10.00
RS3501	HTR II, TAPER LOCK PIN	96.00
RS5001	HTR II, BEZEL (SHIFT ROD / STEERING)	140.50
RS5101	HTR II, BRAKE ROD	110.00
RS5221	HTR II, SHIFT SHAFT	150.00
RS5231	HTR II, SHAFT LOCK COLLAR (TWO PIECE)	63.00
RS5351	HTR II, SPERICAL BEARING	68.00
RS5601	HTR II, SHIFT ROD SEAL	38.50
RS5621	HTR II, SHIFT ROD BALL	48.00
RS5801	HTR II, 64 SERIES CABLE CLAMP	16.00
RS5901	HTR II, 64 SERIES CABLE SHIM	10.00
RS6101	HTR II, CABLE BRACKET, 64C	68.00
RS6201	HTR II, PLASTIC COLLAR (ONE PIECE)	39.50
RS6301	HTR II, BRACKET, SPRAY DEFLECTOR	69.50
RS6401	HTR II, SPRAY DEFLECTOR	286.50
RSA2001C	STEERING ASSEMBLY, HTR II, 3.19 INSERT (MAXIMUM DISCOUNT 25%)	1,213.50
RSA2001D	STEERING ASSEMBLY, HTR II, 3.25 INSERT (MAXIMUM DISCOUNT 25%)	1,213.50
RSA2001I	STEERING ASSEMBLY, HTR II, 3.70 INSERT (MAXIMUM DISCOUNT 25%)	1,213.50
RSA5001	SHIFT ROD BEZEL ASSEMBLY, HTR II	139.00
RSA5002	ROUND TRANSOM CONTROL BEZEL ASSEMBLY	139.00
RSA5101	BRAKE ROD ASSEMBLY, HTR II	527.00
RSA5221	SHIFT SHAFT ASSEMBLY, HTR II	929.50
RSA5301	HTR II, LEVER BOSS & ARM ASSEMBLY	94.50
RSK2101C	HTR II BUCKET KIT, 3.19 INSERT (MAXIMUM DISCOUNT 25%)	2,455.00
RSK2101D	HTR II BUCKET KIT, 3.25 INSERT (MAXIMUM DISCOUNT 25%)	2,455.00
RSK2101I	HTR II BUCKET KIT, 3.70 INSERT (MAXIMUM DISCOUNT 25%)	2,455.00
RSK5001	STEERING KIT, HTR II (ROUND BEZEL)	247.00
(RV) SD-231 STEERING COMPONENTS		
RV1001	REVERSE CABLE BRACKET, SD231	345.00
RV1001A	30 SERIES CABLE CLAMP ADAPTER, SD231	63.00
RV1006	BUSHING CAP, STEERING PIVOT, SD231	69.50
RV1007	HOUSING, NOZZLE, SD231	600.00
RV1107	PIVOT BOLT SHIM .036, SD231	7.50
RV1207	PIVOT BOLT SHIM .010, SD231	10.00
RV1307	SHIM,BUSHING CAP .008	7.50
RV1407	SHIM,BUSHING CAP .005	7.50
RV2001	NOZZLE, SD231	638.50

AMERICAN TURBINE Item Price List

Item	Description	Price
RV2002	NOZZLE VANE, SD231	46.00
RV2101	REVERSE BUCKET, SD231	1,599.00
RV2104	REVERSE SPRING TAB, SD231	33.50
RV2105	REVERSE BUCKET SPRING, SD231	94.50
RV2106	SHIFT CONTROL FOLLOWER, SD231	333.00
RV2200	TILLER ARM. SD231, BILLET	465.50
RV2201	STEERING TIE ROD, SD231	107.50
RV3000	STEERING SHAFT ARM (INSIDE), SD231	137.50
RV3001	STEERING STOP, SD231	78.00
RV3002	STEERING SHAFT ARM (OUTSIDE), SD231	46.50
RV3003	STEERING SHAFT, SD231	124.50
RV3004	SNAP RING SS 3/4, STEERING, SD231	17.00
RV3703	5/8-11 X 5/8 SOCKET HEAD CAPSCREW W/ 3/4 PIVOT HEAD TYPE 304	22.50
RV4000	EHA MOUNT, SD231	365.00
RV4001	EHA SHAFT LINK, SD231	303.50
RV4002	SHIFT SHAFT-1, SD231	144.50
RV4003	SHIFT SHAFT-2, SD231	144.50
RV4004	ELECTRIC - HYDRAULIC ACTUATOR	3,184.00
RV4005	EHA MOUNT SHIM	7.50
RV7400	SD231 NOZZLE INSERT, 4.0	195.00
RV7420	SD231 NOZZLE INSERT, 4.2	195.00
RV7430	SD231 NOZZLE INSERT, 4.3	195.00
RV7440	SD231 NOZZLE INSERT, 4.4	195.00
RVA2001	SD231 STEERING ASSEMBLY (MAX. 25% DISCOUNT)	1,835.50
(SC) SUCTION COMPONENTS		
SC1001	SUCTION PIECE, AT-309 (10-1/2 BOLT CIRCLE)	2,182.50
SC1001A	SUCTION PIECE, AT-309 (10-1/4 BOLT CIRCLE, 9-1/8"REGISTER)	2,182.50
SC1003	SUCTION PIECE, 12-S (10-1/2 BOLT CIRCLE)	2,182.50
SC1003A	SUCTION PIECE, 12-S (10-1/4 BOLT CIRCLE)	2,311.50
SC1003DR	SUCTION PIECE, 12-S, DRAG RACE (10-1/2 BOLT CIRCLE)	4,229.50
SC1003MR	SUCTION PIECE, 12-S, MARATHON RACE (10-1/2 BOLT CIRCLE)	4,674.00
SC1201	SUCTION PIECE, FW-309	2,227.50
SC1301	SUCTION PIECE, SD-309	2,269.00
SC1401	SUCTION PIECE, SD-312	2,409.50
SC1403	SUCTION PIECE, 12TD, TJ-309 (10-1/2 BOLT CIRCLE)	2,428.00
SC1412	SUCTION HOUSING, SD231	6,138.00
SC1501	HAND HOLE COVER, AT-309	181.00
SC1601	SUCTION PIECE, SD-312 FIBERGLASS	2,409.50
SC1701	HAND HOLE COVER, SD-309, FW, TJ	156.00
SC1703	HAND HOLE COVER, 12-S	328.50
SC1703MR	HAND HOLE COVER, 12-S, MARATHON RACE	0.00
SC1801	HAND HOLE COVER, SD203, 312	181.00

AMERICAN TURBINE Item Price List

Item	Description	Price
SC1901	HAND HOLE COVER, SD-231	156.00
SC2001	OIL COOLED MAIN BEARING HOUSING	587.50
SC2002	OIL COOLED RESERVOIR CAP	217.00
SC2003	BEARING CAP, 12TD W/O PACKING, SERIAL # UP TO 17430	364.00
SC2007	BEARING CAP, PRE 1998	328.50
SC2008	WJ BEARING CAP (BILLETT ALUMINUM) RED	390.00
SC2009	JACUZZI YJ, BEARING CAP, BILLET	231.00
SC2101	BEARING HOUSING, SD203, 309, 312	367.50
SC2107	BEARING CAP, HI-PERFORMANCE	367.00
SC2109	BEARING HOUSING, PANTHER ENERGIZER	356.50
SC2209	BEARING CAP, PANTHER ENERGIZER	455.50
SC2507	PACKING FOLLOWER (SET 2)	189.00
SC3007	PACKING RING (5 RINGS PER SET)	152.50
SC4007	ENGINE MOUNT RING (BEARING CAP)	46.50
SC4101	NIPPLE, WATER COOLING TUBE (SD203, 312)	64.00
SC4201	WATER TUBE, (SD312)	98.00
SC4212	BEARING HOUSING, SD231	228.50
SC4302	FLANGE MOUNT WATER TUBE, SD231	150.00
SC4314	WATER TUBE, SD231	138.50
SC4401	WATER TUBE, SD	64.50
SC4501	WATER TUBE, FW	73.50
SC4502	HOSE NIPPLE, ENGINE COOLING, SD231	43.50
SC4507	BARBED CONNECTOR - 3/8 P X 5/8 H	58.00
SC4601	HOSE NIPPLE, ENGINE COOLING (FW)	101.50
SC4603	BULKHEAD WATER CONNECTOR TJ	106.00
SC4607	BARBED CONNECTOR - 3/4 P X 3/4 H	29.00
SC4707	COOLANT CONNECTOR, BALL VALVE, 3/8 NPT (SD309)	43.50
SC4807	BYBASS VALVE, COOLING LINE	204.00
SC4902	DRIVE SCREW TYPE U, #4 X 1/4	6.00
SC5001	HAND HOLE EXTENSION HOUSING	572.00
SC5101	HAND HOLE EXTENSION PLUG	597.00
SC5201	SD-312 LANYARD CHAIN, 7-1/4"	26.50
SC5301	SD-312 LANYARD RIVET	5.50
SC5401	SD-312 LANYARD ENDS	8.00
SC6008	SUCTION PIECE ADAPTER, YJ ENERGIZER	496.50
SC6009	SUCTION PIECE ADAPTER, PANTHER ENERGIZER	490.00
SC6108	BRASS NIPPLE, (1/4 X 3)	30.50
SC6109	HOSE BARB 5/8 HOSE X 1/2 PIPE, PANTHER ENGERGIZER KIT	14.00
SC6208	WATER ADPT FITTING 1/4 TO 3/8	14.00
SC6209	COOLING HOSE, PANTHER JET ENGERGIZER KIT (9")	16.50
SC6309	BRASS HEX PLUG 1/2 NPT, PANTHER JET ENGERGIZER KIT	16.50
SC8701	GREASE ZERK, 1/8" DRIVE-IN	10.00
SC8801	1/8" 45 DEG. GREASE FITTING	18.00

AMERICAN TURBINE Item Price List

Item	Description	Price
SC8901	STAINLESS GREASE ZERK, STRAIGHT	15.50
SC8902	STAINLESS GREASE ZERK, 90 DEGREE	33.00
SC9000	PRIME-A-JET	119.00
SC9002	BERKELEY BOWL SEAL RETAINER (NO DISCOUNT)	85.50
SC9201	BOWL, SNAP RING	26.50
SC9202	RETAINING RING, SEAL RETAINER, SD231	18.50
SC9203	SNAP RING, SEALED BRG ASSEMBLY	11.50
SC9412	STATOR, SD231 (7 VANE)	1,369.50
SC9701	BOWL ADAPTER RING (1/8)	48.00
SC9706	BOWL ADAPTER RING (3/16)	48.00
SC9902	PIPE PLUG, OIL RESERVOIR	8.00
SC9903	3/8 PIPE PLUG	10.50
SC9904	1/8 BREATHER VENT	46.50
SCA4901	HAND HOLE EXTENSION ASSEMBLY	969.00
SCA9001	BOWL PLUG W / ZERT & O-RING	69.50
SCA9003	BOWL PLUG ASSEMBLY, HIPPED BOWL	83.00
SCA9103	BOWL ASSEMBLY, DOM 10-1/4	1,862.50
SCA9103E	BOWL, DOM 10-1/4 (ADD \$795.50 FOR EXTRUDED)	1,708.00
SCA9108	BOWL ASSEMBLY, YJ ENERGIZER	1,708.00
SCA9208	BOWL ASSEMBLY, WJ ENERGIZER	1,708.00
SCA9301	BOWL ASSEMBLY, AT STANDARD	1,708.00
SCA9301AH	RACE BOWL, A356 T6 ALUMINUM, HIP PROCESS (ADD \$559.50 AFTER DISCOUNT)	1,708.00
SCA9301E	BOWL, AT STANDARD (ADD \$795.50 FOR EXTRUDED)	1,708.00
SCA9301RACE	BOWL ASSEMBLY, 10-1/2 B.C., A356 T6 ALUMINUM, RACE BOWL	1,708.00
SCA9312	STATOR ASSEMBLY, SD-203	1,763.00
SCA9312ind	STATOR ASSEMBLY, SD-203, INDMAR PUMP	1,897.50
SCA9401	BOWL ASSEMBLY, SD-312	1,763.00
SCA9412	STATOR ASSEMBLY, SD-231	1,438.50
(SH) PUMP SHAFT COMPONENTS		
SH1008	PUMP SHAFT, YJ ENERGIZER	1,181.00
SH1107	PUMP SHAFT, 17-4PH, HI-PERF (STANDARD)	1,181.00
SH1108	PUMP SHAFT, WJ ENERGIZER	1,247.00
SH1109	PUMP SHAFT, PANTHER ENGERIZER	1,247.00
SH1207	PUMP SHAFT, SD & FW (17-4PH)	1,247.00
SH1207ind	PUMP SHAFT, INDMAR PUMP	1,287.50
SH1412	PUMP SHAFT, SD231	1,284.50
SH1507	SNAP RING, SHAFT	10.00
SH1608	SNAP RING, MECHANICAL SEAL	20.00
SH1609	RETAINING RING, PUMP SHAFT, SD231	18.50
SH2005	THRUST WASHER	20.00
SH2108	BACK-UP PLATE, LIP SEAL WJ ENERGIZER	120.00
SH2208	YJ SEAL PAC	162.50

AMERICAN TURBINE Item Price List

Item	Description	Price
SH2303	SEAL PACK HOUSING, DOMINATOR 12TD	162.50
SH2308	SEAL PACK, YJ GOLDEN EAGLE	184.50
SH2403	SLINGER RING, EARLY DOM	133.50
SH2507	SLINGER RING	124.00
SH2507RK	SLINGER RING, TYPE 304 SS	156.50
SH2607	SLINGER RING, DOMINATOR MR	118.00
SH3007	IMPELLER KEY	17.00
SH3107	INDUCER SPACER	93.50
SH3207	INDUCER KEY	29.00
SH3507	IMPELLER NUT	47.50
SH3507LN	STEEL IMPELLER LOCK NUT	47.50
SH4007	IMPELLER SHIM .005	11.50
SH4107	IMPELLER SHIM .010	11.50
SH4207	IMPELLER SHIM .020	11.50
SH4307	IMPELLER SHIM .040	11.50
SH4407	IMPELLER SHIM .060	11.50
SH4507	IMPELLER SHIM .075	11.50
SH5000	BEARING SLEEVE, SD231	148.50
SH5001	BEARING SLEEVE, SD203, 309, 312	181.00
SH5001RK	BEARING SLEEVE, SD, TYPE 304 SS	156.50
SH5002	BEARING PRELOAD/ SEAL RING (BERK)	134.50
SH5005	BEARING PRELOAD/ SEAL RING	157.50
SH5009	SHAFT SLEEVE, SD231, OIL	190.50
SH5010	SHAFT SLEEVE WASHER, SD231	63.00
SH5101	NUT, BEARING SLEEVE, SD203, 309, 312	79.00
SH5109	SHAFT SLEEVE, SD231 CUTLASS	190.50
SH5201	SEAL FACE HOUSING, SD203, 309, 312	234.50
SH5301	HP BEARING SLEEVE NUT	236.50
SH5401RK	TAIL BEARING REPAIR SLEEVE, HARD CHROME	245.00
SH5412	SEAL FACE HOUSING, SD231	377.50
SH6412	DRIVE FLANGE, SD231	413.00
SH6413	5/8 MACHINED THICK WASHER	32.50
SH7301	SEAL / CLAMP RING, DOMINATOR MR	225.50
SHA1103	PUMP SHAFT ASSEMBLY, W / B1007 & EARLY SLINGER RING	1,343.00
SHA1107	PUMP SHAFT ASSEMBLY, W / B1007	1,343.00
SHA1201	PUMP SHAFT ASSEMBLY, SD	1,511.50
SHA1207	PUMP SHAFT ASSEMBLY, W / B1007 & SS SLINGER RING	1,362.00
SHA1207ind	PUMP SHAFT ASSEMBLY, INDMAR	1,511.50
SHA1208	PUMP SHAFT ASSEMBLY, YJ ENERGIZER	1,777.50
SHA1307	PUMP SHAFT ASSEMBLY, HP BEARING	1,449.00
SHA1412	SD231 SHAFT ASSEMBLY	2,185.00
SHK4007	SHIM KIT	24.00

AMERICAN TURBINE Item Price List

Item	Description	Price
(SL) SEALS		
SL1001	SEAL, BEARING CAP, HI-PERF (AT, DOM, BERK)	30.50
SL1003	SEAL, (SEALED BRG. ASSY)	43.50
SL1007	SEAL, BEARING CAP (AT, BERK, DOM, SD231)	30.50
SL1101	SEAL, BEARING HOUSING SD203, 309, 312	30.50
SL1107	SEAL, BEARING CAP (BERK JB, WJ)	60.00
SL1201	SEAL, SEAL FACE HOUSING	41.00
SL1507	SEAL, SUCTION (AT, BERK, LATE DOM)	30.50
SL1603	SEAL, SUCTION (DOM EARLY)	30.50
SL1609	SEAL, PANTHER JET SUCTION	54.50
SL2003	SEAL, BOWL (AT, BERK, LATE DOM)	24.50
SL3508	SEAL, YJ ENERGIZER, 12TD SEAL PAC (REPLACED WITH SL3708)	50.50
SL3608	SEAL, WJ BEARING HOUSING (OEM)	68.00
SL3708	SEAL, WJ BEARING HOUSING, YJ ENERGIZER, 12TD SEAL PAC	50.50
SL4008	SEAL, MECHANICAL (SD, YJ & 212 HAMILTON)	122.50
SL9412	SEAL SAVER, STATOR BEARING CARTRIDGE SD231	22.50
(SR) SDR STEERING PARTS		
SR1007	NOZZLE HOUSING, SDR (SD203)	664.50
SR1007ind	NOZZLE HOUSING, SDR (SD203), INDMAR PUMP	664.50
SR1009	SDR, NOZZLE, SD203	664.50
SR1009ind	SDR, NOZZLE, SD203, INDMAR PUMP	664.50
SR2001	SDR, MV CONTROL SHIFT LEVER	48.00
SR2005	SDR, SHIFT CABLE BRACKET	119.00
SR2009	SDR REVERSE CABLE BRACKET, AXIAL FLOW	57.50
SR2019P	REVERSE PIVOT BRACKET, SDR AXIAL FLOW, PORT	80.00
SR2019S	REVERSE PIVOT BRACKET, SDR AXIAL FLOW, STARBOARD	97.50
SR2029	REVERSE PIVOT PIN, SDR AXIAL FLOW	25.00
SR2101	SDR, REVERSE BUCKET	1,105.00
SR2101ind	SDR, REVERSE BUCKET, INDMAR PUMP	1,254.50
SR2201	SPRING, REVERSE BUCKET	46.50
SR2301	S-HOOK FOR SDR SPRING	6.50
SR3001	SDR, TILLER ARM	91.50
SR3009	TILLER ARM, SDR AXIAL FLOW	60.00
SR4001L	SDR BUCKET PIVOT BRACKET (LEFT SIDE)	142.50
SR4001R	SDR BUCKET PIVOT BRACKET (RIGHT SIDE)	142.50
SR5101	BUCKET STOP, SDR REVERSE BUCKET	33.50
SR6001	SDR, OFF-SET STEERING EXTENSION	166.50
SR7400	SD203, NOZZLE INSERT 4.000"	198.50
SR7420	SD203, NOZZLE INSERT 4.200"	204.00
SR7430	SD203, NOZZLE INSERT 4.300"	198.50
SR7440	SD203, NOZZLE INSERT 4.400"	198.50
SRL120G	LEGEND BOWL ADAPTER (NOTE: SMALL END OF BOWL MUST BE DOUBLE DRILLED)	461.50

AMERICAN TURBINE

Item Price List

Item	Description	Price
SRA2001D	STEERING ASSEMBLY, SDR, 3.25 INSERT (MAXIMUM DISCOUNT 25%)	1,213.50
SRA6001	SDR, OFF-SET STEERING EXTENSION ASSEMBLY	230.00
SRK203 280 SDR	SD203 AXIAL FLOW JET UPGRADE, 2.8KW IMP, SDR..GRIND LIP ON SUCTION SEE PHOTO	4,845.50
SRK203 310 SDR	SD203 AXIAL FLOW JET UPGRADE, 3.1 KW IMP, SDR..GRIND LIP ON SUCTION SEE PHOTO	4,845.50
SRK2101C	SDR BUCKET KIT, 3.19 INSERT	1,912.00
SRK2101D	SDR BUCKET KIT, 3.25 INSERT	1,912.00
SRK2101I	SDR BUCKET KIT, 3.70 INSERT	1,912.00
SRK2401C	SDR BUCKET KIT, AT-309, DOM, 3.19 INSERT	2,300.50
SRK2401D	SDR BUCKET KIT, AT-309, DOM, 3.25 INSERT	2,300.50
SRK312 22S SDR	SD312 CONVERSION KIT, STAINLESS 2.6KW IMP, SDR	5,476.50
SRK312 24S SDR	SD312 CONVERSION KIT, STAINLESS 2.9KW IMP, SDR	5,476.50
SRK312 26S SDR	SD312 CONVERSION KIT, STAINLESS 3.3KW IMP, SDR	5,476.50
(T) TRANSOM COMPONENTS		
T1001	TRANSOM HOUSING, DEEP	1,117.00
T1105	TRANSOM HOUSING, 9/18	911.50
T1412	TRANSOM PLATE, SD231	655.00
T1412-4	SET BACK PLATE, SD231	439.50
T1412-4-2	TRANSOM PLATE BRACKET	89.00
T1412-4-R	GASKET, SET BACK PLATE, SD231	136.50
T1412-5	TRANSOM PLATE, SD231 (V 5)	547.50
T1412-5-R	TRANSOM GASKET, SD231 (V.5)..1/12/2020	134.00
T1601	TRANSOM RING, DEEP TA	247.00
T2007	REV. CABLE PACKER, ALUM 1/2 NPT	46.50
T2101	REV. CABLE PACKER, PLASTIC 3/4 NPT STD	29.00
T2201	REV. CABLE PACKER, FW 1/2 NPT	35.50
T2301	REV. CABLE PACKER, HYDRAULIC LINE	30.50
T2401	REV. CABLE PACKER, LOCKING NUT, 3/4 NPT	10.00
T2412	TRANSOM PLATE TRIM SEAL, SD231	63.00
T2601	STEERING TUBE BALL	64.00
T2701	BALL FLANGE	80.00
T3007	STEERING TUBE	113.00
T3501	DRAIN PLUG, BRASS 3/8 NPT	12.00
T3601	PLASTIC PLUG, 3/4 NPT	12.00
T5001	TRANSOM CONTROL BEZEL	151.50
TA2101	REV. CABLE PACKER, PLASTIC 3/4 NPT STD (W / O3001 O-RING)	35.50
TA3107	STEERING TUBE SEAL (W / ZERT & O-RING)	71.50
TA5001	TRANSOM CONTROL BEZEL ASSEMBLY	176.00
TK0310	LEGEND TRANSOM FLANGE ASSEMBLY	922.00
TK1001	TRANSOM HOUSING KIT, DEEP	1,590.00
TK1105	TRANSOM HOUSING KIT, 9/18	920.00
TK2407	DETMAR KIT, BILLET ALUMINUM, (LESS EXT. & CLEVIS ASSY.) (MAX. 25% DISCOUNT)	173.50
TK2507	DETMAR KIT, BILLET ALUMINUM (LESS EXT. AT) (MAX. 25% DISCOUNT)	220.00

AMERICAN TURBINE Item Price List

Item	Description	Price
TK2607	SDR INSTALL KIT, DETMAR STYLE, BILLET ALUMINUM (MAX. 25% DISCOUNT)	197.50
TK2707	SDR INSTALL KIT, W / T5001 TEAR DROP TRANSOM BEZEL (MAX. 25% DISCOUNT)	236.00
TK2807	SDR INSTALL KIT, W / RS5001 ROUND TRANSOM BEZEL (MAX. 25% DISCOUNT)	236.00
TK5001	STEERING KIT, SD & SET BACK PUMP (MAX. 25% DISCOUNT)	310.50
TK5002	STEERING KIT, SD & SET BACK PUMP W / RS5001 TRANSOM BEZEL(MAX. 25% DISCOUNT)	298.50
(WR) WEAR RINGS & LINERS		
WR203SS	WEAR RING, SD203AF, STAINLESS STEEL	750.00
WR203ST	SD203AF TAPERED WEAR PLATE	981.00
WR309	WEAR RING AXIAL FLOW 309	1,052.50
WR412	WEAR RING, SD231	2,119.50
WR5000	WEAR RING, SIZE STANDARD (AT, BK, DL)	450.50
WR5000FF	STANDARD WEAR RING, FILE FIT	516.50
WR5000SN	WEAR RING, STAINLESS NON-SHOULDERED, SIZE STANDARD	308.00
WR5000SS	WEAR RING, STAINLESS SHOULDERED, SIZE STANDARD	345.00
WR5005FF	WEAR RING, SIZE -.005, FILE FIT (AT, BK, DL)	516.50
WR5015	WEAR RING, SIZE -.015 (AT, BK, DL)	450.50
WR5015OE	WEAR RING, SIZE -.015 (DLOE)	450.50
WR5025	WEAR RING, SIZE -.025 (AT, BK, DL)	450.50
WR5025OE	WEAR RING, SIZE -.025 (DLOE)	450.50
WR5050	WEAR RING, SIZE -.050 (AT, BK, DL)	450.50
WR5100	WEAR RING, SIZE STANDARD, SD-312	686.00
WR5100SS	WEAR RING, SIZE STANDARD, STAINLESS STEEL, SD-312	367.50
WR5800	WEAR RING, SIZE STANDARD (YJ, DE)	450.50
WR5815	WEAR RING, SIZE -.015 (YJ, DE)	450.50
WR5815OE	WEAR RING, SIZE -.015 (DEOE)	450.50
WR5825	WEAR RING, SIZE -.025 (YJ, DE)	450.50
WR5825OE	WEAR RING, SIZE -.025 (DEOE)	450.50
WR5850	WEAR RING, SIZE -.050 (YJ, DE)	450.50
WR5850OE	WEAR RING, SIZE -.050 (DEOE)	450.50
WR5900	WEAR RING, SIZE STANDARD (WJ)	555.50
WR6004	WEAR RING INSULATOR (STANDARD)	20.50
WR6005	WEAR RING INSULATOR (SD203, 312)	20.50
WR6009	WEAR RING INSULATOR, WJ ENERGIZER	20.50