

**THE POWER IS IN THE PUMP!**

# AMERICAN TURBINE

## 2019 RETAIL PRICE LIST



WE HAVE REPLACEMENT PARTS FOR:  
AMERICAN TURBINE, DOMINATOR  
AGGRESSOR, LEGEND,  
BERKELEY, HAMILTON  
JACUZZI ENERGIZER, PANTHER ENERGIZER



SD-309 W / HTR II

IMPELLERS: ALUMINUM & STAINLESS

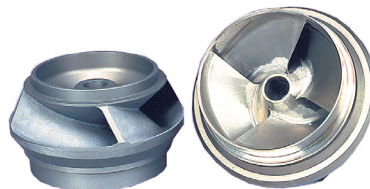

DROOP SNOOT



JACUZZI YJ, WY & PANTHER  
ENERGIZER KITS

HYDRAULIC TURBINE TRIM

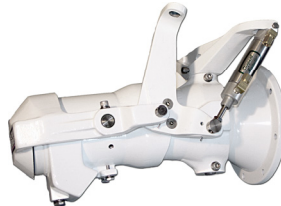

OVERHAUL KITS

AMERICAN TURBINE

3692 RIVERSIDE DR.

CLARKSTON, WA 99403

PHONE: (509) 243-5387

FAX: (509) 243-5391

INTERNET: [WWW.AMERICANTURBINE.COM](http://WWW.AMERICANTURBINE.COM)

ALL PRICES F.O.B. ASOTIN, WA. AND SUBJECT TO CHANGE WITHOUT NOTICE  
PRICES EFFECTIVE MARCH 15, 2019

# RETAIL JETDRIVE PACKAGE PRICE SHEET

PUMP PACKAGE (INCLUDES INTAKE, INSTALL KIT, AND STANDARD STEERING)

DEALERS NOTE: Standard discounts do not apply.

MODEL	DESCRIPTION	LIST
AT-309	AT Jetdrive Package w / Standard Steering	\$4,899.00
12-S	Dominator Jetdrive Package w / Standard Steering	\$4,921.00
SD-309	Super Duty Jetdrive Package w / Standard Steering	\$5,177.00
SD-312	Super Duty Jetdrive Package w / SS Imp & Standard Steering	\$5,953.00
TJ-309 / 12TD	Transom Jetdrive Package w / Standard Steering	\$4,321.00
SD-312FG	Fiberglass Jetdrive Package w / SS Imp & Jet Trim Kit	\$7,135.00
J120-AT	Legend Jet Drive Package w / Standard Steering	\$4,733.00
<b>AXIAL FLOW JETDRIVES COME STANDARD WITH SDR STEERING &amp; STAINLESS STEEL IMPELLER</b>		
SD203	Axial Flow SD Jetdrive Package (203 mm Blade)	\$5,121.00
SD231	Axial Flow SD Jetdrive Package (231 mm Blade) Hyd. Reverse	\$13,080.00

## TRANSOM KITS (MAX DISCOUNT IS 25%)

TK0310	Legend Set-Back Plate	\$541.00
TK1105	Transom Housing Kit (berkeley style 9/18 deg.)	\$592.00
TK5001	SD Installation Kit	\$189.00

## ADD ON OPTIONS (ADD TO DRIVE LIST PRICE) - MAX DISCOUNT ON OPTIONS IS 25%

IK1602	Hydraulic Rideplate kit for SD-231	\$1,279.00
HP INTAKE	HP INTAKE UPGRADE	\$358.00
IM1000	INDUCER IMPELLER (NO DISCOUNT)	\$492.00
HIPPED SUCTION	HIPPED PROCESS FOR SUCTION	\$1,320.00
HIPPED BOWL	HIPPED PROCESS FOR BOWL	\$399.00
EXTRUDE	EXTRUDED CHARGE FOR BOWL	\$567.00
IMA**H	Hi-Helix Stainless Steel Impeller	\$1,061.00
IMA**S	Stainless Steel Impeller	\$869.00
R6301	Hi-Flow Droop Snoot	\$186.00
R6007	Droop Snoot	\$186.00
R6201	Long Straight Snoot	\$271.00
BNA1407	Best Steering Upgrade	\$262.00
SRK2101	SDR Steering Upgrade	\$903.00
RSK2101	HTR II Steering Upgrade	\$1,099.00
RA8507	Turbine Trim w/o Hydraulic Kit	\$767.00
RA8707	Turbine Trim w / Hydraulic Kit	\$1,444.00
JTA8507	Jet Trim w/o Hydraulic Kit	\$844.00
JTA8607	Jet Trim w / Hydraulic Kit	\$1,534.00

## CREDITS (NET)

INTAKE	SD-309, 12-S, AT-309, J120 INTAKE CREDIT	\$300.00
SD-312 INTAKE	SD-312 INTAKE CREDIT	\$350.00
TK5001	INSTALL KIT CREDIT	\$30.00
NOZZLE	STANDARD NOZZLE CREDIT	\$45.00
STEERING	STANDARD STEERING CREDIT	\$65.00

## American Turbine 2019 Item Price List

Item	Description	Price
<b>(B) BEARINGS &amp; BUSHINGS</b>		
B1001	THRUST BEARING (SD-231, HAM213, HAM241)	249.00
B1007	THRUST BEARING (BERK, AT & DOM)	119.00
B1101	THRUST BEARING (SD & FW)	195.00
B1103	THRUST BEARING (12TD,12YJ)	173.00
B1107	THRUST BEARING, HI-PERF.	195.00
B1502	BOWL BEARING, GREASE LUBE 3/4	23.50
B1505	BOWL BEARING, WATER LUBE 1" (EARLY AT,DOM)	23.50
B1506	STATOR BEARING, SD231	39.00
B1603	BOWL BEARING, WATER LUBE SLEEVE	75.00
B1903	BOWL BEARING, GREASE LUBE SLEEVE	119.00
B2007	NYLINER BUSHING, SPLIT (3/4) (WJ STR, HVR)	6.00
B2101	NYLINER BUSHING, SPLIT (1/2 LONG)	7.00
B2102	NYLINER BUSHING, SPLIT (BERK REV. & JET TRIM)	11.00
B2105	NYLINER BUSHING, SPLIT (3/8)	6.00
B2201	BRASS BEARING (3/4)	17.00
B2301	NYLON BEARING (5/8)	17.00
B2401	NYLON BEARING (3/4)	25.00
B2501	NYLINER BUSHING, 1/2 X 1/2 (SDR BUCKET)	6.00
B4000	PLAIN BEARING (3/4)	16.50
B4134	STATOR BEARING CARTRIDGE, SD231	495.00
BA1201	THRUST BEARING ASSEMBLY, SD	259.00
BA1703	BOWL BEARING ASSEMBLY, WATER LUBE	119.00
BA1803	BOWL BEARING ASSEMBLY, GREASE LUBE	219.00
BA4134	BEARING CARTRIDGE ASSEMBLY, SD231	495.00
BK1001	3-STAGE, MP901 BEARING KIT	285.00
BK1201	THRUST BEARING KIT, SD	330.00
BK1201HD	HD THURST BEARING KIT, SD, W / SS SLEEVE & HD NUT	475.00
BK1412	SD-231 THRUST BEARING KIT	375.00
<b>(BN) BEST NOZZLE COMPONENTS</b>		
BN1710	BEST, NOZZLE DEFLECTOR	113.50
BN1810	BEST, BUCKET LEVER	50.00
BN1910	BEST, CABLE PIVOT (MORSE)	60.00
BN2010	BEST, NOZZLE, PLASTIC BUSHING	10.50
BN2110	BEST, NOZZLE, RIGHT SIDE BOLTS	26.00
BN2210	PIVOT BOLT, (BEST PORT SIDE)	26.00
BN2410	BEST, BERK, DOM, UPPER STEERING PIN	50.00
BN2510	BEST, BERK, DOM, LOWER STEERING PIN	39.50
BNA1307A	STEERING ASSEMBLY, BEST, LESS R1007, 3.00 INSERT (MAXIMUM DISCOUNT 25%)	1,015.00
BNA1307C	STEERING ASSEMBLY, BEST, LESS R1007, 3.19 INSERT (MAXIMUM DISCOUNT 25%)	1,015.00
BNA1307D	STEERING ASSEMBLY, BEST, LESS R1007, 3.25 INSERT (MAXIMUM DISCOUNT 25%)	1,015.00
BNA1307G	STEERING ASSEMBLY, BEST, LESS R1007, 3.50 INSERT (MAXIMUM DISCOUNT 25%)	1,015.00
BNA1307H	STEERING ASSEMBLY, BEST, LESS R1007, 3.60 INSERT (MAXIMUM DISCOUNT 25%)	1,015.00

## American Turbine 2019 Item Price List

Item	Description	Price
BNA1307I	STEERING ASSEMBLY, BEST, LESS R1007, 3.70 INSERT (MAXIMUM DISCOUNT 25%)	1,015.00
BNA1307J	STEERING ASSEMBLY, BEST, LESS R1007, 3.80 INSERT (MAXIMUM DISCOUNT 25%)	1,015.00
BNA1407C	STEERING ASSEMBLY, BEST, 3.19 INSERT (MAXIMUM DISCOUNT 25%)	1,169.00
BNA1407D	STEERING ASSEMBLY, BEST, 3.25 INSERT (MAXIMUM DISCOUNT 25%)	1,169.00
BNA1407I	STEERING ASSEMBLY, BEST, 3.70 INSERT (MAXIMUM DISCOUNT 25%)	1,169.00
BNA1511	BEST, NOZZLE W / DEFLECTOR, LARGE INSERT BORE	558.50
BNA1610	BEST, REVERSE BUCKET W / LEVER	365.00
BNA1911	BEST, 1/4 STAINLESS ROD END ASSEMBLY	58.00
<b>(C ) CABLES &amp; SHIFTERS (CALL FOR DEALER PRICING)</b>		
044716-001	MJB DUAL SHIFTER CONTROL (NO DISCOUNT)	586.00
311510	HARDWARE KIT, MV-3 CONTROL (NO DISCOUNT)	20.50
A7100/07	33C CABLE X 7 FEET	75.00
A7100/09	33C CABLE X 9 FEET	75.00
A7100/10	33C CABLE X 10 FEET	75.00
A7100/11	33C CABLE X 11 FEET	75.00
A7100/12	33C CABLE X 12 FEET	75.00
A7100/13	33C CABLE X 13 FEET	75.00
A7100/14	33C CABLE X 14 FEET	75.00
A7100/15	33C CABLE X 15 FEET	75.00
A7100/16	33C CABLE X 16 FEET	75.00
A7100/18	33C CABLE X 18 FEET	75.00
A7100/20	33C CABLE X 20 FEET	75.00
A7100/21	33C CABLE X 21 FEET	75.00
A7100/22	33C CABLE X 22 FEET	75.00
A7100/23	33C CABLE X 23 FEET	75.00
A7100/24	33C CABLE X 24 FEET	75.00
A7100/28	33C CABLE X 28 FEET	75.00
A7200/19	43C CABLE X 19 FEET	148.50
A7200/20	43C CABLE X 20 FEET	148.50
A7200/21	43C CABLE X 21 FEET	148.50
A7200/22	43C CABLE X 22 FEET	148.50
A7200/23	43C CABLE X 23 FEET	148.50
A7200/24	43C CABLE X 24 FEET	148.50
A7200/25	43C CABLE X 25 FEET	148.50
A7200/26	43C CABLE X 26 FEET	148.50
A7200/27	43C CABLE X 27 FEET	148.50
A7200/28	43C CABLE X 28 FEET	148.50
A7200/29	43C CABLE X 29 FEET	148.50
A7210/08	43BC CABLE X 8 FEET	148.50
A7210/09	43BC CABLE X 9 FEET	148.50
A7210/10	43BC CABLE X 10 FEET	148.50
A7210/11	43BC CABLE X 11 FEET	148.50
A7210/12	43BC CABLE X 12 FEET	148.50
A7210/13	43BC CABLE X 13 FEET	148.50

# American Turbine 2019 Item Price List

Item	Description	Price
A7210/14	43BC CABLE X 14 FEET	148.50
A7210/15	43BC CABLE X 15 FEET	148.50
A7210/16	43BC CABLE X 16 FEET	148.50
A7210/17	43BC CABLE X 17 FEET	148.50
A7210/18	43BC CABLE X 18 FEET	148.50
A7210/19	43BC CABLE X 19 FEET	148.50
A7210/20	43BC CABLE X 20 FEET	148.50
A7210/21	43BC CABLE X 21 FEET	148.50
A7210/22	43BC CABLE X 22 FEET	148.50
A7210/23	43BC CABLE X 23 FEET	148.50
A7210/24	43BC CABLE X 24 FEET	148.50
A7300/17	64C CABLE X 17 FEET	264.00
A7300/18	64C CABLE X 18 FEET	264.00
A7300/19	64C CABLE X 19 FEET	264.00
A7300/20	64C CABLE X 20 FEET	264.00
A7300/21	64C CABLE X 21 FEET	264.00
A7300/22	64C CABLE X 22 FEET	264.00
A7300/23	64C CABLE X 23 FEET	264.00
A7300/24	64C CABLE X 24 FEET	264.00
A7300/25	64C CABLE X 25 FEET	264.00
A7300/30	64C CABLE X 30 FEET	264.00
CH2945P	MV-3 LEFT MOUNT BERKELEY (NO DISCOUNT)	458.00
CH2950P	ASM-MV 3 HD CONTROL (SDR) - NO DISCOUNT (\$295 W / SDR KIT)	463.00
CMC-30	33C CABLE CLAMP	5.50
CMC-40	40 SERIES CABLE CLAMP	5.50
CMC-60	64C CABLE CLAMP	6.50
<b>(D) DRIVELINE PARTS</b>		
2-4-1731	END YOKE (NO DISCOUNT)	106.50
2-94-28X	U BOLT KIT (NO DISCOUNT)	17.00
312731-001	STANDARD DRIVELINE (FITS KODIAK & MARINE POWER) (NO DISC)	336.50
5-153X	U JOINT KIT (NO DISCOUNT)	45.00
SC37-1	DRIVELINE 37 SERIES, SD231 (NO DISC)	269.50
SC41-1	1410 SERIES SC SHAFT ASSEMBLY (NO DISCOUNT)	419.00
<b>(F) FASTENERS</b>		
F01 06 CP	5/64 X 3/4 COTTER PIN	1.50
F02 04 CP	7/64 X 3/4 COTTER PIN	1.50
F02 06 CP	1/8 X 3/4 COTTER PIN	3.00
F02 10 CP	1/8 X 1-1/4 COTTER PIN	3.00
F02 64 03 SH	#2-64 X 3/8 SOCKET HEAD CAP SCREW	1.50
F03 16 CP	5/32 X 2 COTTER PIN	1.50
F03 32 03 SH	10-32 X 3/8 SOCKET HEAD CAP SCREW	1.50
F03 32 03 SS	10-32 X 3/8 SET SCREW	3.00
F03 32 06 SH	10-32 X 3/4 SOCKET HEAD CAP SCREW	1.00

## American Turbine 2019 Item Price List

Item	Description	Price
F03 32 10 SH	10-32 X 1-1/4 SOCKET HEAD CAP SCREW	1.00
F03 LW	#10 LOCK WASHER, STAINLESS	0.50
F04 08 WS	#14 X 1 WOOD SCREW	1.50
F04 20 03 PH	1/4-20 X 3/8 PAN HEAD PHILLIPS SCREW	1.50
F04 20 06 HH	1/4-20 X 3/4 HEX HEAD CAP SCREW	1.50
F04 20 06 SH	1/4-20 X 3/4 SOCKET HEAD CAP SCREW	3.00
F04 20 07 SH	1/4-20 X 7/8 SOCKET HEAD CAP SCREW	3.00
F04 20 08 FH	1/4-20 X 1 FLAT HEAD MACHINE SCREW	1.50
F04 20 08 HH	1/4-20 X 1 HEX HEAD CAP SCREW	3.00
F04 20 10 SH	1/4-20 X 1-1/4 SOCKET HEAD CAP SCREW	3.00
F04 20 11 SH	1/4-20 X 1-3/8 SOCKET HEAD CAP SCREW	4.00
F04 20 12 FH	1/4-20 X 1-1/2 FLAT HEAD MACHINE SCREW	3.00
F04 20 16 FH	1/4-20 X 2 FLAT HEAD MACHINE SCREW	3.00
F04 20 20 FH	1/4-20 X 2-1/2 FLAT HEAD MACHINE SCREW	4.00
F04 20 HN	1/4-20 HEX NUT	1.50
F04 20 LN	1/4-20 LOCK NUT	3.00
F04 28 FRE	1/4-28 STAINLESS FEMALE ROD END (BEST, JET TRIM)	38.48
F04 AN	1/4 AN FLAT WASHER	1.25
F04 BI	1/4 BOLT INSULATOR	1.50
F04 CL	1/4 CLEVIS PIN	4.00
F04 FW	1/4 FLAT WASHER	1.50
F04 LW	1/4 LOCK WASHER	1.50
F04 NW	1/4 NEOBOND WASHER	3.00
F05 03 BI	BOLT INSULATOR, 5/16, SD231	1.50
F05 04 SB	5/16 X 1/2 SHOULDER BOLT	2.50
F05 18 02 SS	5/16-18 X 1/4 SET SCREW	4.00
F05 18 04 SH	5/16-18 X 1/2 SOCKET HEAD CAP SCREW	4.00
F05 18 06 BH	5/16-18 X 3/4 BUTTON SOCKET HEAD	3.00
F05 18 06 FH	5/16-18 X 3/4 FLAT HEAD SOCKET SCREW	4.00
F05 18 06 HH	5/16-18 X 3/4 HEX HEAD CAP SCREW	3.00
F05 18 06 SH	5/16-18 X 3/4 SOCKET HEAD CAP SCREW	4.00
F05 18 06 SQ	5/16-18 X 3/4 SQUARE HEAD SET SCREW	6.50
F05 18 06 SS	5/16-18 X 3/4 SET SCREW	4.00
F05 18 08 FH	5/16-18 X 1 FLAT HEAD SOCKET SCREW	4.00
F05 18 08 HH	5/16-18 X 1 HEX HEAD CAP SCREW	3.00
F05 18 08 SH	5/16-18 X 1 SOCKET HEAD CAP SCREW	4.00
F05 18 10 FH	5/16-18 X 1-1/4 FLAT HEAD SOCKET SCREW	4.00
F05 18 10 HH	5/16-18 X 1-1/4 HEX HEAD CAP SCREW	3.00
F05 18 10 SH	5/16-18 X 1-1/4 SOCKET HEAD CAP SCREW	4.00
F05 18 12 BH	5/16-18 X 1-1/2 BUTTON SOCKET HEAD	4.00
F05 18 12 FH	5/16-18 X 1-1/2 FLAT HEAD MACHINE SCREW	4.00
F05 18 12 HH	5/16-18 X 1-1/2 HEX HEAD CAP SCREW	4.00
F05 18 12 SS	5/16-18 X 1-1/2 SET SCREW	6.50
F05 18 14 HH	5/16-18 X 1-3/4 HEX HEAD CAP SCREW	3.00
F05 18 14 SS	5/16-18 X 1-3/4 SET SCREW	6.50

## American Turbine 2019 Item Price List

Item	Description	Price
F05 18 16 CB	5/16-18 X 2 CARRIAGE BOLT	4.00
F05 18 16 FH	5/16-18 X 2 FLAT HEAD MACHINE SCREW	4.00
F05 18 16 HH	5/16-18 X 2 HEX HEAD CAP SCREW	3.00
F05 18 16 SH	5/16-18 X 2 SOCKET HEAD CAP SCREW	2.50
F05 18 16 SS G8	5/16-18 X 2 SOCKET HEAD SET SCREW, GRADE 8	3.00
F05 18 18 HH	5/16-18 X 2-1/4 HEX HEAD CAP SCREW	3.00
F05 18 18 SH	5/16-18 X 2-1/4 SOCKET HEAD CAP SCREW	4.00
F05 18 20 HH	5/16-18 X 2-1/2 HEX HEAD CAP SCREW	3.00
F05 18 22 HH	5/16-18 X 2-3/4 HEX HEAD CAP SCREW	3.00
F05 18 22 SH	5/16-18 X 2-3/4 SOCKET HEAD CAP SCREW	3.00
F05 18 24 FH	5/16-18 X 3 FLAT HEAD MACHINE SCREW	3.00
F05 18 32 HH	5/16-18 X 4 HEX HEAD CAP SCREW	3.00
F05 18 36 HH	5/16-18 X 4-1/2 HEX HEAD CAP SCREW	4.00
F05 18 HN	5/16-18 HEX NUT	1.50
F05 18 HN G8	5/16-18 HEX NUT, GRADE 8	2.00
F05 18 LN	5/16-18 LOCK NUT	3.00
F05 18 WN	5/16-18 WING NUT	3.50
F05 24 JN	5/16-24 JAMB NUT	1.50
F05 24 MRE	5/16-24 MALE ROD END	39.00
F05 AN	5/16 AN FLAT WASHER	1.50
F05 BI	5/16 BOLT INSULATOR	1.50
F05 CL	5/16 CLEVIS PIN	6.00
F05 FW	5/16 FLAT WASHER	1.50
F05 LW	5/16 LOCK WASHER	1.50
F05 LW G8	5/16 LOCK WASHER, GRADE 8	1.50
F05 NW	5/16 NEOBOND WASHER	1.50
F05 RW	5/16 RUBBER WASHER	1.50
F05 SW	5/16 STAR LOCK WASHER	1.50
F05 TW	5/16 THICK WASHER (HTR II)	3.00
F06 03 SB	3/8 X 3/8 SHOULDER BOLT	3.00
F06 08 CL	3/8 X 1-1/16 CLEVIS PIN, STAINLESS STEEL	7.50
F06 13 CL	3/8 X 2-1/4 CLEVIS PIN	8.00
F06 16 03 SH	3/8-16 X 3/8 SOCKET HEAD CAP SCREW	3.00
F06 16 06 HH	3/8-16 X 3/4 HEX HEAD CAP SCREW	3.00
F06 16 08 FH	3/8-16 X 1 FLAT HEAD SOCKET SCREW	4.00
F06 16 08 HH	3/8-16 X 1 HEX HEAD CAP SCREW	2.50
F06 16 10 HH	3/8-16 X 1-1/4 HEX HEAD CAP SCREW	4.00
F06 16 12 FH	3/8-16 X 1-1/2 FLAT HEAD CAP SCREW	3.00
F06 16 12 HH	3/8-16 X 1-1/2 HEX HEAD CAP SCREW	4.00
F06 16 12 SH	3/8-16 X 1-1/2 SOCKET HEAD CAP SCREW	3.00
F06 16 14 SS	3/8-16 X 1-3/4 SOCKET HEAD SET SCREW	3.00
F06 16 16 HH	3/8-16 X 2 HEX HEAD CAP SCREW	4.00
F06 16 16 SS	3/8-16 X 2 SET SCREW	5.50
F06 16 20 SH	3/8-16 X 2-1/2 SOCKET HEAD CAP SCREW	3.00
F06 16 20 SS	3/8-16 X 2-1/2 SET SCREW	6.50

# American Turbine 2019 Item Price List

Item	Description	Price
F06 16 22 HH	3/8-16 X 2-3/4 HEX HEAD CAP SCREW	3.00
F06 16 24 SH	3/8-16 X 3 SOCKET HEAD CAP SCREW	2.00
F06 16 28 HH	3/8-16 X 3-1/2 HEX HEAD CAP SCREW	4.00
F06 16 EB	3/8 EYE BOLT	26.00
F06 16 HN	3/8-16 HEX NUT	1.50
F06 16 LN	3/8-16 LOCK NUT	3.00
F06 16 WN	3/8 WING NUT	6.50
F06 24 08 HH	3/8-24 X 1 HEX HEAD CAP SCREW	4.00
F06 24 10 HH	3/8-24 X 1-1/4 HEX HEAD CAP SCREW	4.00
F06 24 12 HH	3/8-24 X 1-1/2 HEX HEAD CAP SCREW	4.00
F06 24 14 HH	3/8-24 X 1-3/4 HEX HEAD CAP SCREW	4.00
F06 24 16 HH	3/8-24 X 2 HEX HEAD CAP SCREW	4.00
F06 24 16 SH	3/8-24 X 2 SOCKET HEAD CAP SCREW	4.00
F06 24 18 HH	3/8-24 X 2-1/4 HEX HEAD CAP SCREW	5.50
F06 24 18 SH	3/8-24 X 2-1/4 SOCKET HEAD CAP SCREW	4.00
F06 24 FRE	3/8-24 FEMALE ROD END, STAINLESS STEEL	35.00
F06 24 HN	3/8-24 HEX NUT	3.00
F06 24 JN	3/8-24 JAMB NUT	1.50
F06 24 LN	3/8-24 LOCK NUT	3.00
F06 24 MRE	3/8-24 MALE ROD END	56.50
F06 24 TL	3/8-24 THIN LOCK NUT	1.50
F06 AN	3/8 AN FLAT WASHER	1.50
F06 BI	3/8 BOLT INSULATOR	5.00
F06 FW	3/8 FLAT WASHER	3.00
F06 LW	3/8 LOCK WASHER	1.50
F06 SW	3/8 STAR LOCK WASHER	3.00
F06 TW	3/8 THICK WASHER (SD HAND HOLE COVER)	3.00
F07 TW	YOKE RETAINING WASHER, DOMINATOR MR	32.50
F08 10 RC	"R" CLIP, SHIFT SHAFT, SD231	2.00
F08 13 10 HH	1/2-13 X 1-1/4 HEX HEAD CAP SCREW	2.00
F08 13 12 HH	1/2-13 X 1-1/2 HEX HEAD CAP SCREW	4.00
F08 13 14 HH	1/2-13 X 1-3/4 HEX HEAD CAP SCREW	3.00
F08 13 16 HH	1/2-13 X 2 HEX HEAD CAP SCREW	3.00
F08 13 16 SS	1/2-13 X 2 SOCKET HEAD SET SCREW	5.50
F08 13 18 SS	1/2-13 X 2-1/4 SOCKET HEAD SET SCREW	3.00
F08 13 26 SS	1/2-13 X 2-1/4 SOCKET HEAD SET SCREW	6.50
F08 13 HN	1/2-13 HEX NUT	2.00
F08 13 LN	1/2-13 LOCK NUT	1.50
F08 20 14 SH	1/2-20 X 1-3/4 SOCKET HEAD CAP SCREW	5.00
F08 20 FRE	1/2-20 FEMALE ROD END	39.00
F08 20 HN	1/2-20 HEX NUT	1.00
F08 20 JN	1/2-20 JAMB NUT	3.50
F08 AN	1/2 AN FLAT WASHER	1.50
F08 LW	1/2 LOCK WASHER	1.50
F10 11 14 HH	5/8-11 X 1-3/4 HEX HEAD CAP SCREW	8.00



## American Turbine 2019 Item Price List

Item	Description	Price
F10 11 16 HH	5/8-11 X 2 HEX HEAD CAP SCREW	8.00
F10 18 06 SS	5/8-18 X 3/4 SLOTTED SET SCREW	4.00
F10 18 14 HH	5/8-18 X 1-3/4 HEX HEAD CAP SCREW	5.00
F10 18 24 SS	5/8-18 X 3 SOCKET HEAD SET SCREW	13.00
F10 18 FLN	5/8-18 FLANGED NUT, SERRATED	1.50
F10 18 JN	5/8-18 JAMB NUT	3.00
F10 SW	5/8 STAR LOCK WASHER	3.00
F10 TW	5/8 THICK WASHER	3.00
F11 TW	THICK WASHER, T2007 CABLE PACKER	6.50
F12 16 FN	3 STAGE IMPELLER NUT	48.00
F12 16 JN	3/4-16 JAMB NUT	3.00
F14 14 JN	7/8-14 JAMB NUT	4.00
FK0231	SD-231 FASTENERS	184.00
FK1001	FASTENER KIT, AT DEEP TRANSOM	19.50
FK1003	FASTENER KIT, INTAKE, I-1003	39.00
FK1003HP	FASTENER KIT, INTAKE, I-1003HP	44.50
FK1007	FASTENER KIT, INTAKE, I-1007 & I-1507	39.00
FK1007HP	FASTENER KIT, INTAKE, I-1007HP	44.50
FK1101	FASTENER KIT, ALUMAWELD DEEP TRANSOM	19.50
FK1105	FASTENER KIT, 9/18 TRANSOM	16.00
FK12TD	FASTENER KIT, DOM 12TD JET UNIT	19.50
FK2208	FASTENER KIT, YJ JACUZZI ENERGIZER	38.00
FK3301	FASTENER KIT, TRANSOM, SD-309 & SD-312	16.00
FK3401	FASTENER KIT, I-1307 & I-1401 INTAKE	8.50
FK3407	FASTENER KIT, 2 DEGREE WEDGE	13.50
FK3408	FASTENER KIT, 2 DEGREE WEDGE W / SDR STEERING	13.50
FK3501	FASTENER KIT, INTAKE, I-1407	31.00
FK3507	FASTENER KIT, 3 DEGREE WEDGE	15.00
FK3601	FASTENER KIT, TRANSOM, SD-312FG	18.00
FK3607	FASTENER KIT, 4 DEGREE WEDGE	15.00
FK3608	FASTENER KIT, 4 DEGREE WEDGE W / SDR STEERING	15.00
FK3700	FASTENER KIT, SHOE & RIDEPLATE	10.00

### (G) GASKETS

G1001	GASKET, INTAKE (AT)	27.00
G1006	GASKET, INTAKE (BERK & DOM)	23.00
G1008	GASKET, INTAKE (JACUZZI YJ)	23.00
G1101	GASKET, INTAKE, RUBBER (AT)	29.50
G1108	GASKET, INTAKE (JACUZZI WJ)	25.00
G1502	GASKET, BEARING CAP, BERKELEY 1/64 THK	6.50
G1502D	GASKET, BEARING CAP, BERKELEY 1/64 THK (DOUBLE DRILLED)	6.50
G1507	GASKET, BEARING CAP, DOM & AT, 1/32 THK	6.50
G1507D	GASKET, BEARING CAP, DOM & AT, 1/32 THK (DOUBLE DRILLED)	6.50
G2001	GASKET, BOWL, AT (EARLY)	12.00
G2006	GASKET, BOWL, BERK & DOM	12.00

## American Turbine 2019 Item Price List

Item	Description	Price
G2008	GASKET, BOWL, JACUZZI YJ	12.00
G2106	GASKET, BOWL, BERK (16 HOLE)	12.00
G2507	GASKET, NOZZLE HOUSING	8.00
G2507D	GASKET, NOZZLE HOUSING, 16 HOLES	8.00
G3001	GASKET, TRANSOM, 9/18, AT	29.00
G3006	GASKET, TRANSOM, 9/18, BERK & DOM	39.00
G3101	GASKET, SD-309 TRANSOM FLANGE ISOLATOR	16.00
G3201	GASKET, SD-312 TRANSOM FLANGE ISOLATOR	16.00
G3301	GASKET, INTAKE, SD203/312, ISOLATOR	20.50
G3501	GASKET, TRANSOM, AT, 1/8 CORK	64.00
G3601	GASKET, TRANSOM, AT, 3/16 CORK	73.00
G4001	GASKET 1/64" THK, STEERING MOUNT ASSEMBLY	5.00
G4101	GASKET 1/32" THK., SHIFT SHAFT MOUNT ASSEMBLY	4.00
G4508	GASKET, JACUZZI ENERGIZER SUC PIECE ADAPTOR	17.00
G5001	GASKET, INTAKE, RUBBER	175.00
<b>(HAM) HAMILTONS 212 PARTS (MFG. BY AMERICAN TURBINE)</b>		
H064726	O-RING, HAMILTON 212, WATER OFFTAKE	7.00
H106011	CUTLASS BEARING, MARINE BEARING	375.00
H107528	HAMILTON, MAINSHAFT (PUMPSHAFT)	785.00
H107529	BEARING CARRIER	55.00
H107532	HAMILTON, BEARING RETAINING NUT	130.00
H107567	WATER BEARING SLEEVE	375.00
H107612	SEAL SLEEVE	140.00
H110202	HAMILTON 212, BEARING HOUSING BILLET	510.00
H110343	IMPELLER / COUPLING KEY	45.00
H111718	SEAL FACE HOLDER	245.00
H200985	O-RING, HAMILTON 212, HAND HOLE COVER	13.50
H200999	O-RING, HAMILTON 212, STATOR	22.00
H201244	SOCKET SET SCREW SS, BEARING RETAINER NUT	4.00
H203395	IMPELLER-COUPLING NUT	94.50
H61458	SEAL, HAMILTON 212, BEARING	39.00
H61464	O-RING, HAMILTON 212, SEAL FACE HOUSING	13.50
H63975	THRUST BEARING (HAMILTON 212)	245.00
HA103170	PIN, COTTER (RS3501 [ MUST USE AT NUT ] )	60.00
HA107528	HAMILTON 212 SHAFT ASSEMBLY	1,999.50
HK63975	HAMILTON 212 BEARING KIT	575.00
<b>(HPK) HIGH PERFORMANCE BEARING KITS</b>		
HPK1902	HIGH PERFORMANCE BEARING KIT (STANDARD OEM BERKELEY)	529.50
HPK1903	HIGH PERFORMANCE BEARING KIT (EARLY DOMINATOR)	529.50
HPK1905	HIGH PERFORMANCE BEARING KIT (AT309, LATE 12S, LATE 12TD, OEM BERKELEY AQ SHAFT)	529.50
<b>(I) INTAKES &amp; COMPONENTS</b>		
I1601	INTAKE BLOCK, SD231	1,007.50

## American Turbine 2019 Item Price List

Item	Description	Price
I1602	RIDE PLATE, SD231	440.50
I1603	RIDE PLATE CYLINDER, SD231	182.00
I2780	OEM BERKELEY R INTAKE	1,552.50
I4007	GRATE, SPEED, I-1003 & I-1007	195.00
I4108	GRATE, ROCK, AFTER 7/97 FOR I-1307	325.00
I4201	GRATE, ROCK, AXIAL FLOW, TJ309	325.00
I4207	GRATE, SPEED, TJ	319.00
I4307	GRATE, BACK-UP, TJ	99.50
I4401	GRATE, INTAKE, SD203, 312	506.00
I4501	SPEED GRATE, SD-312FG	384.50
I4601	INTAKE GRATE, SD231	1,916.50
I4601-2	INTAKE GRATE BAR, SD231	14.50
I5001	SHOE, INTAKE, ROUGH, SD-312FG	138.00
I5002	SHOE, INTAKE, SD-312FG, SIZE 5/8"	163.50
I5003	SHOE, INTAKE, SD-312FG, SIZE 3/4"	163.50
I5004	SHOE, INTAKE, SD-312FG, SIZE 7/8"	163.50
I5005	SHOE, INTAKE, SD-312FG, SIZE 1"	163.50
I6307	SHOE, INTAKE, ROUGH, MAKES SIZE 1/2" & 5/8"	121.50
I6507	RIDEPLATE, ROUGH	138.00
I6601	RIDEPLATE, ROUGH, SD-312FG	187.50
I6607	RIDEPLATE, FINISHED	179.00
I6701	RIDEPLATE, FW	269.00
I6707	SHOE, INTAKE, ROUGH, MAKES SIZE 3/4", 7/8", & 1"	145.00
I6901	RIDEPLATE, 12TD, TJ309	211.00
I7003	YOKE, 2-1/8	88.00
I7201	RIDEPLATE, BRACKET, BW & FW	54.50
I7301	RIDEPLATE, BRACKET, 12TD TJ309	95.50
I8001	GRATE, INTAKE, FW	381.50
I9001	GRATE BAR, (NINE BAR INTAKE)	9.00
I9003	LOCKING BAR, (NINE BAR INTAKE)	25.50
IF6107	SHOE, INTAKE, SIZE 1/2"	163.50
IF6207	SHOE, INTAKE, SIZE 5/8"	163.50
IF6307	SHOE, INTAKE, SIZE 3/4"	163.50
IF6407	SHOE, INTAKE, SIZE 7/8"	163.50
IF6507	SHOE, INTAKE, SIZE 1"	163.50
IF6607	SHOE SHIM, SIZE 0.060, FITS BILLET 1/2 SHOE	30.50
IF6707	SHOE SHIM, SIZE 0.125, FITS 1/2 BILLET SHOE	30.50
IK0156	LEGEND INTAKE KIT, OUTSIDE (MAX. DISCOUNT 25%)	989.00
IK0156HP 04	INTAKE KIT, LEGEND OUTSIDE, HI-PERF, 1/2 SHOE (MAX. DISCOUNT 25%)	1,167.00
IK0156HP 05	INTAKE KIT, LEGEND OUTSIDE, HI-PERF, 5/8 SHOE (MAX. DISCOUNT 25%)	1,167.00
IK0156HP 06	INTAKE KIT, LEGEND OUTSIDE, HI-PERF, 3/4 SHOE (MAX. DISCOUNT 25%)	1,167.00
IK0701	INTAKE KIT, WELD-IN, LEGEND (MAX. DISCOUNT 25%)	989.00
IK1003	INTAKE KIT, DOM 12-S (MAX. DISCOUNT 25%)	850.00
IK1003HP 04	INTAKE KIT, DOM 12-S, HI-PERF, 1/2 SHOE (MAX. DISCOUNT 25%)	1,195.00
IK1003HP 05	INTAKE KIT, DOM 12-S, HI-PERF, 5/8 SHOE (MAX. DISCOUNT 25%)	1,195.00

## American Turbine 2019 Item Price List

Item	Description	Price
IK1003HP 06	INTAKE KIT, DOM 12-S, HI-PERF, 3/4 SHOE (MAX. DISCOUNT 25%)	1,195.00
IK1003HP 07	INTAKE KIT, DOM 12-S, HI-PERF, 7/8 SHOE (MAX. DISCOUNT 25%)	1,195.00
IK1003HP 08	INTAKE KIT, DOM 12-S, HI-PERF, 1" SHOE (MAX. DISCOUNT 25%)	1,195.00
IK1007	INTAKE KIT, AT-309 (MAX. DISCOUNT 25%)	850.00
IK1007HP 04	INTAKE KIT, AT-309, HI-PERF, 1/2 SHOE (MAX. DISCOUNT 25%)	1,195.00
IK1007HP 05	INTAKE KIT, AT-309, HI-PERF, 5/8 SHOE (MAX. DISCOUNT 25%)	1,195.00
IK1007HP 06	INTAKE KIT, AT-309, HI-PERF, 3/4 SHOE (MAX. DISCOUNT 25%)	1,195.00
IK1007HP 07	INTAKE KIT, AT-309, HI-PERF, 7/8 SHOE (MAX. DISCOUNT 25%)	1,195.00
IK1007HP 08	INTAKE KIT, AT-309, HI-PERF, 1" SHOE (MAX. DISCOUNT 25%)	1,195.00
IK1307	INTAKE KIT, WELD-IN, SD-309 (MAX. DISCOUNT 25%)	950.00
IK1307NS	INTAKE KIT, WELD-IN, NO-STEP, SD-309 (MAX. DISCOUNT 25%)	950.00
IK1401	INTAKE KIT, WELD-IN, SD-312 (MAX. DISCOUNT 25%)	1,195.00
IK1407	INTAKE KIT, BOLT-IN, SD-309 (MAX. DISCOUNT 25%)	850.00
IK1501	INTAKE KIT, FIBERGLASS, SD-312 (MAX. DISCOUNT 25%)	1,195.00
IK1501HP 05	INTAKE KIT, FIBERGLASS, SD-312, HI-PERF, 5/8 SHOE (MAX. DISCOUNT 25%)	1,395.00
IK1507	INTAKE KIT, FIBERGLASS, SD-309 (MAX. DISCOUNT 25%)	850.00
IK1507HP 05	INTAKE KIT, HI-PERF, SD-309, 5/8 SHOE (MAX. DISCOUNT 25%)	1,195.00
IK1507HP 06	INTAKE KIT, HI-PERF, SD-309, 3/4 SHOE (MAX. DISCOUNT 25%)	1,195.00
IK1602	SD-231 RIDEPLATE KIT (25%)	1,273.00
IK231SG	SD231 STOMP GRATE MAX DISC 25%	1,500.50
IK309SG7AT	STOMP GRATE, 309, 1997-UP	1,023.00
IK309SG9	STOMP GRATE, SD309 (LEGEND INTAKE)	964.00
IK312SG11	STOMP GRATE, SD312	964.00

### (IM) IMPELLERS

IM1000	IMPELLER, INDUCER (25% max DISCOUNT)	600.00
IM1001	IMPELLER, INDUCER, NO SHAFT MACHINING (25% DISCOUNT)	600.00
IMA01A	IMPELLER, ALUMINUM, AT, SIZE DE	586.00
IMA01H	IMPELLER, STAINLESS, AT, HIGH HELIX, SIZE DE	2,131.50
IMA01S	IMPELLER, STAINLESS, AT, SIZE DE	1,499.00
IMA02A	IMPELLER, ALUMINUM, AT, SIZE D	586.00
IMA02H	IMPELLER, STAINLESS, AT, HIGH HELIX, SIZE D	2,131.50
IMA02S	IMPELLER, STAINLESS, AT, SIZE D	1,499.00
IMA03A	IMPELLER, ALUMINUM, AT, SIZE CD	586.00
IMA03H	IMPELLER, STAINLESS, AT, HIGH HELIX, SIZE CD	2,131.50
IMA03S	IMPELLER, STAINLESS, AT, SIZE CD	1,499.00
IMA04A	IMPELLER, ALUMINUM, AT, SIZE C	586.00
IMA04H	IMPELLER, STAINLESS, AT, HIGH HELIX, SIZE C	2,131.50
IMA04S	IMPELLER, STAINLESS, AT, SIZE C	1,499.00
IMA05A	IMPELLER, ALUMINUM, AT, SIZE BC	586.00
IMA05H	IMPELLER, STAINLESS, AT, HIGH HELIX, SIZE BC	2,131.50
IMA05S	IMPELLER, STAINLESS, AT, SIZE BC	1,499.00
IMA06A	IMPELLER, ALUMINUM, AT, SIZE B	586.00
IMA06H	IMPELLER, STAINLESS, AT, HIGH HELIX, SIZE B	2,131.50
IMA06S	IMPELLER, STAINLESS, AT, SIZE B	1,499.00

## American Turbine 2019 Item Price List

Item	Description	Price
IMA07A	IMPELLER, ALUMINUM, AT, SIZE AB	586.00
IMA07H	IMPELLER, STAINLESS, AT, HIGH HELIX, SIZE AB	2,131.50
IMA07S	IMPELLER, STAINLESS, AT, SIZE AB	1,499.00
IMA08A	IMPELLER, ALUMINUM, AT, SIZE A	586.00
IMA08H	IMPELLER, STAINLESS, AT, HIGH HELIX, SIZE A	2,131.50
IMA08S	IMPELLER, STAINLESS, AT, SIZE A	1,499.00
IMA09A	IMPELLER, ALUMINUM, AT, SIZE A+	586.00
IMA09H	IMPELLER, STAINLESS, AT, HIGH HELIX, SIZE A+	2,131.50
IMA09S	IMPELLER, STAINLESS, AT, SIZE A+	1,499.00
IMA10A	IMPELLER, ALUMINUM, AT, SIZE AA	586.00
IMA10H	IMPELLER, STAINLESS, AT, HIGH HELIX, SIZE AA	2,131.50
IMA10HH	HIPPED HIGH HELIX IMPELLER, SIZE AA	2,745.50
IMA10S	IMPELLER, STAINLESS, AT, SIZE AA	1,499.00
IMA11A	IMPELLER, ALUMINUM, AT, SIZE 9.25	586.00
IMA11H	IMPELLER, STAINLESS, AT, HIGH HELIX, SIZE 9.25	2,131.50
IMA11HH	HIPPED HIGH HELIX IMPELLER, SIZE 9.25	2,745.50
IMA11S	IMPELLER, STAINLESS, AT, SIZE 9.25	1,499.00
IMA12A	IMPELLER, ALUMINUM, AT, SIZE 9.50	586.00
IMA12H	IMPELLER, STAINLESS, AT, HIGH HELIX, SIZE 9.5	2,131.50
IMA12HH	HIPPED HIGH HELIX IMPELLER, SIZE 9.5	2,745.50
IMA12HL	IMPELLER, STAINLESS, HIGH-HELIX, HIPPED, LEFT HAND, SIZE 9.5 (NO DISCOUNT)	4,073.00
IMA12S	IMPELLER, STAINLESS, AT, SIZE 9.50	1,499.00
IMA20S	IMPELLER, STAINLESS, SD-312, SIZE 2.4KW	1,620.00
IMA22S	IMPELLER, STAINLESS, SD-312, SIZE 2.6KW	1,620.00
IMA24S	IMPELLER, STAINLESS, SD-312, SIZE 2.9KW	1,620.00
IMA26S	IMPELLER, STAINLESS, SD-312, SIZE 3.3KW	1,620.00
IMA30S	IMPELLER, STAINLESS, SD-312, SIZE 4.0KW	1,620.00
IMA32S	IMPELLER, STAINLESS, SD-312, SIZE 5.0KW	1,620.00
IMB01A	IMPELLER, ALUMINUM, BERK, SIZE DE	586.00
IMB01H	IMPELLER, STAINLESS, BERK, HIGH HELIX, SIZE DE	2,131.50
IMB01S	IMPELLER, STAINLESS, BERK, SIZE DE	1,499.00
IMB02A	IMPELLER, ALUMINUM, BERK, SIZE D	586.00
IMB02H	IMPELLER, STAINLESS, BERK, HIGH HELIX, SIZE D	2,131.50
IMB02S	IMPELLER, STAINLESS, BERK, SIZE D	1,499.00
IMB03A	IMPELLER, ALUMINUM, BERK, SIZE CD	586.00
IMB03H	IMPELLER, STAINLESS, BERK, HIGH HELIX, SIZE CD	2,131.50
IMB03S	IMPELLER, STAINLESS, BERK, SIZE CD	1,499.00
IMB04A	IMPELLER, ALUMINUM, BERK, SIZE C	586.00
IMB04H	IMPELLER, STAINLESS, BERK, HIGH HELIX, SIZE C	2,131.50
IMB04S	IMPELLER, STAINLESS, BERK, SIZE C	1,499.00
IMB05A	IMPELLER, ALUMINUM, BERK, SIZE BC	586.00
IMB05H	IMPELLER, STAINLESS, BERK, HIGH HELIX, SIZE BC	2,131.50
IMB05S	IMPELLER, STAINLESS, BERK, SIZE BC	1,499.00
IMB06A	IMPELLER, ALUMINUM, BERK, SIZE B	586.00
IMB06H	IMPELLER, STAINLESS, BERK, HIGH HELIX, SIZE B	2,131.50

## American Turbine 2019 Item Price List

Item	Description	Price
IMB06S	IMPELLER, STAINLESS, BERK, SIZE B	1,499.00
IMB07A	IMPELLER, ALUMINUM, BERK, SIZE AB	586.00
IMB07H	IMPELLER, STAINLESS, BERK, HIGH HELIX, SIZE AB	2,131.50
IMB07S	IMPELLER, STAINLESS, BERK, SIZE AB	1,499.00
IMB08A	IMPELLER, ALUMINUM, BERK, SIZE A	586.00
IMB08H	IMPELLER, STAINLESS, BERK, HIGH HELIX, SIZE A	2,131.50
IMB08S	IMPELLER, STAINLESS, BERK, SIZE A	1,499.00
IMB09A	IMPELLER, ALUMINUM, BERK, SIZE A+	586.00
IMB09H	IMPELLER, STAINLESS, BERK, HIGH HELIX, SIZE A+	2,131.50
IMB09S	IMPELLER, STAINLESS, BERK, SIZE A+	1,499.00
IMB10A	IMPELLER, ALUMINUM, BERK, SIZE AA	586.00
IMB10H	IMPELLER, STAINLESS, BERK, HIGH HELIX, SIZE AA	2,131.50
IMB10HH	HIPPED HIGH HELIX IMPELLER, BERK, SIZE AA	2,745.50
IMB10S	IMPELLER, STAINLESS, BERK, SIZE AA	1,499.00
IMB11A	IMPELLER, ALUMINUM, BERK, SIZE 9.25	586.00
IMB11H	IMPELLER, STAINLESS, BERK, HIGH HELIX, SIZE 9.25	2,131.50
IMB11S	IMPELLER, STAINLESS, BERK, SIZE 9.25	1,499.00
IMB12A	IMPELLER, ALUMINUM, BERK, SIZE 9.50	586.00
IMB12H	IMPELLER, STAINLESS, BERK, HIGH HELIX, SIZE 9.5	2,131.50
IMB12S	IMPELLER, STAINLESS, BERK, SIZE 9.50	1,499.00
IML02A	IMPELLER, ALUMINUM, LEGEND, SIZE D	586.00
IML04A	IMPELLER, ALUMINUM, LEGEND, SIZE C	586.00
IML05A	IMPELLER, ALUMINUM, LEGEND, SIZE BC	586.00
IML06A	IMPELLER, ALUMINUM, LEGEND, SIZE B	586.00
IML06S	IMPELLER, STAINLESS, LEGEND, SIZE B	1,499.00
IML07A	IMPELLER, ALUMINUM, LEGEND, SIZE AB	586.00
IML07S	IMPELLER, STAINLESS, LEGEND, SIZE AB	1,499.00
IML08A	IMPELLER, ALUMINUM, LEGEND, SIZE A	586.00
IML08S	IMPELLER, STAINLESS, LEGEND, SIZE A	1,499.00
IML10A	IMPELLER, ALUMINUM, LEGEND, SIZE AA	586.00
IML10S	IMPELLER, STAINLESS, LEGEND, SIZE AA	1,499.00
IML11A	IMPELLER, ALUMINUM, LEGEND, SIZE 9.25	586.00
IML11S	IMPELLER, STAINLESS, LEGEND, SIZE 9.25	1,499.00
IML12A	IMPELLER, ALUMINUM, LEGEND, SIZE 9.50	586.00
IMX203-138	IMPELLER, STAINLESS, SD191AF, SD203AF, 1.38 KW	2,570.00
IMX203-175	IMPELLER, STAINLESS, SD191AF, SD203AF, 1.75 KW	2,570.00
IMX203-280	IMPELLER, STAINLESS, SD203AF, 2.8 KW	1,550.00
IMX203-310	IMPELLER, STAINLESS, SD203AF, 3.1 KW	1,550.00
IMX231-290	IMPELLER, STAINLESS, SD231AF, 2.9 KW	1,995.00
IMX231-350	IMPELLER, STAINLESS, SD231AF, 3.5 KW	1,995.00
IMX231-420	IMPELLER, STAINLESS, SD231, 4.2KW	1,995.00
<b>ENERGIZER KITS (MAX DEALER DISCOUNT IS 25%)</b>		
JK2108	WJ JACUZZI ENERGIZER KIT	2,640.50
JK2208	YJ JACUZZI ENERGIZER KIT	2,787.00

# American Turbine 2019 Item Price List

Item	Description	Price
PK1001	PANTHER ENERGIZER KIT <b>KITS COME STANDARD WITH ALUMINUM IMPELLER &amp; STANDARD STEERING</b> <b>SEE JETDRIVE PACKAGE PRICE SHEET FOR ADD ON OPTIONS</b>	3,523.00
<b>(JT) JET TRIM PARTS</b>		
JT0001	BUSHING, LOWER STEERING PIVOT (JET TRIM)	13.00
JT0002	STOP SLEEVE, JET TRIM HYD. CYL.	23.00
JT0003	JET TRIM REVERSE CABLE BRACKET, POLISHED	185.00
JT0004	JET TRIM REVERSE CABLE BRACKET	80.50
JT0005	RUDDER PIVOT BRACKET, JET TRIM	54.50
JT1011	PIVOT BLOCK, JET TRIM HYD. CYL.	114.50
JT1411	JET TRIM STEERING NOZZLE (NEW)	708.00
JT1911	JET TRIM NOZZLE (NEW)	755.50
JT2111	JET TRIM REVERSE BUCKET	387.00
JT2401	JET TRIM RUDDER	186.50
JT2501	JET TRIM RUDDER, POLISHED	259.00
JT3111	JET TRIM TILLER ARM	215.50
JT7211	HYDRAULIC CYLINDER, JET TRIM	256.50
JT7311	JET TRIM, HYD. CYLINDER, STRAIGHT FITTING	7.50
JTA8507C	JET TRIM ASSEMBLY, 3.19 INSERT (MAX. DISCOUNT 25%)	1,316.00
JTA8507D	JET TRIM ASSEMBLY, 3.25 INSERT (MAX. DISCOUNT 25%)	1,316.00
JTA8507H	JET TRIM ASSEMBLY, 3.60 INSERT (MAX. DISCOUNT 25%)	1,316.00
JTA8607A	JET TRIM ASSEMBLY, W/RK7301, 3.00 INSERT (MAX. DISCOUNT 25%)	1,794.00
JTA8607C	JET TRIM ASSEMBLY, W/RK7301, 3.19 INSERT (MAX. DISCOUNT 25%)	1,794.00
JTA8607D	JET TRIM ASSEMBLY, W/RK7301, 3.25 INSERT (MAX. DISCOUNT 25%)	1,794.00
JTA8607H	JET TRIM ASSEMBLY, W/RK7301, 3.60 INSERT (MAX. DISCOUNT 25%)	1,794.00
<b>LEGEND PARTS</b>		
J0027	LEGEND NOZZLE HOUSING	395.00
J0030-1	LEGEND 1 DEGREE WEDGE	190.00
J0030-2	LEGEND 2 DEGREE WEDGE	190.00
J0030-3	LEGEND 3 DEGREE WEDGE	190.00
J0030-4	LEGEND 4 DEGREE WEDGE	190.00
J0079	TRANSOM ADAPTER	750.00
J0098	LEGEND "E" HAND HOLE COVER	245.00
J0100	OEM LEGEND BOWL / SUCTION O-RING	9.00
J0101	OEM LEGEND NOZZLE HOUSING O-RING	5.00
J0102	OEM LEGEND BEARING CAP O-RING	4.00
J0104	1/4 NYLON WASHER	2.50
J0107	BALL JOINT ROD END	35.00
J0129	LEGEND "G" HAND HOLE COVER	225.00
J0155	12 DEGREE INTAKE, INSIDE	1,195.00
J0157	FLAT BOLT-IN INTAKE	1,195.00
J0167	LEGEND TRANSOM GASKET	35.00
J0168	TRANSOM FLANGE GASKET	37.00

## American Turbine 2019 Item Price List

Item	Description	Price
J0173	LEGEND RUBBER BELLOWS	31.00
J0174	BERKELEY CABLE O-RING	2.50
J0250	LEGEND REVERSE BUCKET	295.00
J0287	LEGEND PACKING RING	14.00
J0338	LEGEND BEARING CAP	245.00
J0357	LEGEND AQUAMET SHAFT	800.00
J0396	OEM BERKELEY TILLER SHAFT	85.50
J0397	LEGEND UPPER TILLER SHAFT	73.50
J0405	LEGEND STEERING NOZZLE	435.00
J0410	LEGEND "E" GRATE RETAINER (SEE PART # I4307	70.50
J0411	LEGEND "E" INTAKE GRATE	199.00
J0412	BERKELEY REVERSE CONTROL ARM PIN	25.00
J0413	BERKELEY REVERSE CABLE ADJUST NUT	16.00
J0426	BERKELEY REVERSE CABLE PACKER NUT	38.00
J0427	BERKELEY REVERSE CABLE SPLIT WASHER	6.00
J0430	LEGEND REVERSE CABLE PACKER PLATE	37.00
J0479	GROOVE PIN	7.50
J0480	GREASE FITTING	4.00
J0484	SHAFT SNAP RING, .094	10.50
J0488	REVERSE CABLE GROMMET (THIN WALL)	11.00
J0489	REVERSE CABLE GROMMET (THICK WALL)	11.00
J0495	BERKELEY BOWL BY LEGEND	1,288.50
J0496	LEGEND BOWL	1,365.00
J0530	STEERING TUBE NUT	25.00
J0532	STEERING TUBE LUBE NUT	40.00
J0567	LEGEND "E" CAVITATION PLATE	260.00
J0569	STANDARD RIDE PLATE	260.00
J0595	BERKELEY ALUMINUM RUDDER	223.50
J0596	LEGEND ALUMINUM RUDDER	230.00
J0609	BERKELEY REVERSE RETAINING SPRING	25.00
J0645	LEGEND TILLER ARM	175.00
J0646	BERKELEY TILLER	175.00
J0680	5/16-18 FLANGE NUT	5.00
J0697	LEGEND DROOP SNOOT BUCKET	335.50
J0698	LEGEND DROOP SNOOT NOZZLE	413.00
J0715	LEGEND "E" SUCTION PIECE	1,473.50
J0726	LEGEND SUCTION PIECE BY AMERICAN TURBINE	1,600.00
J0726A	OEM LEGEND SUCTION PIECE	1,850.00
J0731	BERKELEY TRANSOM O-RING	16.00
J0753	LEGEND & BERKELEY RUDDER PIN	39.50
J0767	LEGEND / BERKELEY 6 BAR GRATE	241.50
J0800	7-BAR ROCK GRATE	345.00
J0803	9-BAR ROCK GRATE - TYPE 2	345.00
J0818-N	3/4 HOSE X 1/2 MPT NYLON BARB	4.00
J0818-S	BARB 3/4 HOSE X 1/2 MPT	6.50



## American Turbine 2019 Item Price List

Item	Description	Price
J0820-N	1/2 PIPE PLUG NYLON HEX	4.00
J0820-S	HEX 1/2" PIPE PLUG	5.00
J0840	CAVITATION PLATE BRACKET	121.50
J0850	BOWL PLUG, LEGEND PLASTIC	13.00
J0881	LIQUID TIGHT FITTING 3/8 NPT	7.50
J0882	3/8 NPT NYLON PLUG	2.50
J0883	DRAIN PLUG, 1/8 PIPE	6.50
J0885	UNIVERSAL TRANSOM FLANGE PLATE	450.00
J0886	TRANSOM FLANGE FORK	27.00
J0888	FLANGE PLATE O-RING	10.50
J0889	HOSE BARB CONNECTOR, UNIVERSAL FLANGE-LONG	54.50
J0891	UNIVERSAL TRANSOM FLANGE PLATE - SHORT	323.50
J0892	4" STEERING EXTENSION	76.50
J0894	DOME PLUG, TRANSOM PLATE 1/2-20	4.00
J0896	8" STEERING EXTENSION	76.50
J0900	1/4 BALL JOINT WASHER	2.50
J0901	RUDDER WASHER	2.50
J0902	5/16 WASHER - HAND HOLE COVER	2.50
J0907	ROD END	30.00
J0909	3/8 WASHER - BOWL	2.50
J0938	1/4-28 X 3/8 BUTTON HEAD CAP SCREW	4.00
J0942	7/8-14 NYLON JAM NUT	4.00
J0943	1/4-20 NYLON LOCK NUT	2.50
J1005	CAP, GREASE FITTING	2.50
J1014	3/4 X 6" WATER HOSE	7.50
J1016	PACKING REMOVAL TOOL (NO DISCOUNT)	31.00
K0592	OEM BERKELEY REVERSE CONTROL KIT	90.00
K0593	OEM BERKELEY REVERSE CABLE PACKER ASSEMBLY	50.00
<b>(M) MISCELLANEOUS</b>		
M000P	WEDGE, 1/2 DEG, PLASTIC	70.00
M001A	WEDGE, 1 DEG, ALUMINUM	110.00
M001P	WEDGE, 1 DEG, PLASTIC	70.00
M002A	WEDGE, 2 DEG, ALUMINUM	110.00
M002P	WEDGE, 2 DEG, PLASTIC	70.00
M003A	WEDGE, 3 DEG, ALUMINUM	110.00
M003P	WEDGE, 3 DEG, PLASTIC	70.00
M004A	WEDGE, 4 DEG, ALUMINUM	110.00
M004P	WEDGE, 4 DEG, PLASTIC	70.00
M1000	SEALED ULTRA SUBMINIATURE SWITCH, SD231	45.00
M1001	CENTERING SPRING, RA231, SD231	11.50
M1008	RUBBER COVERED CLAMP, SD231	6.00
M1201	REVERSING RELAY, 150A SURGE, 75A CONTINUOUS	181.00
M1202	REVERSING RELAY, 70A SURGE, 50A CONTINUOUS (NO DISC)	85.50
M1507	SPEED COAT, SPRAY CAN 12 OZ.	46.00

## American Turbine 2019 Item Price List

Item	Description	Price
M1607	SPEED COAT, GALLON CAN	185.00
M1701	POXY PUTTY, QUART CAN (NO DISCOUNT)	95.00
M1801	POXY PUTTY, PINT CAN (NO DISCOUNT)	60.00
M2007	SCHAEFFER PUMP GREASE (NO DISCOUNT)	15.00
M3001	PIVOT PIN, SHIFTER 40 SERIES CABLE	16.00
M3002	PIVOT PIN, SHIFTER 30 SERIES CABLE	16.00
M4007	RUBBER BELLOWS	29.00
M4107	HOSE CLAMP, LARGE	4.00
M4207	HOSE CLAMP, SMALL	4.00
M4501	HOSE CLAMP, TJ	7.50
M4601	1" DRAIN PLUG	7.50
M4701	BULK HEAD SEAL, HYD LINE	9.00
M4702	RECTIFIER DIODE	19.50
M4801	ZERK FITTING, STEERING TUBE SEAL	4.00
M4901	RUBBER ISOLATOR BOLT BUSHING	2.50
M5001	VINYL CAP, 3/8	2.50
M5007	IMPELLER WRENCH, PLATE STEEL (NO DISCOUNT)	50.00
M5107	IMPELLER PULLER (NO DISCOUNT)	225.00
M5108	BOWL BUSHING DRIVER	31.00
M5109	BERKELEY, DOMINATOR, AT, SUCTION SEAL DRIVER	35.00
M5110	BOWL SEAL DRIVER	29.50
M5111	DRIVER SHAFT	40.50
M5112	IMPELLER NUT SOCKET (NO DISCOUNT)	97.50
M5114	BERKELEY, DOM, AT, BEARING CAP SEAL	31.00
M5201	GREASE CAP (STEERING TUBE SEAL)	2.50
M5307	DRIVELINE ADAPTER 1310 (LATE FLY)-NO DISC.	130.00
M5407	DRIVELINE ADAPTER 1310 (LATE FLEX) - NO DISC.	130.00
M5507	DRIVELINE ADAPTER 1310 (EARLY FLEX) - NO DISC.	130.00
M5607	DRIVELINE ADAPTER 1310 (EARLY FLY) - NO DISC.	130.00
M5707	DRIVELINE ADAPTER 1350 (EARLY FLYWHEEL) NO DISC.	130.00
M5807	DRIVELINE ADAPTER 1350 EARLY (FLEX) (NO DISC)	130.00
M5906	DRIVELINE ADAPTER 1310 LS (FLEX)-NO DISC	195.00
M5907	DRIVELINE ADAPTER 1310 LS (FLY)-NO DISC	195.00
M6007	DRIVELINE ADAPTER 1350 LS (FLEX) NO DISC.	195.00
M6107	DRIVELINE ADAPTER 1350 LS (FLYWHEEL) NO DISC.	195.00
M6207	CHEVY 1350 LATE FLEX	130.00
M6307	CHEVY 1350 LATE FLYWHEEL	130.00
M770001	LANOCOTE 4OZ (NO DISC)	13.50
M770003	LANOCOTE 16OZ (NO DISC)	35.00
M770007	LANOCOTE SPRAY (NO DISC)	19.00
MK1001	SEAL, THRUST BEARING, KODIAK / MP	18.00
MK1002	O-RING, BEARING HOUSING, MP901, MP 3-STAGE, KODIAK	9.50
MK1003	O-RING, SEAL FACE HOUSING, MP901, MP 3-STAGE, KODIAK	9.50

**(O) O-RINGS**

## American Turbine 2019 Item Price List

Item	Description	Price
O1001	O-RING, HANDHOLE COVER, AT	9.50
O1002	O-RING, HANDHOLE COVER, BERK, SD & FW	9.50
O1003	O-RING, HANDHOLE COVER, DOM	9.50
O1101	O-RING, BOWL (PRE 1994, O-RINGS FITS INTO THE FACE OF THE BOWL, AT309 ONLY)	33.50
O1201	O-RING, TRANSOM SEAL, AT, 1/4 x 37-1/2"	29.00
O1301	O-RING, PLUG / HAND HOLE EXT.	9.50
O1401	O-RING, TEFLON, NOZZLE, AT	28.00
O1501	O-RING JET TRIM, UP/DN ENCAPSULATED	41.50
O1502	O-RING, TEFLON, NOZZLE, PRE 1994 BERK	25.50
O1505	O-RING, TEFLON, NOZZLE, DOM, BEST	27.00
O2002	O-RING, TRANSOM (BERK, DOM, YJ, WJ)	32.50
O2103	O-RING, SEAL-PAC, 12TD	11.50
O2203	O-RING, BOWL PLUG	7.50
O2501	O-RING, STEERING BALL	4.50
O3001	O-RING, REVERSE CABLE PACKER	4.50
O3101	O-RING, BOWL (AT, SD231, WJ)	16.00
O3102	O-RING, BOWL TO SUCTION (OEM BERKELEY 1994 TO PRESENT)	16.00
O3108	O-RING, YJ SEAL-PAC, WJ BEARING HOUSING	10.50
O3201	O-RING, WATER TUBE, SD	5.50
O3208	O-RING, WJ NOZZLE, YJ/WJ INSPECTION COVER	13.50
O3301	O-RING, BEARING HOUSING, SD203, 309, 312	9.50
O3401	O-RING, SEAL FACE HOUSING O.D., SD203, 309, 312	7.50
O3501	O-RING, STEERING TUBE SEAL	3.50
O3601	O-RING, BEARING CAP, HI-PERF.	8.50
O3801	O-RING, WATER TUBE, SD203, 312	4.50
O3901	O-RING, INTAKE, SD-312	31.50
O4001	O-RING, SD-312 BOWL, SD203 STATOR	11.50
O5001	O-RING, NOZZLE HOUSING, SD191, SD203, TJ191	13.50
O5018	O-RING, STEERING SHAFT, SD231	2.50
O5024	O-RING, WATER TUBE, SD231	2.50
O5026	O-RING, BEARING SLEEVE STATOR	2.50
O5035	O-RING, OIL RESERVOIR LID	17.00
O5123	O-RING, SHAFT TO SLINGER RING 12S-MR	11.50
O5124	O-RING, WATER TAKE OFF, SD231	2.50
O5126	O-RING, EHA MOUNT, SD231	2.50
O5152	O-RING, SEAL FACE HOUSING SMALL, SD231	3.00
O5154	O-RING, SEAL FACE HOUSING, SD231	3.00
O5156	O-RING, STATOR BEARING CARTRIDGE, SD231	3.50
O5172	O-RING, WEAR PLATE, SD203AF	9.50
O5204	O-RING, SHIFT SHAFT PIN, SD231	6.50
O5262	O-RING, NOZZLE HOUSING, SD231	3.00
O5264	STAGE PUMP STATOR O-RING	17.00
O5271	O-RING, WEAR SLEEVE, SD231	4.50
O5320	O-RING, SHAFT TO PRELOAD RING 12S-MR	13.50
O5352	O-RING, HANDHOLE COVER, SD231	3.00

# American Turbine 2019 Item Price List

Item	Description	Price
O5363	O-RING, TEFLON, NOZZLE, SD203	32.50
O5369	O-RING, TEFLON, NOZZLE, 231AF	53.00
O62080	O-RING, OIL RESERVOIR TO SUCTION 12S-MR	21.00
<b>(OHK) OVERHAUL KITS</b>		
OHK1001	AT-309 OVERHAUL KIT	525.00
OHK1001HP	AT-309 HP OVERHAUL KIT	575.00
OHK1001UP	AT-309 OVERHAUL KIT UPGRADE (HP BEARING KIT REQUIRED - PART # HPK1905)	395.00
OHK1002	OEM BERKELEY OVERHAUL KIT	479.00
OHK1002HP	OEM BERKELEY HP OVERHAUL KIT	575.00
OHK1002UP	OEM BERKELEY OVERHAUL KIT UPGRADE (HP BEARING KIT REQUIRED - PART # HPK1902)	395.00
OHK1003	DOM 12-S OVERHAUL KIT (SERIAL # 23598 - PRESENT)	495.00
OHK1003HP	DOM 12-S HP OVERHAUL KIT (SERIAL # 25562 - PRESENT)	550.00
OHK1003UP	DOM 12-S OVERHAUL KIT UPGRADE, REQUIRES PART # HPK1905 (SERIAL # 23598 - PRESENT)	395.00
OHK1103	DOM 12-S OVERHAUL KIT (SERIAL # 14400 - 23597)	495.00
OHK1103HP	DOM 12-S HP OVERHAUL KIT (SERIAL # 14400 - 23597)	575.00
OHK1103UP	DOM 12-S OVERHAUL KIT UPGRADE, REQUIRES HPK1905 (SERIAL # 14400 - 23597)	395.00
OHK1203	DOM 12-S OVERHAUL KIT (SERIAL # UP TO 14400)	565.00
OHK1203HP	DOM 12-S HP OVERHAUL KIT (SERIAL # UP TO 14400)	599.00
OHK1203UP	DOM 12-S OVERHAUL KIT UPGRADE, REQUIRES HPK1903 (SERIAL # UP TO 14400)	479.00
OHK120AT	LEGEND "AT" OVERHAUL KIT	550.00
OHK120G	LEGEND "G" OVERHAUL KIT	450.00
OHK120GUP	LEGEND "G" OVERHAUL KIT UPGRADE (HP BEARING KIT REQUIRED - PART # HPK1902)	395.00
OHK1301	SD-309 OVERHAUL KIT	550.00
OHK1401	SD-312 OVERHAUL KIT, WELDED ALUMINUM	740.00
OHK1501	SD-312FG OVERHAUL KIT, FIBERGLASS	825.00
OHK1503	DOM 12-TD OVERHAUL KIT (SERIAL # 23598 - PRESENT)	479.00
OHK1503HP	DOM 12-TD HP OVERHAUL KIT (SERIAL # 25562 - PRESENT)	550.00
OHK1503UP	DOM 12-TD OVERHAUL KIT UPGRADE, REQUIRES HPK1905 (SERIAL # 23598 - PRESENT)	395.00
OHK1603	DOM 12-TD OVERHAUL KIT (SERIAL # 17430 - 23597)	479.00
OHK1603HP	DOM 12-TD HP OVERHAUL KIT (SERIAL # 17430 - 23597)	575.00
OHK1603UP	DOM 12-TD OVERHAUL KIT UPGRADE, REQUIRES HPK1905 (SERIAL # 17430 - 23597)	395.00
OHK1703	DOM 12-TD W/O PACKING OVERHAUL KIT (SERIAL # UP TO 14400)	550.00
OHK1803	DOM 12-TD W/O PACKING OVERHAUL KIT (SERIAL # 14400 - 17430)	550.00
OHK191TJ	TJ191 AXIAL FLOW OVERHAUL KIT	857.00
OHK2008	YJ JACUZZI ENERGIZER OVERHAUL KIT	608.50
OHK2108	WJ JACUZZI ENERGIZER OVERHAUL KIT	582.50
OHKMP901	OEM MARINE POWER 901 OVERHAUL KIT	480.00
<b>(P) PANTHER OEM REPLACEMENT PARTS</b>		
P1001	PANTHER TRANSOM SEAL, 39"	5.50
P1007	OEM PANTHER BEARING CAP SEAL	31.50
P1101	OEM PANTHER BEARING	158.00
P1102	OEM PANTHER BEARING RACE	67.50
P1502	OEM PANTHER TAIL BUSHING	24.00

## American Turbine 2019 Item Price List

Item	Description	Price
P2003	OEM PANTHER STATOR SEAL	40.50
P3007	OEM PANTHER IMPELLER KEY	4.50
P3507	OEM PANTHER IMPELLER LOCKNUT	8.50
P4008	OEM PANTHER MECHANICAL SEAL	82.00
P5507	OEM PANTHER WOODRUFF KEY	5.00
<b>(R ) STEERING COMPONENTS</b>		
R1007	NOZZLE, HOUSING (BERK, DOM, BEST)	325.00
R1101	NOZZLE, HI-FLOW, NO REVERSE	378.50
R1201	NOZZLE, HI-FLOW, W / REVERSE	382.50
R1401	NOZZLE, TRIM, MIDDLE TRANSITION	425.00
R1701	NOZZLE, HTR	425.00
R1703	NOZZLE, DOMINATOR	425.00
R1707B	NOZZLE, BERK, 3.25 BORE	425.00
R1707C	NOZZLE, BERK, 3.70 BORE	425.00
R1901	NOZZLE, TRIM	535.00
R2001	NOZZLE, HTR II, SDR	425.00
R2101	REVERSE BUCKET, HTR	175.00
R2101B	REVERSE BUCKET, BERK (AT STYLE)	199.00
R2103	REVERSE BUCKET, DOM	199.00
R231A	30 SERIES CABLE ADAPTER, SD231	58.50
R231B	CABLE SWITCH BACK - POWER SHIFT	68.00
R231F	CABLE SWITCH FRONT - POWER SHIFT	56.50
R231S	CABLE SWITCH SHAFT - POWER SHIFT	48.00
R2701	RUDDER, 3-BOLT, BW	135.50
R2801	TILLER ARM, FW	296.50
R3001	TILLER ARM, BEST	195.00
R3003	TILLER ARM, DOM	195.00
R3101	TILLER ARM, TRIM, MANUAL	195.00
R3201	TILLER ARM, TRIM, HYDRAULIC	195.00
R3202	HYDRAULIC TUBING (NO DISCOUNT) PER FOOT	3.50
R3301	TILLER ARM, HTR	195.00
R3401	TILLER BRACKET, FW	50.00
R3601	PIN, UPPER STEERING	35.00
R3701	PIN, LOWER STEERING, REVERSE BUCKET	25.50
R3702	5/8-11 X 1 SOCKET HEAD CAP SCREW W/ 5/8 PIVOT HEAD	14.00
R3703	5/8-11 X 5/8 SOCKET HEAD CAPSCREW W/ 3/4 PIVOT HEAD TYPE 304	13.50
R3801	UP/DN LEVER, TRIM HYDRAULIC	195.00
R3901	UP/DN LEVER, TRIM MANUAL	195.00
R4001	1/4 O.D. NPT MALE ELBOW	15.50
R4002	1/4 O.D. PUSH TO CONNECT UNION WYE	39.00
R5005	PIN, REVERSE PIVOT	25.50
R5108	PIN, REVERSE PIVOT 10/32 THRD.	25.50
R5201	PIN, HYDRAULIC PIVOT	25.50
R5301	THREADED ADAPTER for R5401 1-5/16 x 1-12	60.00

## American Turbine 2019 Item Price List

Item	Description	Price
R5401	STEERING CABLE ADAPTER, FW	195.00
R5507SS	KEY, WOODRUFF #9 STAINLESS STEEL	8.50
R6007	HOUSING, DROOP SNOOT, BERK, DOM	359.00
R6101	SHORT SNOOT, AT	359.00
R6107	DROOP SNOOT, SHORT, BERK, DOM	359.00
R6201	LONG SNOOT, AT (STRAIGHT)	390.00
R6301	HI-FLOW DROOP SNOOT HSG (AT)	390.00
R6507	EXTENSION HOUSING, 2"	340.00
R6607	EXTENSION HOUSING, 6"	469.00
R70010	NOZZLE INSERT, TRIM, SIZE 3.000	66.50
R70012	NOZZLE INSERT, TRIM, SIZE 3.125	66.50
R70013	NOZZLE INSERT, TRIM, SIZE 3.187	66.50
R70014	NOZZLE INSERT, TRIM, SIZE 3.250	66.50
R70015	NOZZLE INSERT, TRIM, SIZE 3.312	66.50
R71010	NOZZLE INSERT, HTR, SIZE 3.000	66.50
R71012	NOZZLE INSERT, HTR, SIZE 3.125	66.50
R71013	NOZZLE INSERT, HTR, SIZE 3.187	66.50
R71014	NOZZLE INSERT, HTR, SIZE 3.250	66.50
R71015	NOZZLE INSERT, HTR, SIZE 3.312	66.50
R7201	HYDRAULIC CYLINDER, TURBINE TRIM	138.00
R7202	DIVERTER VALVE CYLINDER	190.00
R7300	NOZZLE INSERT, HTR II, SDR, JET TRIM, SIZE 3.00	66.50
R7301	HYDRAULIC CONTROL UNIT (MAX. 25% DISCOUNT) PUMP ONLY	675.00
R7319	NOZZLE INSERT, HTR II, SDR, JET TRIM, SIZE 3.19	66.50
R7325	NOZZLE INSERT, HTR II, SDR, JET TRIM, SIZE 3.25	66.50
R7350	NOZZLE INSERT, HTR II, SDR, JET TRIM, SIZE 3.50	66.50
R7360	NOZZLE INSERT, HTR II, SDR, JET TRIM, SIZE 3.60	66.50
R7370	NOZZLE INSERT, HTR II, SDR, JET TRIM, SIZE 3.70	66.50
R7380	NOZZLE INSERT, HTR II, SDR, JET TRIM, SIZE 3.80	66.50
R8301	20 FT. HYD. UNIT WIRE	39.50
R8307	90 DEG. BRASS FITTING, HYDRAULIC CYLINDER	8.50
R8309	TRIM RECTIFIER	50.00
R8401	FUSE HOLDER	6.50
R8407	BRASS INSERT FOR PLASTIC TUBE	2.50
R8409	TRIM SWITCH	37.00
R9106	GROMMET, STEERING TUBE	9.00
R9107	STEERING EXTENSION, 6-1/2	85.00
R9206	STEERING TUBE NUT	24.00
R9207	STEERING EXTENSION 10" C-C	85.00
R9401	STEERING ADJUSTER	135.50
R9601	STEERING EXTENSION, 4-1/8	85.00
R9607	WIRING HARNESS, HYD UNIT	164.50
R9701	O-RING BACK-UP	6.50
RK0907	RUDDER, PLASTIC BERKELEY W / PIN	117.50
RA1101A	STEERING ASSEMBLY, HI-FLOW, NO REVERSE, 3.000 INSERT (MAXIMUM DISCOUNT 25%)	810.00

## American Turbine 2019 Item Price List

Item	Description	Price
RA1101B	STEERING ASSEMBLY, HI-FLOW, NO REVERSE, 3.125 INSERT (MAXIMUM DISCOUNT 25%)	810.00
RA1201A	STEERING ASSEMBLY, HI-FLOW DROOP, 3.000 INSERT (MAXIMUM DISCOUNT 25%)	946.00
RA1201B	STEERING ASSEMBLY, HI-FLOW DROOP, 3.125 INSERT (MAXIMUM DISCOUNT 25%)	946.00
RA1201C	STEERING ASSEMBLY, HI-FLOW DROOP, 3.187 INSERT (MAXIMUM DISCOUNT 25%)	946.00
RA1201D	STEERING ASSEMBLY, HI-FLOW DROOP, 3.250 INSERT (MAXIMUM DISCOUNT 25%)	946.00
RA1201E	STEERING ASSEMBLY, HI-FLOW DROOP, 3.312 INSERT (MAXIMUM DISCOUNT 25%)	946.00
RA1301A	STEERING ASSEMBLY, LONG STRAIGHT SNOOT, 3.000 INSERT (MAXIMUM DISCOUNT 25%)	961.00
RA1301B	STEERING ASSEMBLY, LONG STRAIGHT SNOOT, 3.125 INSERT (MAXIMUM DISCOUNT 25%)	961.00
RA1301C	STEERING ASSEMBLY, LONG STRAIGHT SNOOT, 3.187 INSERT (MAXIMUM DISCOUNT 25%)	961.00
RA1401A	STEERING ASSEMBLY, STANDARD, 3.000 INSERT (MAXIMUM DISCOUNT 25%)	847.00
RA1401B	STEERING ASSEMBLY, STANDARD, 3.125 INSERT (MAXIMUM DISCOUNT 25%)	847.00
RA1401C	STEERING ASSEMBLY, STANDARD, 3.187 INSERT (MAXIMUM DISCOUNT 25%)	847.00
RA1401D	STEERING ASSEMBLY, STANDARD, 3.250 INSERT (MAXIMUM DISCOUNT 25%)	847.00
RA1401E	STEERING ASSEMBLY, STANDARD, 3.312 INSERT (MAXIMUM DISCOUNT 25%)	847.00
RA1701C	STEERING ASSEMBLY, HTR, 3.187 INSERT (MAXIMUM DISCOUNT 25%)	861.00
RA1701D	STEERING ASSEMBLY, HTR, 3.250 INSERT (MAXIMUM DISCOUNT 25%)	861.00
RA1703	STEERING ASSEMBLY, DOMINATOR, W/RUDDER (MAXIMUM DISCOUNT 25%)	927.00
RA1705	STEERING ASSEMBLY, DROOP SNOOT, DOMINATOR (MAXIMUM DISCOUNT 25%)	858.50
RA1707D	STEERING ASSEMBLY, BERK, 3.25 BORE (AT) (MAXIMUM DISCOUNT 25%)	850.00
RA1707DR	STEERING ASSEMBLY, BERK, 3.25 BORE, W/RUDDER (MAXIMUM DISCOUNT 25%)	939.00
RA1707I	STEERING ASSEMBLY, BERK, 3.70 BORE (SD312) (MAXIMUM DISCOUNT 25%)	852.50
RA231	CABLE SWITCH, 40 SERIES	497.50
RA4701	PIN ASSEMBLY, UP / DOWN, TRIM	60.00
RA8007	STEERING CLEVIS ASSEMBLY (BILLET)	45.00
RA8107A	STEERING ASSEMBLY, MANUAL TRIM, 3.000 INSERT (MAXIMUM DISCOUNT 25%)	1,236.00
RA8107B	STEERING ASSEMBLY, MANUAL TRIM, 3.125 INSERT (MAXIMUM DISCOUNT 25%)	1,236.00
RA8107C	STEERING ASSEMBLY, MANUAL TRIM, 3.187 INSERT (MAXIMUM DISCOUNT 25%)	1,236.00
RA8107D	STEERING ASSEMBLY, MANUAL TRIM, 3.250 INSERT (MAXIMUM DISCOUNT 25%)	1,236.00
RA8107E	STEERING ASSEMBLY, MANUAL TRIM, 3.312 INSERT (MAXIMUM DISCOUNT 25%)	1,236.00
RA8507A	STEERING ASSEMBLY, HYD. TRIM, 3.000 INSERT (MAXIMUM DISCOUNT 25%)	1,236.00
RA8507B	STEERING ASSEMBLY, HYD. TRIM, 3.125 INSERT (MAXIMUM DISCOUNT 25%)	1,236.00
RA8507C	STEERING ASSEMBLY, HYD. TRIM, 3.187 INSERT (MAXIMUM DISCOUNT 25%)	1,236.00
RA8507D	STEERING ASSEMBLY, HYD. TRIM, 3.250 INSERT (MAXIMUM DISCOUNT 25%)	1,236.00
RA8507E	STEERING ASSEMBLY, HYD. TRIM, 3.312 INSERT (MAXIMUM DISCOUNT 25%)	1,236.00
RA8707A	STEERING ASSEMBLY, HYD. TRIM W/RK7301, 3.000 INSERT (MAXIMUM DISCOUNT 25%)	1,567.00
RA8707B	STEERING ASSEMBLY, HYD. TRIM W/RK7301, 3.125 INSERT (MAXIMUM DISCOUNT 25%)	1,567.00
RA8707C	STEERING ASSEMBLY, HYD. TRIM W/RK7301, 3.187 INSERT (MAXIMUM DISCOUNT 25%)	1,567.00
RA8707D	STEERING ASSEMBLY, HYD. TRIM W/RK7301, 3.250 INSERT (MAXIMUM DISCOUNT 25%)	1,567.00
RA8707E	STEERING ASSEMBLY, HYD. TRIM W/RK7301, 3.312 INSERT (MAXIMUM DISCOUNT 25%)	1,567.00
RA9208	FW CABLE ADAPTER KIT, 43BC TO 33C	75.00
RK0595	BERKELEY ALUMINUM RUDDER KIT	223.50
RK2505	RUDDER ASSEMBLY, 4-BOLT (DOM, TRIM)	135.00
RK2601	RUDDER KIT, 3-BOLT	135.00
RK7301	HYDRAULIC CONTROL KIT (MAX 25%)	712.50

# American Turbine 2019 Item Price List

Item	Description	Price
<b>(RS) HTR II STEERING COMONENTS</b>		
RS1001	HTR II, CONTROL ROD BRACKET	88.00
RS1101	HTR II, STEERING NOZZLE (OLD STYLE)	432.50
RS2101	HTR II, REVERSE BUCKET	445.00
RS2131	HTR II, BUSHING (BUCKET PIVOT)	16.00
RS2201	HTR II, BUCKET BRACKET (STARBOARD)	126.00
RS2301	HTR II, PUSH PULL ROD	119.00
RS2401	HTR II, REVERSE LEVER ARM	195.00
RS2501	HTR II, BUCKET BRACKET (PORT)	115.00
RS2621	HTR II, TAPPED SPACER	11.50
RS2623	HTR II, BRONZE BUSHING 3/8X 1/2	9.00
RS2701	HTR II, DETENT SPRING	80.50
RS2801	HTR II, TILLER ARM (OLD STYLE)	147.50
RS2802	HTR II, LOCK BLOCK SPRING	49.00
RS2901	HTR II, LOCK HOUSING	104.50
RS2911	HTR II, TILLER ARM, (NEW STYLE)	105.00
RS3001	HTR II, LOCK PLATE	25.00
RS3101	HTR II, LOCK HUB	68.00
RS3201	HTR II, NYLINER BEARING	5.00
RS3501	HTR II, TAPER LOCK PIN	60.00
RS5001	HTR II, BEZEL (SHIFT ROD / STEERING)	89.00
RS5101	HTR II, BRAKE ROD	69.00
RS5221	HTR II, SHIFT SHAFT	95.00
RS5231	HTR II, SHAFT LOCK COLLAR (TWO PIECE)	31.00
RS5351	HTR II, SPERICAL BEARING	42.00
RS5601	HTR II, SHIFT ROD SEAL	23.00
RS5621	HTR II, SHIFT ROD BALL	29.50
RS5801	HTR II, 64 SERIES CABLE CLAMP	6.50
RS5901	HTR II, 64 SERIES CABLE SHIM	5.00
RS6101	HTR II, CABLE BRACKET, 64C	42.00
RS6201	HTR II, PLASTIC COLLAR (ONE PIECE)	24.00
RS6301	HTR II, BRACKET, SPRAY DEFLECTOR	43.00
RS6401	HTR II, SPRAY DEFLECTOR	182.50
RSA2001C	STEERING ASSEMBLY, HTR II, 3.19 INSERT (MAXIMUM DISCOUNT 25%)	777.00
RSA2001D	STEERING ASSEMBLY, HTR II, 3.25 INSERT (MAXIMUM DISCOUNT 25%)	777.00
RSA2001I	STEERING ASSEMBLY, HTR II, 3.70 INSERT (MAXIMUM DISCOUNT 25%)	777.00
RSA5001	SHIFT ROD BEZEL ASSEMBLY, HTR II	88.00
RSA5101	BRAKE ROD ASSEMBLY, HTR II	337.00
RSA5221	SHIFT SHAFT ASSEMBLY, HTR II	595.00
RSA5301	HTR II, LEVER BOSS & ARM ASSEMBLY	59.00
RSK2101C	HTR II BUCKET KIT, 3.19 INSERT (MAXIMUM DISCOUNT 25%)	1,574.00
RSK2101D	HTR II BUCKET KIT, 3.25 INSERT (MAXIMUM DISCOUNT 25%)	1,574.00
RSK2101I	HTR II BUCKET KIT, 3.70 INSERT (MAXIMUM DISCOUNT 25%)	1,574.00
RSK2501	BUCKET INSTALL KIT, HTR II	176.00
RSK5001	STEERING KIT, HTR II (ROUND BEZEL)	157.00



# American Turbine 2019 Item Price List

Item	Description	Price
<b>(RV) SD-231 STEERING COMPONENTS</b>		
RV1001	REVERSE CABLE BRACKET, SD231	220.00
RV1001A	30 SERIES CABLE CLAMP ADAPTER, SD231	39.50
RV1006	BUSHING CAP, STEERING PIVOT, SD231	43.00
RV1007	HOUSING, NOZZLE, SD231	383.50
RV1107	PIVOT BOLT SHIM .036, SD231	3.50
RV1207	PIVOT BOLT SHIM .010, SD231	5.00
RV1307	SHIM,BUSHING CAP .008	3.50
RV1407	SHIM,BUSHING CAP .005	3.50
RV2001	NOZZLE, SD231	408.50
RV2002	NOZZLE VANE, SD231	28.00
RV2101	REVERSE BUCKET, SD231	687.50
RV2104	REVERSE SPRING TAB, SD231	20.00
RV2105	REVERSE BUCKET SPRING, SD231	59.00
RV2106	SHIFT CONTROL FOLLOWER, SD231	213.00
RV2200	TILLER ARM. SD231, BILLET	206.50
RV2201	STEERING TIE ROD, SD231	67.50
RV3000	STEERING SHAFT ARM (INSIDE), SD231	86.50
RV3001	STEERING STOP, SD231	49.00
RV3002	STEERING SHAFT ARM (OUTSIDE), SD231	28.50
RV3003	STEERING SHAFT, SD231	78.50
RV3004	SNAP RING SS 3/4, STEERING, SD231	7.50
RV3703	5/8-11 X 5/8 SOCKET HEAD CAPSCREW W/ 3/4 PIVOT HEAD TYPE 304	13.50
RV4000	EHA MOUNT, SD231	173.50
RV4001	EHA SHAFT LINK, SD231	119.50
RV4002	SHIFT SHAFT-1, SD231	91.00
RV4003	SHIFT SHAFT-2, SD231	91.00
RV4004	ELECTRIC - HYDRAULIC ACTUATOR	2,187.00
RV4005	EHA MOUNT SHIM	3.50
RV7400	SD231 NOZZLE INSERT, 4.0	124.00
RV7420	SD231 NOZZLE INSERT, 4.2	124.00
RV7430	SD231 NOZZLE INSERT, 4.3	124.00
RV7440	SD231 NOZZLE INSERT, 4.4	124.00
RVA2001	SD231 STEERING ASSEMBLY	1,177.00
<b>(SC) SUCTION COMPONENTS</b>		
SC1001	SUCTION PIECE, AT-309 (10-1/2 BOLT CIRCLE)	1,399.50
SC1001A	SUCTION PIECE, AT-309 (10-1/4 BOLT CIRCLE, 9-1/8"REGISTER)	1,399.50
SC1003	SUCTION PIECE, 12-S (10-1/2 BOLT CIRCLE)	1,399.50
SC1003A	SUCTION PIECE, 12-S (10-1/4 BOLT CIRCLE)	1,399.50
SC1003DR	SUCTION PIECE, 12-S, DRAG RACE (10-1/2 BOLT CIRCLE)	2,713.00
SC1003MR	SUCTION PIECE, 12-S, MARATHON RACE (10-1/2 BOLT CIRCLE)	2,998.00
SC1201	SUCTION PIECE, FW-309	1,428.00
SC1301	SUCTION PIECE, SD-309	1,454.50

## American Turbine 2019 Item Price List

Item	Description	Price
SC1401	SUCTION PIECE, SD-312	1,545.00
SC1403	SUCTION PIECE, 12TD, TJ-309 (10-1/2 BOLT CIRCLE)	1,556.50
SC1412	SUCTION HOUSING, SD231	3,433.00
SC1501	HAND HOLE COVER, AT-309	115.00
SC1601	SUCTION PIECE, SD-312 FIBERGLASS	1,545.00
SC1701	HAND HOLE COVER, SD-309, FW, TJ	99.00
SC1703	HAND HOLE COVER, 12-S	209.00
SC1801	HAND HOLE COVER, SD203, 312	115.00
SC1901	HAND HOLE COVER, SD-231	99.00
SC2001	OIL COOLED MAIN BEARING HOUSING	376.00
SC2002	OIL COOLED RESERVOIR CAP	138.00
SC2003	BEARING CAP, 12TD W/O PACKING, SERIAL # UP TO 17430	232.00
SC2007	BEARING CAP, PRE 1998	209.00
SC2008	WJ BEARING CAP (BILLETT ALUMINUM) RED	249.50
SC2009	JACUZZI YJ, BEARING CAP, BILLET	147.50
SC2101	BEARING HOUSING, SD203, 309, 312	235.00
SC2107	BEARING CAP, HI-PERFORMANCE	230.00
SC2109	BEARING HOUSING, PANTHER ENERGIZER	227.50
SC2209	BEARING CAP, PANTHER ENERGIZER	290.50
SC2507	PACKING FOLLOWER (SET 2)	120.00
SC3007	PACKING RING (5 RINGS PER SET)	70.00
SC4007	ENGINE MOUNT RING (BEARING CAP)	22.50
SC4101	NIPPLE, WATER COOLING TUBE (SD203, 312)	38.00
SC4201	WATER TUBE, (SD312)	62.00
SC4212	BEARING HOUSING, SD231	83.50
SC4302	FLANGE MOUNT WATER TUBE, SD231	95.00
SC4314	WATER TUBE, SD231	87.50
SC4401	WATER TUBE, SD	40.50
SC4501	WATER TUBE, FW	46.50
SC4502	HOSE NIPPLE, ENGINE COOLING, SD231	27.00
SC4507	BARBED CONNECTOR - 3/8 P X 5/8 H	35.50
SC4601	HOSE NIPPLE, ENGINE COOLING (FW)	64.00
SC4603	BULKHEAD WATER CONNECTOR TJ	66.50
SC4607	BARBED CONNECTOR - 3/4 P X 3/4 H	17.00
SC4707	COOLANT CONNECTOR, BALL VALVE, 3/8 NPT (SD309)	21.50
SC4807	BYBASS VALVE, COOLING LINE	130.00
SC4902	DRIVE SCREW TYPE U, #4 X 1/4	2.50
SC5001	HAND HOLE EXTENSION HOUSING	366.00
SC5101	HAND HOLE EXTENSION PLUG	381.50
SC5201	SD-312 LANYARD CHAIN	16.00
SC5301	SD-312 LANYARD RIVET	2.00
SC5401	SD-312 LANYARD ENDS	4.00
SC6008	SUCTION PIECE ADAPTER, YJ ENERGIZER	294.50
SC6009	SUCTION PIECE ADAPTER, PANTHER ENERGIZER	313.00
SC6108	BRASS NIPPLE, (1/4 X 3)	18.00

## American Turbine 2019 Item Price List

Item	Description	Price
SC6109	HOSE BARB 5/8 HOSE X 1/2 PIPE, PANTHER ENGERGIZER KIT	7.50
SC6208	WATER ADPT FITTING 1/4 TO 3/8	7.50
SC6209	COOLING HOSE, PANTHER JET ENGERGIZER KIT (9")	9.00
SC6309	BRASS HEX PLUG 1/2 NPT, PANTHER JET ENGERGIZER KIT	9.00
SC8701	GREASE ZERK, 1/8" DRIVE-IN	5.00
SC8801	1/8" 45 DEG. GREASE FITTING	10.50
SC8901	STAINLESS GREASE ZERK, STRAIGHT	8.50
SC8902	STAINLESS GREASE ZERK, 90 DEGREE	19.50
SC9000	PRIME-A-JET	75.00
SC9002	BERKELEY BOWL SEAL RETAINER (NO DISCOUNT)	53.50
SC9201	BOWL, SNAP RING	16.00
SC9202	RETAINING RING, SEAL RETAINER, SD231	11.00
SC9203	SNAP RING, SEALED BRG ASSEMBLY	6.00
SC9412	STATOR, SD231	877.50
SC9701	BOWL ADAPTER RING (1/8)	29.50
SC9706	BOWL ADAPTER RING (3/16)	29.50
SC9902	PIPE PLUG, OIL RESERVOIR	4.00
SC9903	3/8 PIPE PLUG	5.50
SC9904	1/8 BREATHER VENT	28.50
SCA4901	HAND HOLE EXTENSION ASSEMBLY	620.00
SCA9001	BOWL PLUG W / ZERT & O-RING	43.00
SCA9003	BOWL PLUG ASSEMBLY, HIPPED BOWL	52.00
SCA9101	BOWL ASSEMBLY, AT 10-1/4 (No longer in production substitute SCA9103)	1,149.00
SCA9102	BOWL ASSEMBLY, BERK 10-1/4 (DO NOT EXCEED 450 HP)	1,095.00
SCA9103	BOWL ASSEMBLY, DOM 10-1/4	1,095.00
SCA9103E	BOWL, DOM 10-1/4 (ADD \$519.00 FOR EXTRUDED)	1,095.00
SCA9108	BOWL ASSEMBLY, YJ ENGERGIZER	1,095.00
SCA9208	BOWL ASSEMBLY, WJ ENGERGIZER	1,095.00
SCA9301	BOWL ASSEMBLY, AT STANDARD	1,095.00
SCA9301A	BOWL ASSEMBLY, 10-1/2 B.C., A356 T6 ALUMINUM, RACE BOWL	1,095.00
SCA9301E	BOWL, AT STANDARD (ADD \$567.00 FOR EXTRUDED)	1,095.00
SCA9301H	BOWL, AT STANDARD, HIP PROCESS (ADD \$399.00 AFTER DISCOUNT)	1,095.00
SCA9312	STATOR ASSEMBLY, SD-203	1,130.00
SCA9401	BOWL ASSEMBLY, SD-312	1,130.00
<b>(SH) PUMP SHAFT COMPONENTS</b>		
SH1008	PUMP SHAFT, YJ ENGERGIZER	799.00
SH1107	PUMP SHAFT, 17-4PH, HI-PERF (STANDARD)	799.00
SH1108	PUMP SHAFT, WJ ENGERGIZER	756.50
SH1207	PUMP SHAFT, SD & FW (17-4PH)	791.00
SH1412	PUMP SHAFT, SD231	823.00
SH1507	SNAP RING, SHAFT	5.00
SH1608	SNAP RING, MECHANICAL SEAL	10.50
SH1609	RETAINING RING, PUMP SHAFT, SD231	11.00
SH2005	THRUST WASHER	11.50

## American Turbine 2019 Item Price List

Item	Description	Price
SH2108	BACK-UP PLATE, LIP SEAL WJ ENERGIZER	76.00
SH2208	YJ SEAL PAC	103.00
SH2303	SEAL PACK HOUSING, DOMINATOR 12TD	103.00
SH2308	SEAL PACK,YJ GOLDEN EAGLE	103.00
SH2403	SLINGER RING, EARLY DOM	79.00
SH2507	SLINGER RING	74.00
SH2607	SLINGER RING, DOMINATOR MR	74.00
SH3007	IMPELLER KEY	9.50
SH3017	SHAFT KEY, SD231	9.50
SH3107	INDUCER SPACER	63.00
SH3207	INDUCER KEY	17.00
SH3507	IMPELLER NUT	29.00
SH4007	IMPELLER SHIM .005	6.00
SH4107	IMPELLER SHIM .010	6.00
SH4207	IMPELLER SHIM .020	6.00
SH4307	IMPELLER SHIM .040	6.00
SH4407	IMPELLER SHIM .060	6.00
SH4507	IMPELLER SHIM .075	6.00
SH5000	BEARING SLEEVE, SD231	94.00
SH5001	BEARING SLEEVE, SD203, 309, 312	115.00
SH5002	BEARING PRELOAD/ SEAL RING (BERK)	85.00
SH5005	BEARING PRELOAD/ SEAL RING	100.00
SH5009	SHAFT SLEEVE, SD231	121.00
SH5010	SHAFT SLEEVE WASHER, SD231	39.50
SH5101	NUT, BEARING SLEEVE, SD203, 309, 312	45.00
SH5201	SEAL FACE HOUSING, SD203, 309, 312	149.00
SH5301	HP BEARING SLEEVE NUT	143.50
SH5401RK	TAIL BEARING REPAIR SLEEVE, HARD CHROME	156.00
SH5412	SEAL FACE HOUSING, SD231	241.00
SH5501RK	RETAINING WASHER, TAIL BEARING REPAIR SLEEVE	45.00
SH6412	DRIVE FLANGE, SD231	241.50
SH6413	5/8 MACHINED THICK WASHER	19.00
SH7301	SEAL / CLAMP RING, DOMINATOR MR	143.50
SHA1103	PUMP SHAFT ASSEMBLY, W / B1007 & EARLY SLINGER RING	860.50
SHA1107	PUMP SHAFT ASSEMBLY, W / B1007	860.50
SHA1201	PUMP SHAFT ASSEMBLY, SD	969.00
SHA1208	PUMP SHAFT ASSEMBLY, YJ ENERGIZER	1,138.50
SHA1307	PUMP SHAFT ASSEMBLY, HP BEARING	929.00
SHA1412	SD231 SHAFT ASSEMBLY	1,400.50
SHK4007	SHIM KIT	14.00
<b>(SL) SEALS</b>		
SL1001	SEAL, BEARING CAP, HI-PERF (AT, DOM, BERK)	18.00
SL1003	SEAL, (SEALED BRG. ASSY)	19.00
SL1007	SEAL, BEARING CAP (AT, BERK, DOM, SD231)	18.00

## American Turbine 2019 Item Price List

Item	Description	Price
SL1101	SEAL, BEARING HOUSING SD203, 309, 312	18.00
SL1107	SEAL, BEARING CAP (BERK JB, WJ)	37.00
SL1201	SEAL, SEAL FACE HOUSING	25.00
SL1507	SEAL, SUCTION (AT, BERK, LATE DOM), STATOR, SD231	18.00
SL1603	SEAL, SUCTION (DOM EARLY)	18.00
SL1609	SEAL, PANTHER JET SUCTION	32.50
SL2003	SEAL, BOWL (AT, BERK, LATE DOM)	14.50
SL3508	SEAL, YJ ENERGIZER, 12TD SEAL PAC	31.50
SL3608	SEAL, WJ BEARING HOUSING (OEM)	42.00
SL3708	SEAL, WJ BEARING HOUSING, YJ ENERGIZER, 12TD SEAL PAC	31.50
SL4008	SEAL, MECHANICAL (SD, YJ & 212 HAMILTON)	77.50
SL9412	SEAL SAVER, STATOR BEARING CARTRIDGE SD231	13.50
<b>(SR) SDR STEERING PARTS</b>		
SR1007	NOZZLE HOUSING, SDR (SD203)	425.00
SR1009	SDR, NOZZLE (AXIAL FLOW)	425.00
SR2001	SDR, MV CONTROL SHIFT LEVER	29.50
SR2005	SDR, SHIFT CABLE BRACKET	75.00
SR2009	SDR REVERSE CABLE BRACKET, AXIAL FLOW	35.00
SR2019P	REVERSE PIVOT BRACKET, SDR AXIAL FLOW, PORT	50.00
SR2019S	REVERSE PIVOT BRACKET, SDR AXIAL FLOW, STARBOARD	61.50
SR2101	SDR, REVERSE BUCKET	682.00
SR2201	SPRING, REVERSE BUCKET	28.50
SR2301	S-HOOK FOR SDR SPRING	3.00
SR3001	SDR, TILLER ARM	57.50
SR3009	TILLER ARM, SDR AXIAL FLOW	37.00
SR4001L	SDR BUCKET PIVOT BRACKET (LEFT SIDE)	90.00
SR4001R	SDR BUCKET PIVOT BRACKET (RIGHT SIDE)	90.00
SR5101	BUCKET STOP, SDR REVERSE BUCKET	20.00
SR6001	SDR, OFF-SET STEERING EXTENSION	146.50
SR6101	SDR OFF-SET STEERING EXTENSION, SS TUBING	98.00
SR7400	SD203, NOZZLE INSERT 4.000"	126.00
SR7420	SD203, NOZZLE INSERT 4.200"	126.00
SR7430	SD203, NOZZLE INSERT 4.300"	126.00
SR7440	SD203, NOZZLE INSERT 4.400"	126.00
SRK203 280 SDR	SD203 AXIAL FLOW JET UPGRADE, 2.8KW IMP, SDR	3,107.50
SRK203 310 SDR	SD203 AXIAL FLOW JET UPGRADE, 3.1 KW IMP, SDR	3,107.50
SRK2101C	SDR BUCKET KIT, 3.19 INSERT	1,225.00
SRK2101D	SDR BUCKET KIT, 3.25 INSERT	1,225.00
SRK2101I	SDR BUCKET KIT, 3.70 INSERT	1,225.00
SRK2401C	SDR BUCKET KIT, AT-309, DOM, 3.19 INSERT	1,475.00
SRK2401D	SDR BUCKET KIT, AT-309, DOM, 3.25 INSERT	1,475.00
SRK312 24S SDR	SD312 CONVERSION KIT, STAINLESS 2.9KW IMP, SDR	3,513.00
<b>(T) TRANSOM COMPONENTS</b>		

## American Turbine 2019 Item Price List

Item	Description	Price
T1001	TRANSON HOUSING, DEEP	715.50
T1105	TRANSOM HOUSING, 9/18	583.50
T1412	TRANSOM PLATE, SD231	419.00
T1412-4	SET BACK PLATE, SD231	281.00
T1412-4-2	TRANSOM PLATE BRACKET	55.50
T1412-4-R	GASKET, SET BACK PLATE, SD231	86.00
T1601	TRANSOM RING, DEEP TA	157.00
T2007	REV. CABLE PACKER, ALUM 1/2 NPT	28.50
T2101	REV. CABLE PACKER, PLASTIC 3/4 NPT STD	17.00
T2201	REV. CABLE PACKER, FW 1/2 NPT	21.50
T2301	REV. CABLE PACKER, HYDRAULIC LINE	18.00
T2401	REV. CABLE PACKER, LOCKING NUT, 3/4 NPT	5.00
T2412	TRANSOM PLATE TRIM SEAL, SD231	39.50
T2601	STEERING TUBE BALL	40.00
T2701	BALL FLANGE	50.00
T3007	STEERING TUBE	70.00
T3501	DRAIN PLUG, BRASS 3/8 NPT	6.50
T3601	PLASTIC PLUG, 3/4 NPT	6.50
T5001	TRANSOM CONTROL BEZEL	96.00
TA2101	REV. CABLE PACKER, PLASTIC 3/4 NPT STD (W / O3001 O-RING)	21.50
TA3107	STEERING TUBE SEAL (W / ZERT & O-RING)	45.00
TA5001	TRANSOM CONTROL BEZEL ASSEMBLY	112.00
TK0310	UNIVERSAL TRANSOM FLANGE ASSEMBLY	590.00
TK1001	TRANSOM HOUSING KIT, DEEP	1,019.00
TK1105	TRANSOM HOUSING KIT, 9/18	589.00
TK2407	DETMAR KIT, BILLET ALUMINUM, (LESS EXT. & CLEVIS ASSY.) (MAX. 25% DISCOUNT)	110.00
TK2507	DETMAR KIT, BILLET ALUMINUM (LESS EXT. AT) (MAX. 25% DISCOUNT)	140.00
TK2607	SDR INSTALL KIT, DETMAR STYLE, BILLET ALUMINUM (MAX. 25% DISCOUNT)	125.00
TK2707	SDR INSTALL KIT, W / T5001 TEAR DROP TRANSOM BEZEL (MAX. 25% DISCOUNT)	150.00
TK2807	SDR INSTALL KIT, W / RS5001 ROUND TRANSOM BEZEL (MAX. 25% DISCOUNT)	150.00
TK5001	STEERING KIT, SD & SET BACK PUMP (MAX. 25% DISCOUNT)	198.00
TK5002	STEERING KIT, SD & SET BACK PUMP W / RS5001 ROUND TRANSOM BEZEL (MAX. 25%)	190.00
<b>(WR) WEAR RINGS &amp; LINERS</b>		
WR203SS	WEAR RING, SD203AF, STAINLESS STEEL	480.00
WR203ST	SD203AF TAPERED WEAR PLATE	628.00
WR309	WEAR RING AXIAL FLOW 309	674.00
WR412	WEAR RING, SD231	1,184.00
WR5000	WEAR RING, SIZE STANDARD (AT, BK, DL)	288.00
WR5000FF	STANDARD WEAR RING, FILE FIT	330.00
WR5000OE	WEAR RING, SIZE STANDARD (DLOE)	330.00
WR5000SN	WEAR RING, STAINLESS NON-SHOULDERED, SIZE STANDARD	196.00
WR5000SS	WEAR RING, STAINLESS SHOULDERED, SIZE STANDARD	220.00
WR5005FF	WEAR RING, SIZE -.005, FILE FIT (AT, BK, DL)	330.00
WR5015	WEAR RING, SIZE -.015 (AT, BK, DL)	288.00

# American Turbine 2019 Item Price List

Item	Description	Price
WR5015OE	WEAR RING, SIZE -.015 (DLOE)	288.00
WR5025	WEAR RING, SIZE -.025 (AT, BK, DL)	288.00
WR5025OE	WEAR RING, SIZE -.025 (DLOE)	288.00
WR5050OE	WEAR RING, SIZE -.050 (DLOE)	288.00
WR5055	WEAR RING, SIZE -.055 (AT, BK, DL)	288.00
WR5100	WEAR RING, SIZE STANDARD, SD-312	439.00
WR5800	WEAR RING, SIZE STANDARD (YJ, DE)	288.00
WR5815	WEAR RING, SIZE -.015 (YJ, DE)	288.00
WR5815OE	WEAR RING, SIZE -.015 (DEOE)	288.00
WR5825	WEAR RING, SIZE -.025 (YJ, DE)	288.00
WR5825OE	WEAR RING, SIZE -.025 (DEOE)	288.00
WR5850	WEAR RING, SIZE -.050 (YJ, DE)	288.00
WR5850OE	WEAR RING, SIZE -.050 (DEOE)	288.00
WR5900	WEAR RING, SIZE STANDARD (WJ)	355.00
WR6004	WEAR RING INSULATOR (STANDARD)	12.00
WR6005	WEAR RING INSULATOR (SD203, 312)	12.00
WR6009	WEAR RING INSULATOR, WJ ENERGIZER	12.00